

Sight Glass for Sanitary Clamp Fitting type 89

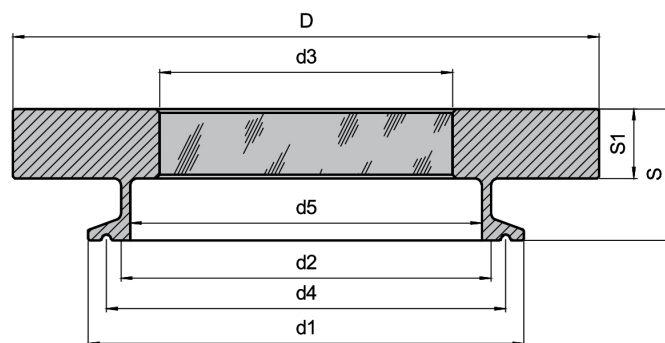

Applications:

- For clamp fittings to DIN32 676 / ISO 2852

Advantages:

- Extremely compact construction
- Suitable for food processing & other sterile applications
- Reliability against total failure – the possibility of sudden unexpected rupture is totally excluded
- Fast & simple installation & maintenance
- Extreme resistance to impact and temperature
- Wide acceptance in the European & American food, beverage, pharmaceutical and chemical industries
- Large view

Operating conditions:

- Pressure: -1 to 16 bar
- Temperature: see table

Technical data:

Manufactured and tested in conformance with:

- Pressure Equipment Directive 2014/68/EU, Module H (DIN/EN/ISO 9001)
- AD 2000 Standards W0/TRD 100
- Sight glass fused to metal conforming to DIN 7079

Materiálové atesty:

- Atest dle EN 10204-3.1 nebo 3.2 za příplatek

Materiál:

- Glass: Borosilicate to DIN 7080 / DIN 7079

Ring materials	Operating temperature
1.4462	-30 °C to +280 °C
2.4610	-60 °C to +300 °C

Nominal size	d1	d2	d3	d4	d5	S	S1	D	Max. operating pressure [bar]	
DN 25/32/40	Zoll 1", 1½"	50,5	38	33	43,5	34,8	22	10	65	16
50	2"	64	51	45	56,5	47,5	24	12	85	16
65	3"	91	76	65	83,5	72	34	19	125	16
100	4"	119	101	83	110,0	97,4	36	19	160	16
-	5"	144,5	127	95	134,5	123	36	18	180	10
-	6"	167	153	110	156,5	146,8	36	19	210	10
-	8"	217,5	202	140	207,4	198	40	20	280	10