

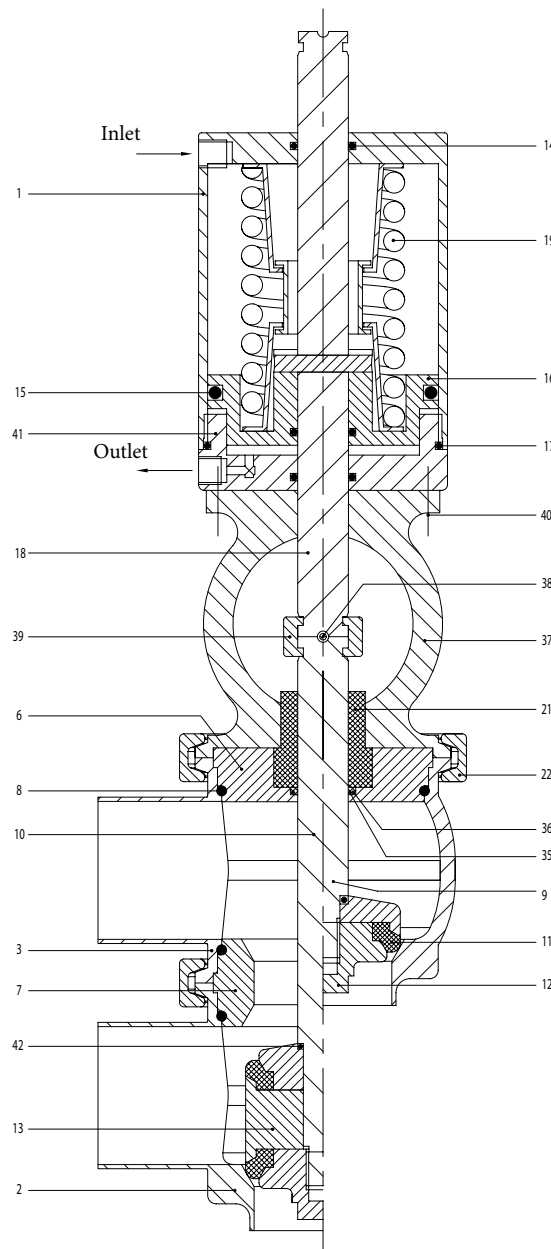

- Produced in strict conformity with criteria and tests required by 3-A standards.
- Parts in contact with the fluid made exclusively of AISI 316L stainless steel.
- Full self-drainage of valve due to spherical internal shape and polishing of internal parts.
- Seal members easy to access during CIP process.
- Easy maintenance due to assembly of valve using 3-piece clamp.
- Air entry into the upper head of the valve and distribution in the lower part by an internal piston.
- Absolute safety during assembly and disassembly, ensured by a special device to keep the springs under constant compression.
- Special bushing to ensure perfect coaxiality of cylinder and valve body, to facilitate moving parts, full product sealing and total hygiene during CIP process thanks also to the OR seal ring in terminal part.
- Easy to sterilize.

- Standard production: Clamp or welded ends. Available on request with threaded ends to DIN, and SMS standards.
- Standard finish: 150 grain external polishing and internal glazing (LS finish);
- Finish on request: 240 grain external and internal polishing (LL finish);  
400 grain electrolytic polishing (LE finish).
- Maximum operating pressure: 5 bars.

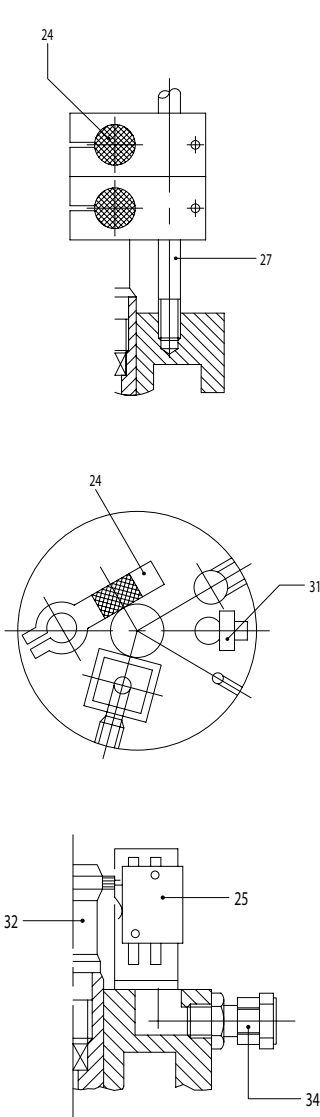

1. Cylindre
2. Valve body
3. Middle body
6. Top head
7. Bottom head
8. OR seal ring
9. Shutter 2-way pn. valve
10. Shutter 3-way pn. valve
11. Lip gasket
12. Locking collar
13. Spacer
14. OR seal ring
15. OR seal ring
16. Piston
17. OR seal ring
18. Shaft
19. Spring
21. PTFE bush
22. CLAMP
24. Proximity contact
25. Microswitch
27. Tie rod
31. Terminal strip
32. Microswitch pin
34. Cable grommet
35. PTFE washer
36. OR seal ring
37. Lantern
38. Screw
39. Joining ring
40. Screw
41. Balnk
42. OR seal ring



Pos.	Code	1" 25	DN 25 28	DN 32 34	1 1/2" 38	DN 40 40	2" 51	DN 50 52	2 1/2" 63	DN 65 70	3" 76	DN 80 85	Material
1	900	25/40	25/40	25/40	25/40	25/40	51/52	51/52	63/70	63/70	76/85	76/85	4L
2	900	25	28	34	38	40	51	52	63	70	76	85	6L
3	900	25	28	34	38	40	51	52	63	70	76	85	6L
6	900	25/40	25/40	25/40	25/40	25/40	51/52	51/52	63/70	63/70	76/85	76/85	6L
7	900	25/40	25/40	25/40	25/40	25/40	51/52	51/52	63	70	76	85	6L
8	OR	149	149	149	149	149	168	168	4300	4300	6337	6337	N
9	9T2	25	28	34	38	40	51/52	51/52	63	70	76	85	6L
10	9T4	25	28	34	38	40	51/52	51/52	63	70	76	85	6L
11	900	25/28	25/28	34/40	34/40	34/40	51/52	51/52	63	70	76	85	T
12	900	25/28	25/28	34/40	34/40	34/40	51/52	51/52	63	70	76	85	6L
13	900	25	28	34	38	40	51/52	51/52	63	70	76	85	6L
14	OR	123	123	123	123	123	123	123	123	123	123	123	N
15	OR	6237	6237	6237	6237	6237	6275	6275	185	185	6387	6387	N
16	900	25/40	25/40	25/40	25/40	25/40	51/52	51/52	63/70	63/70	76/85	76/85	AL
17	OR	3268	3268	3268	3268	3268	3300	3300	3375	3375	3400	3400	N
18	900	25/40	25/40	25/40	25/40	25/40	51/52	51/52	63/70	63/70	76/85	76/85	4CR
19	900	25/40	25/40	25/40	25/40	25/40	51/52	51/52	63/70	63/70	76/85	76/85	AC
21	900	25/85	25/85	25/85	25/85	25/85	25/85	25/85	25/85	25/85	25/85	25/85	T
22	K13	51	51	51	51	51	76	76	89	89	101	101	4L
24	013	S	S	S	S	S	S	S	S	S	S	S	
25	014	1	1	1	1	1	1	1	1	1	1	1	
27	900	25/101	25/101	25/101	25/101	25/101	25/101	25/101	25/101	25/101	25/101	25/101	4L
31	900	25/101	25/101	25/101	25/101	25/101	25/101	25/101	25/101	25/101	25/101	25/101	4
32	900	25/101	25/101	25/101	25/101	25/101	25/101	25/101	25/101	25/101	25/101	25/101	4
34	010 1	PG7	PG7	PG7	PG7	PG7	PG7	PG7	PG7	PG7	PG7	PG7	
35	900	25/85	25/85	25/85	25/85	25/85	25/85	25/85	25/85	25/85	25/85	25/85	T
36	OR	3075	3075	3075	3075	3075	3075	3075	3075	3075	3075	3075	N
37	900	25/40	25/40	25/40	25/40	25/40	51/52	51/52	63/70	63/70	76/85	76/85	4L
38	TSVCE	4 x 28	4 x 28	4 x 28	4 x 28	4 x 28	4 x 28	4 x 28	4 x 28	4 x 28	4 x 28	4 x 28	4L
39	900	25/85	25/85	25/85	25/85	25/85	25/85	25/85	25/85	25/85	25/85	25/85	4L
40	TE	6 x 16	6 x 16	6 x 16	6 x 16	6 x 16	6 x 16	6 x 16	6 x 16	6 x 16	6 x 16	6 x 16	4L
41	900	25/40	25/40	25/40	25/40	25/40	51/52	51/52	63/70	63/70	76/85	76/85	4L
42	OR	2043	2043	2043	2043	2043	2043	2043	2043	2043	2043	2043	N



- Heavy duty construction and easy, fast access for cleaning operations.
- Parts in contact with the fluid made exclusively of AISI 316L stainless steel.
- Manual controls with fast-pitch screw with safe unscrewing.
- Standard finish: 120 grain external polishing and internal glazing.
- Maximum operating pressure: 4 bars.

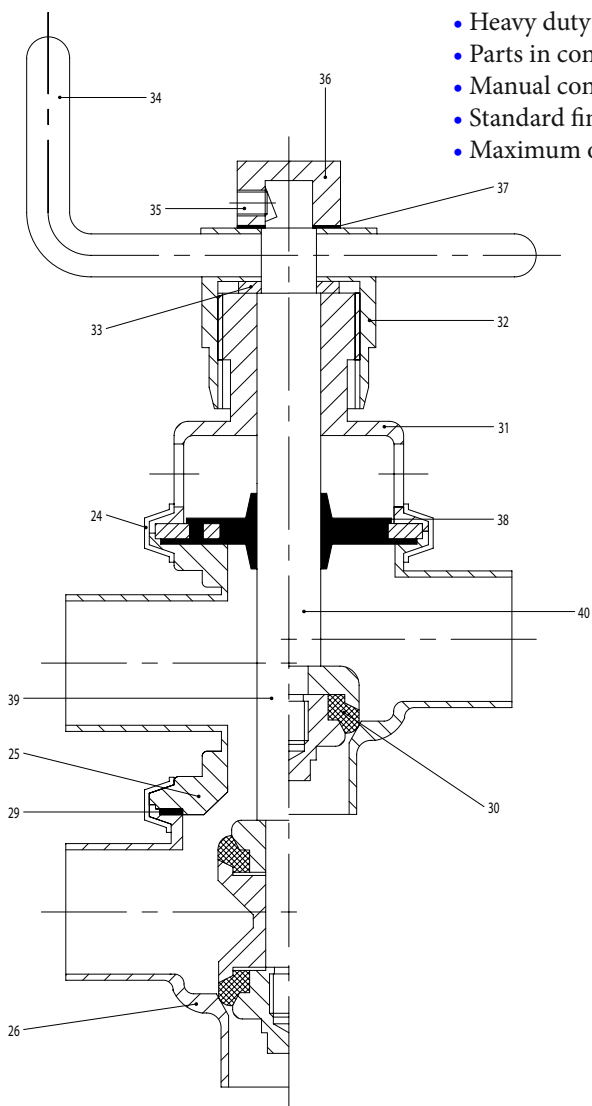

- 24. Collar
- 25. Middle body
- 26. Lower body
- 29. Seal
- 30. Lip gasket
- 31. Manual valve body
- 32. External operating body
- 33. Washer
- 34. Handle
- 35. Dowel
- 36. Plug
- 37. Washer
- 38. Two-lip gasket
- 39. Piston 3-way pn. valve
- 40. Piston 2-way pn. valve

Pos.	Code	1" 25	D25 28	D32 34	1 1/2" 38	D40 40	2" 51	D50 52	2 1/2" 63	D65 70	3" 76	D80 85	4" 101	D100 101	Material
24	800	25/40	25/40	25/40	25/40	25/40	51/52	51/52	63/85	63/85	63/85	63/85	101	101	4L
25	800	25	28	34	38	40	51	52	63	70	76	85	101	101	4L
26	800	25	28	34	38	40	51	52	63	70	76	85	101	101	4L
29	800	25/40	25/40	25/40	25/40	25/40	51/52	51/52	63/85	63/85	63/85	63/85	101	101	N
30	800	25/28	25/28	34	38/40	38/40	51/52	51/52	63	70	76	85	101	101	E/S/T/V
31	850	25/40	25/40	25/40	25/40	25/40	51/52	51/52	63/85	63/85	63/85	63/85	101	101	4L
32	850	25/40	25/40	25/40	25/40	25/40	51/52	51/52	63/85	63/85	63/85	63/85	101	101	4L
33	850	25/101	25/101	25/101	25/101	25/101	25/101	25/101	25/101	25/101	25/101	25/101	25/101	25/101	AC
34	SE	25/40	25/40	25/40	25/40	25/40	51/52	51/52	63/85	63/85	63/85	63/85	101	101	4L
35	GRA	8x10	8x10	8x10	8x10	8x10	8x10	8x10	8x10	8x10	8x10	8x10	8x10	8x10	BA
36	850	25/101	25/101	25/101	25/101	25/101	25/101	25/101	25/101	25/101	25/101	25/101	25/101	25/101	4
37	850	25/101	25/101	25/101	25/101	25/101	25/101	25/101	25/101	25/101	25/101	25/101	25/101	25/101	4
38	8G1	25/40	25/40	25/40	25/40	25/40	51/52	51/52	63/85	63/85	63/85	63/85	101	101	E/S
39	850	25	28	34	38	40	51	52	63	70	76	85	101	101	4L
40	850	25	28	34	38	40	51	52	63	70	76	85	101	101	4L



## Gaskets, shutters and electrical parts:

Two-lip gasket

8G1

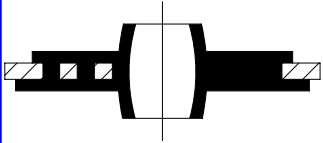

Metallic gasket with OR

8G2

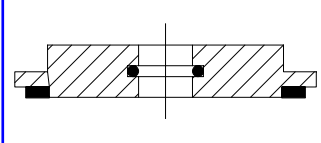

Metallic gasket for steam sterilization

8G3

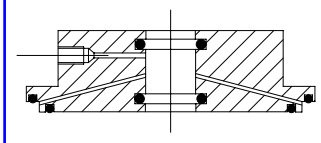

Metallic gasket with wear compensation

8G4

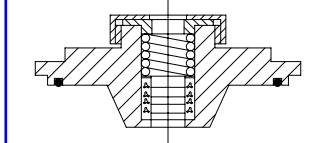

Shutter  
2-way pneumatic valve

8T2

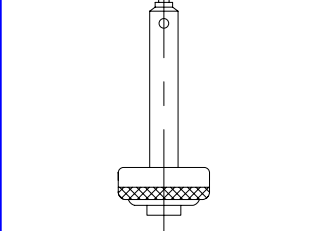

Shutter  
3-way pneumatic valve

8T4

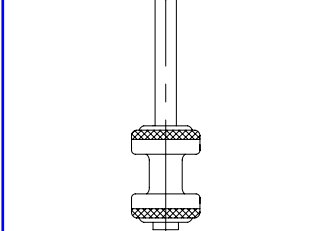

Shutter with bellows gasket

8G5

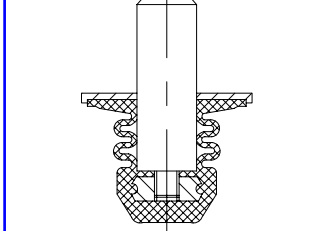

Shutter  
3-A pneumatic valve 2-way

9T2

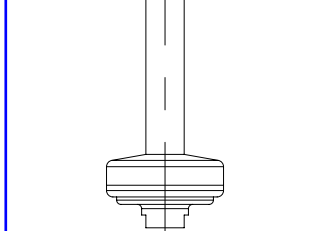

Shutter  
3-A pneumatic valve 3-way

9T4

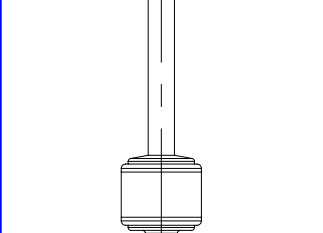

Solenoid valve NA

015NA

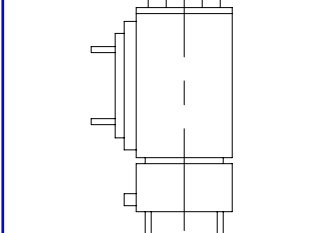

Solenoid valve NC

015NC

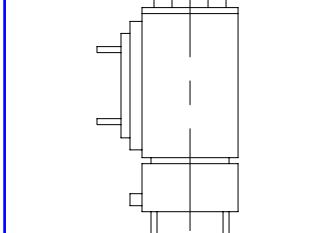

Proximity contact

013A  
013A/N  
013A/N/EX

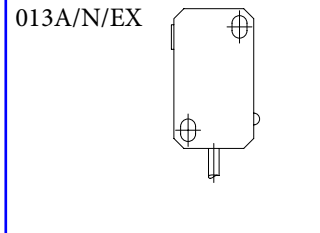

Proximity contact

013S

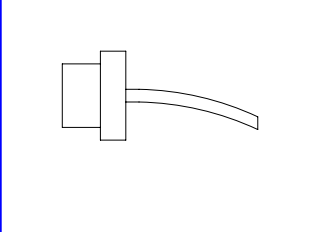

Microswitch

0141

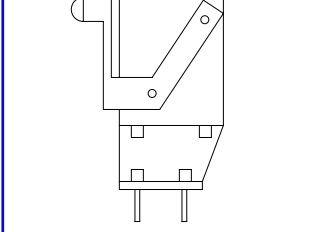

Pneumatic microswitch

0142

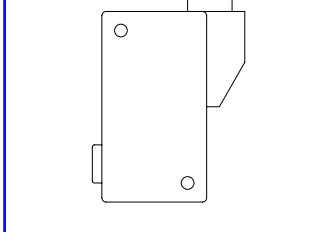

Connector

030H 030S

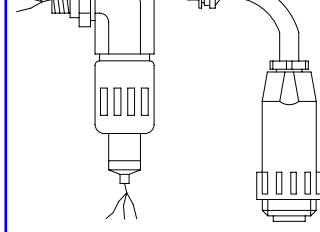



## Body combinations:

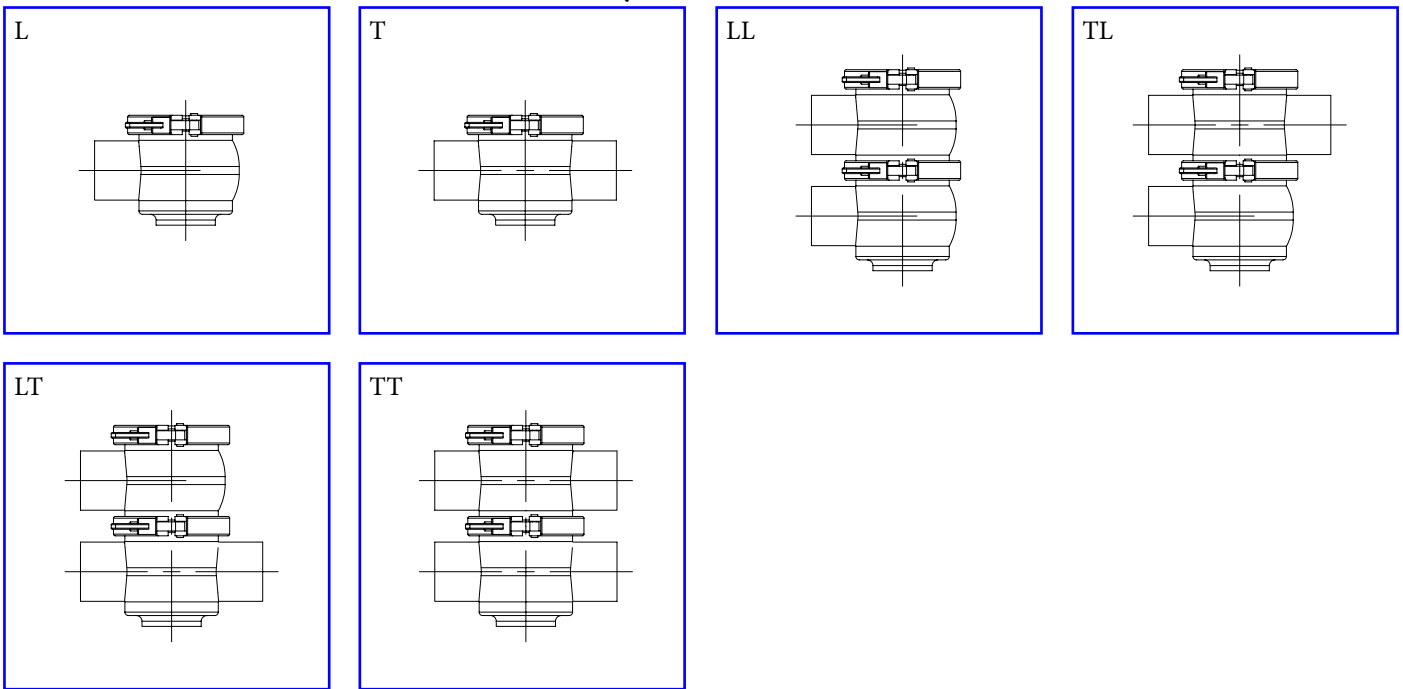

## Flowcharts:

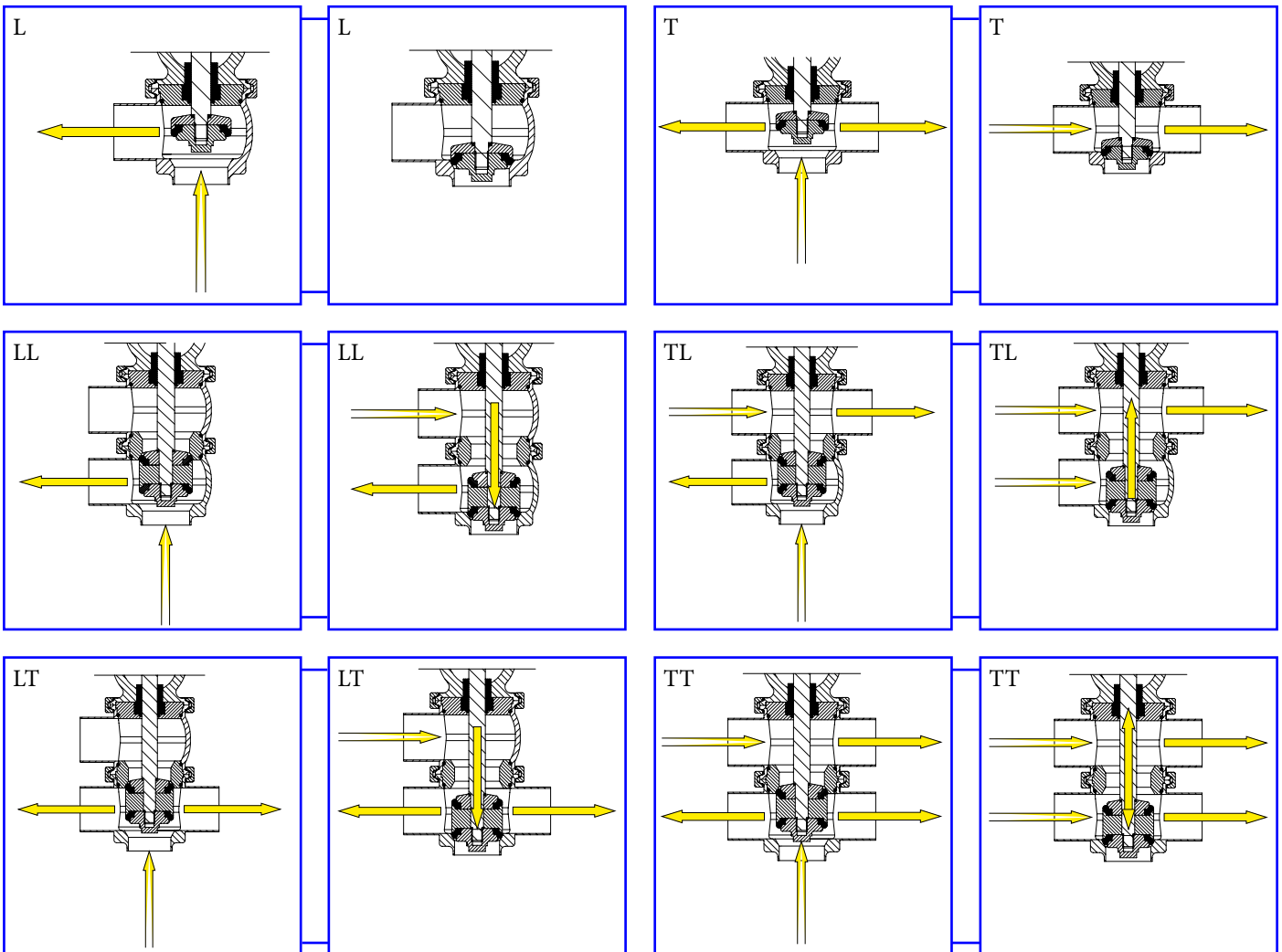



## Pressure drop:

### Pneumatic valve 2-way L:

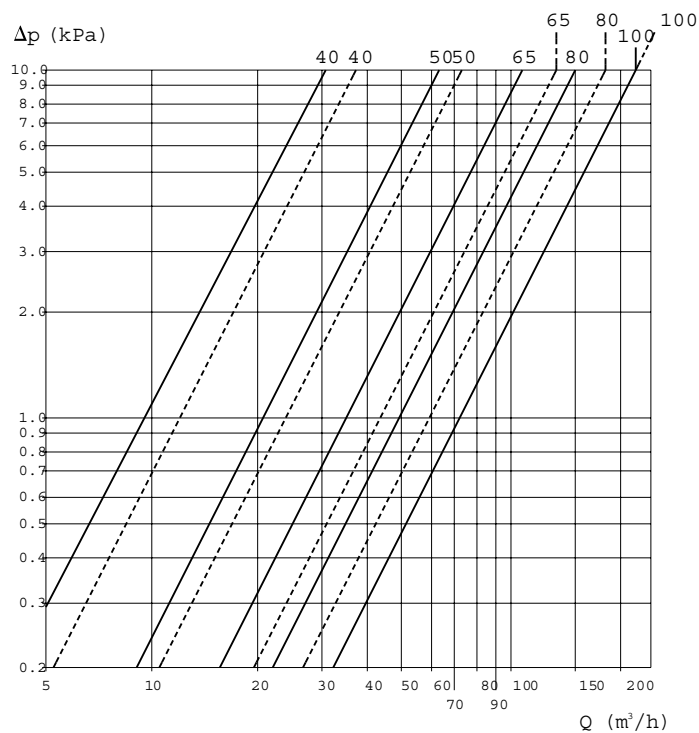

### Pneumatic valve 3-way LL:

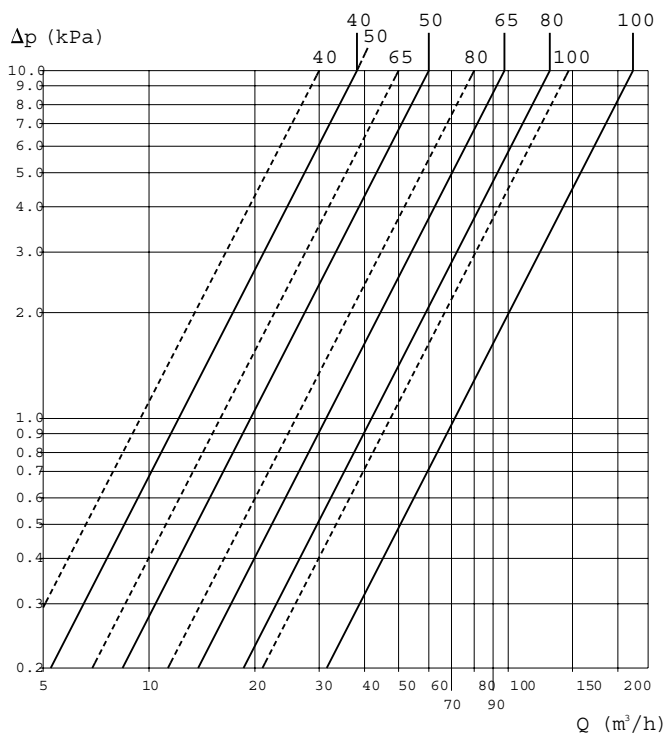



- Parts in contact with the fluid made exclusively of AISI 316L stainless steel.
- Air entry into the upper head of the valve and distribution in the lower part by an internal piston.
- Absolute safety during assembly and disassembly, ensured by a special device to keep the springs under constant compression.
- No chance of contact between the product and the CIP washing liquid.
- Sanitary design ensuring complete self-drainage of all internal parts during CIP washing phases.
- Balanced closing plugs to prevent ram effect during processing steps.
- Perfect seal during CIP washing, ensured by special gaskets.
- Standard finish: 120 grain external polishing and internal glazing. Other finishes on request.
- Maximum operating pressure: 5 bars.

1 Cylinder	8 Closing plug	15 Spring	22 OR seal ring	29 OR seal ring	36 Tie rod	47 OR seal ring
2 Valve body	9 Closing and drain plug	16 Partial travel spring	23 OR seal ring	30 Air coupling	37 Cap nut	48 OR seal ring
3 Piston	10 Piston rod	17 Head	24 OR seal ring	31 OR seal ring	39 Solenoid valve	49 OR seal ring
4 Cover	11 Head seal	18 Middle head	25 OR seal ring	32 OR seal ring	42 OR seal ring	50 OR seal ring
5 Control unit cover	12 Drainage piston	19 Guard body	26 OR seal ring	33 Nut	43 OR seal ring	51 Screw
6 Lantern	13 Snap ring	20 PTFE bush	27 OR seal ring	34 Cap	45 Washer	
7 Coupling member	14 Spring holder	21 CLAMP	28 OR seal ring	35 Proximity contact pin	46 Upper piston	

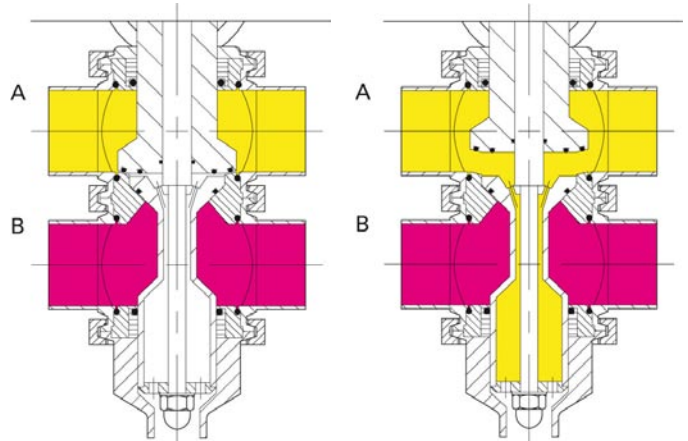
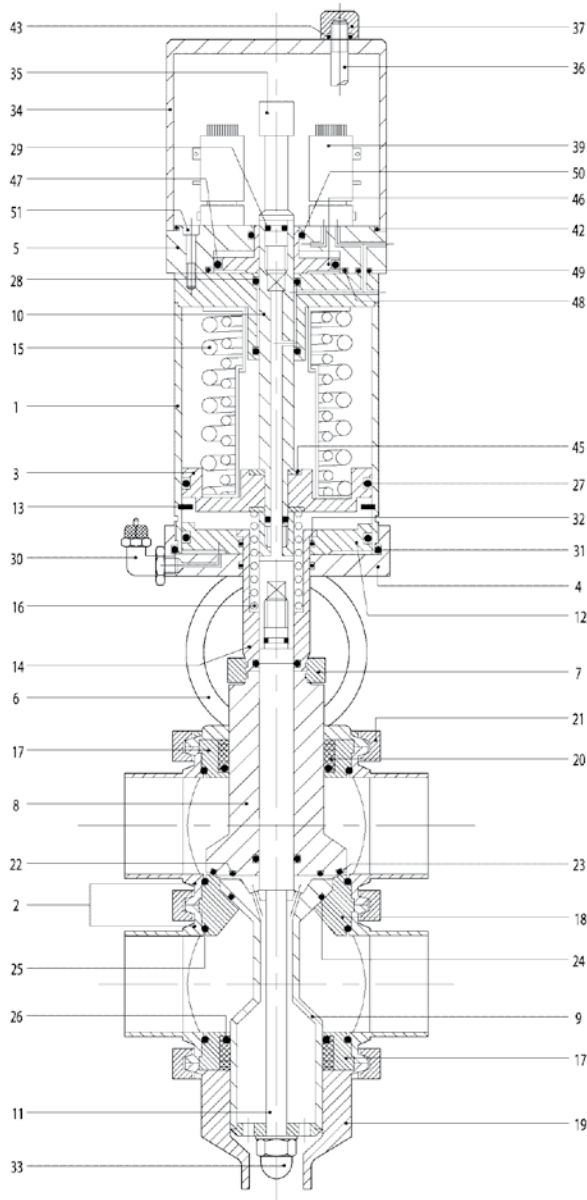

Working position.

The washing product (A) cannot mix with the fluid (B). Any leaks run out of the valve with no chance of contact between the product and the CIP liquid.

Working and simultaneous washing position for the upper closing plug gasket. Any leaks run out of the valve with no chance of contact between the product and the CIP liquid.

Complete washing position

Complete working position

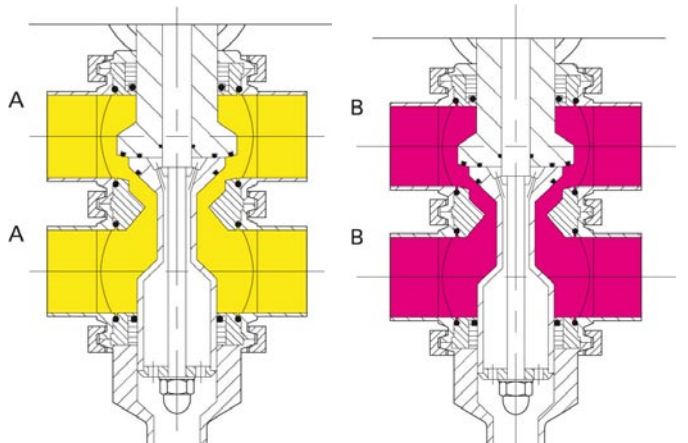





Pos.	Code	2" 51	2 1/2" 63	3" 76	Material
1	830	51	63/76	63/76	4L
2	836	51	63	76	6L
3	830	51	63/76	63/76	AC
4	830	51	63/76	63/76	4L
5	830	51	63/76	63/76	4L
6	830	51	63/76	63/76	4L
7	830	51	63/76	63/76	4L
8	830	51	63	76	6L
9	830	51	63	76	6L
10	830	51	63/76	63/76	6L
11	830	51	63	76	6L
12	830	51	63/76	63/76	AC
13	SEE	J 100	J 108	J 108	AC
14	830	51	63/76	63/76	4L
15	830	51	63/76	63/76	4L
16	830	51	63/76	63/76	4L
17	830	51	63/76	63/76	6L
18	830	51	63/76	63/76	6L
19	830	51	63/76	63/76	4L
20	830	51	63/76	63/76	T
21	K13	76	101	101	4L
22	OR	4143	159	159	N
23	OR	6200	6275	6275	N
24	OR	147	6237	6237	N
25	OR	168	6337	6337	N
26	OR	6187	6212	6212	N
27	OR	185	6387	6387	N
28	OR	123	123	123	N
29	OR	108	108	108	N
30	800	1/8"	1/8"	1/8"	OT
31	OR	4412	4437	4437	N
32	OR	3137	3137	3137	N
33	830	34/76	34/76	34/76	4L
34	830	51	63/76	63/76	4L
35	830	34/76	34/76	34/76	4L
36	830	34/76	34/76	34/76	4L
37	830	34/76	34/76	34/76	4L
39	015	U	U	U	
42	OR	2540	2450	2450	N
43	OR	108	108	108	N
45	830	34/76	34/76	34/76	4L
46	830	51/76	51/76	51/76	4L
47	OR	6275	6275	6275	N
48	OR	2325	2325	2325	N
49	OR	2010	2010	2010	N
50	OR	3100	3100	3100	N
51	TCC	6x25	6x25	6x25	4L



Pneumatic valve 3-A  
2-ways L - plain ends  
AISI 304L, AISI 316L

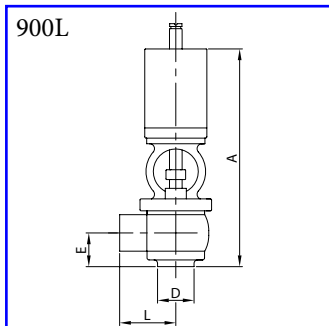

DN	A	D	E	L	Kg
28	243,0	28,0	38,0	45,0	3,51
34	252,0	34,0	44,0	50,0	3,72
40	256,0	40,0	45,0	56,0	3,72
52	315,0	52,0	53,0	70,0	6,50
70	334,0	70,0	59,5	78,0	8,30
85	372,0	85,0	66,0	93,0	13,66
101	453,0	101,6	90,5	135,0	19,20

Pneumatic valve 3-A  
2-ways L - male ends  
AISI 304L, AISI 316L

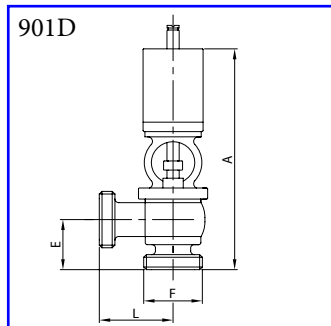

DN	A	E	F	L	Kg
25	262,0	57,0	52-6	58,0	3,75
32	271,0	63,0	58-6	61,0	4,02
40	275,0	64,0	65-6	60,0	4,08
50	334,0	72,0	78-6	73,0	6,98
65	355,0	80,5	95-6	81,0	8,98
80	397,0	91,0	110-4	89,0	14,74
100	477,5	115,0	130-4	152,0	20,68

Pneumatic valve 3-A  
3-ways T - plain ends  
AISI 304L, AISI 316L

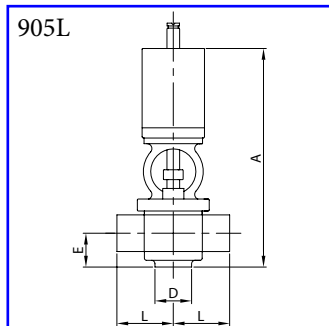

DN	A	D	E	L	Kg
28	243,0	28,0	38,0	45,0	3,51
34	252,0	34,0	44,0	50,0	3,72
40	256,0	40,0	45,0	56,0	3,72
52	315,0	52,0	53,0	70,0	6,50
70	334,0	70,0	59,5	78,0	8,30
85	372,0	85,0	66,0	93,0	13,66
101	453,0	101,6	90,5	135,0	19,20

Pneumatic valve 3-A  
3-ways T - male ends  
AISI 304L, AISI 316L

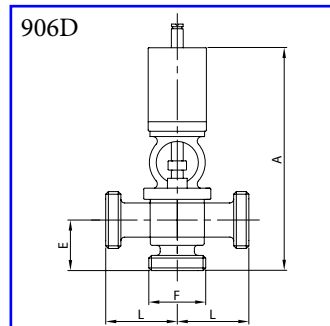

DN	A	E	F	L	Kg
25	262,0	57,0	52-6	58,0	3,87
32	271,0	63,0	58-6	61,0	4,17
40	275,0	64,0	65-6	60,0	4,26
50	334,0	72,0	78-6	73,0	7,22
65	355,0	80,5	95-6	81,0	9,32
80	397,0	91,0	110-4	89,0	15,28
100	477,5	115,0	130-4	152,0	21,42

Pneumatic valve 3-A  
3-ways LL - plain ends  
AISI 304L, AISI 316L

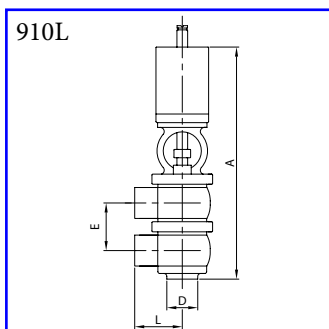

DN	A	D	E	L	Kg
28	301,0	28,0	58,0	45,0	4,67
34	316,0	34,0	64,0	50,0	5,10
40	326,0	40,0	70,0	56,0	5,10
52	395,0	52,0	80,0	70,0	9,10
70	435,0	70,0	101,0	78,0	11,65
85	483,0	85,0	112,0	93,0	18,2
101	624,0	101,6	171,0	135,0	23,0

Pneumatic valve 3-A  
4-ways LT - plain ends  
AISI 304L, AISI 316LL

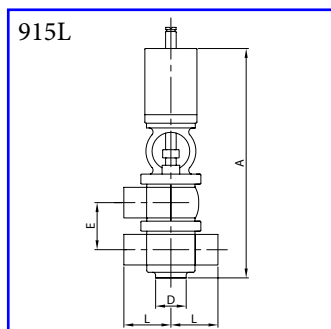

DN	A	D	E	L	Kg
28	301,0	28,0	58,0	45,0	4,67
34	316,0	34,0	64,0	50,0	5,10
40	326,0	40,0	70,0	56,0	5,10
52	395,0	52,0	80,0	70,0	9,10
70	435,0	70,0	101,0	78,0	11,65
85	483,0	85,0	112,0	93,0	18,2
101	624,0	101,6	171,0	135,0	23,0

Pneumatic valve 3-A  
4-ways TL - plain ends  
AISI 304L, AISI 316L

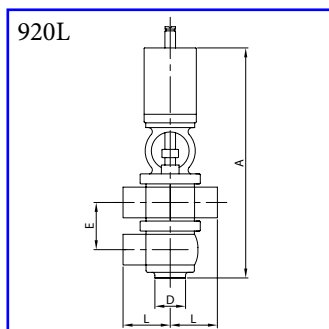

DN	A	D	E	L	Kg
28	301,0	28,0	58,0	45,0	4,67
34	316,0	34,0	64,0	50,0	5,10
40	326,0	40,0	70,0	56,0	5,10
52	395,0	52,0	80,0	70,0	9,10
70	435,0	70,0	101,0	78,0	11,65
85	483,0	85,0	112,0	93,0	18,2
101	624,0	101,6	171,0	135,0	23,0

Pneumatic valve 3-A  
5-ways TT - plain ends  
AISI 304L, AISI 316L

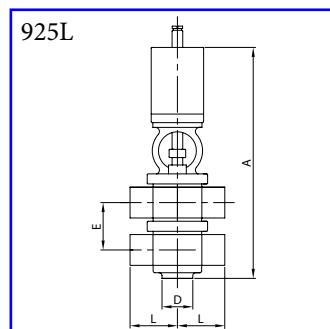

DN	A	D	E	L	Kg
28	301,0	28,0	58,0	45,0	4,67
34	316,0	34,0	64,0	50,0	5,10
40	326,0	40,0	70,0	56,0	5,10
52	395,0	52,0	80,0	70,0	9,10
70	435,0	70,0	101,0	78,0	11,65
85	483,0	85,0	112,0	93,0	18,2
101	624,0	101,6	171,0	135,0	23,0

Pneumatic valve 3-A  
3-ways LL - male ends  
AISI 304L, AISI 316L

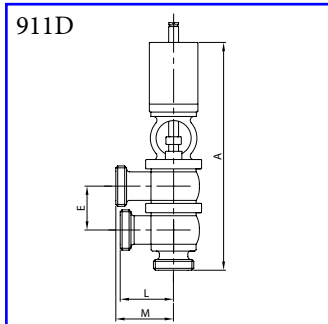

DN	A	E	L	M	Kg
25	320,0	58,0	58,0	93,0	5,03
32	335,0	64,0	61,0	96,0	5,55
40	345,0	70,0	60,0	95,0	5,64
50	414,0	80,0	73,0	108,0	9,82
65	456,0	101,0	81,0	116,0	12,67
80	508,0	112,0	89,0	124,0	19,82
100	648,5	171,0	152,0	152,0	25,22

Pneumatic valve 3-A  
4-ways LT - male ends  
AISI 304L, AISI 316L

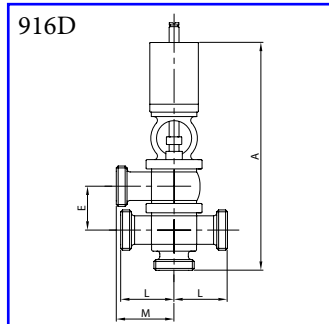

DN	A	E	L	M	Kg
25	320,0	58,0	58,0	93,0	5,15
32	335,0	64,0	61,0	96,0	5,70
40	345,0	70,0	60,0	95,0	5,82
50	414,0	80,0	73,0	108,0	10,06
65	456,0	101,0	81,0	116,0	13,01
80	508,0	112,0	89,0	124,0	20,36
100	648,5	171,0	152,0	152,0	25,96

Pneumatic valve 3-A  
4-ways TL - male ends  
AISI 304L, AISI 316L

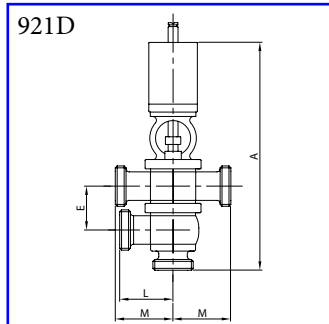

DN	A	E	L	M	Kg
25	320,0	58,0	58,0	93,0	5,15
32	335,0	64,0	61,0	96,0	5,70
40	345,0	70,0	60,0	95,0	5,82
50	414,0	80,0	73,0	108,0	10,06
65	456,0	101,0	81,0	116,0	13,01
80	508,0	112,0	89,0	124,0	20,36
100	648,5	171,0	152,0	152,0	25,96

Pneumatic valve 3-A  
5-ways TT - male ends  
AISI 304L, AISI 316L

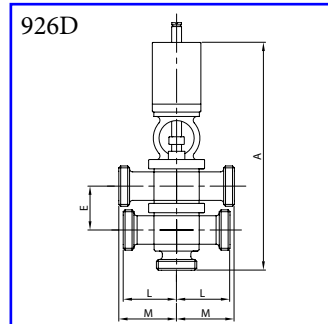

DN	A	E	L	M	Kg
25	320,0	58,0	58,0	93,0	5,27
32	335,0	64,0	61,0	96,0	5,85
40	345,0	70,0	60,0	95,0	6,00
50	414,0	80,0	73,0	108,0	10,30
65	456,0	101,0	81,0	116,0	13,35
80	508,0	112,0	89,0	124,0	20,90
100	648,5	171,0	152,0	152,0	26,70

Manual valve  
2-ways L - plain ends  
AISI 304L, AISI 316L

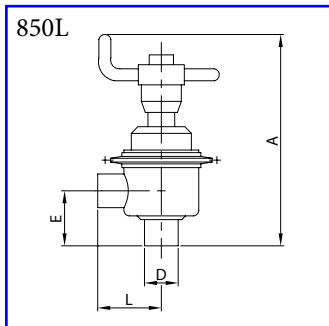

DN	A	D	E	L	Kg
28	245,0	28,0	44,5	66,5	2,15
34	254,0	34,0	53,0	66,5	2,17
40	250,0	40,0	49,0	66,5	2,17
52	290,0	52,0	58,0	74,0	2,88
70	365,0	70,0	71,0	95,0	4,50
85	388,0	85,0	83,0	95,0	7,75

Manual valve  
3-ways T - plain ends  
AISI 304L, AISI 316L

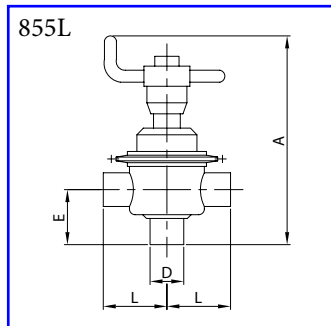

DN	A	D	E	L	Kg
28	245,0	28,0	44,5	66,5	2,20
34	254,0	34,0	53,0	66,5	2,19
40	250,0	40,0	49,0	66,5	2,20
52	290,0	52,0	58,0	74,0	2,73
70	365,0	70,0	71,0	95,0	4,78
85	388,0	85,0	83,0	95,0	7,84

Manual valve  
3-ways LL - plain ends  
AISI 304L, AISI 316L

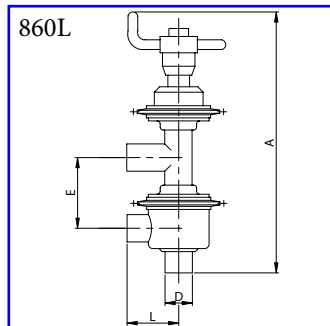

DN	A	D	E	L	Kg
28	326,0	28,0	81,0	66,5	2,54
34	335,0	34,0	81,0	66,5	2,55
40	331,0	40,0	81,0	66,5	2,56
52	385,0	52,0	95,0	74,0	3,23
70	480,0	70,0	115,0	95,0	5,85
85	519,0	85,0	131,0	95,0	9,10

Manual valve  
4-ways LT - plain ends  
AISI 304L, AISI 316L

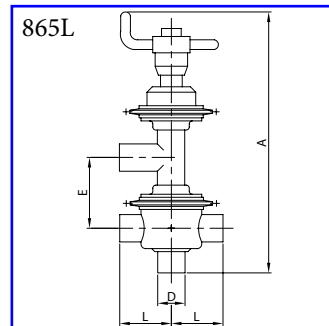

DN	A	D	E	L	Kg
28	326,0	28,0	81,0	66,5	2,60
34	335,0	34,0	81,0	66,5	2,61
40	331,0	40,0	81,0	66,5	2,60
52	385,0	52,0	95,0	74,0	3,26
70	480,0	70,0	115,0	95,0	5,95
85	519,0	85,0	131,0	95,0	9,25

Manual valve  
2-ways L - male ends  
AISI 304L, AISI 316L

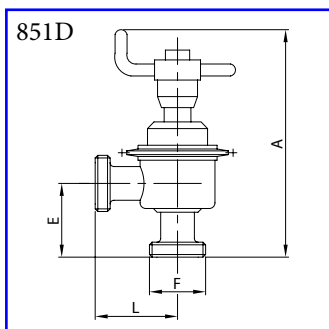

DN	A	E	F	L	Kg
25	259,0	59,0	52-6	81,0	2,30
32	268,0	67,0	58-6	81,0	2,35
40	263,0	62,0	65-6	80,0	2,40
50	303,0	71,0	78-6	87,0	2,99
65	380,0	86,0	95-6	110,0	4,95
80	405,0	100,0	110,4	112,0	8,35

Manual valve  
3-ways T - male ends  
AISI 304L, AISI 316L

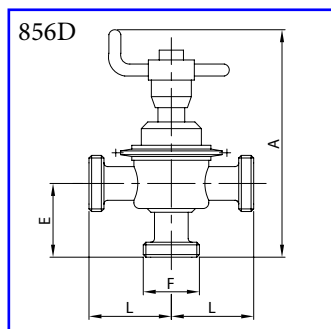

DN	A	E	F	L	Kg
25	259,0	59,0	52-6	81,0	2,38
32	268,0	67,0	58-6	81,0	2,45
40	263,0	62,0	65-6	80,0	2,52
50	303,0	71,0	78-6	87,0	3,15
65	380,0	86,0	95-6	110,0	5,30
80	405,0	100,0	110,4	112,0	8,74

Manual valve  
3-ways LL - male ends  
AISI 304L, AISI 316L

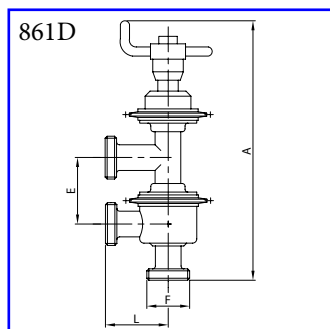

DN	A	E	F	L	Kg
25	340,0	81,0	52-6	81,0	2,74
32	349,0	81,0	58-6	81,0	2,80
40	344,0	81,0	65-6	80,0	2,89
50	398,0	95,0	78-6	87,0	3,65
65	495,0	115,0	95-6	110,0	6,42
80	536,0	131,0	110-4	112,0	10,0

Manual valve  
4-ways LT - male ends  
AISI 304L, AISI 316L

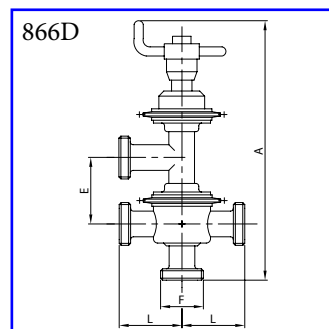

DN	A	E	F	L	Kg
25	340,0	81,0	52-6	81,0	2,84
32	349,0	81,0	58-6	81,0	2,92
40	344,0	81,0	65-6	80,0	3,02
50	398,0	95,0	78-6	87,0	3,82
65	495,0	115,0	95-6	110,0	6,71
80	536,0	131,0	110-4	112,0	10,45

Pneumatic valve 3-A  
2-ways L - plain ends  
AISI 304L, AISI 316L

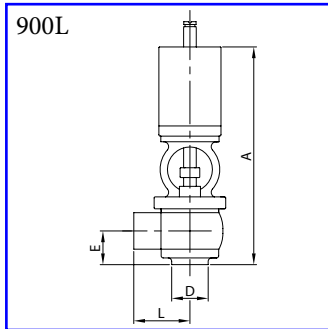

DN	A	D	E	L	Kg
25	241,0	25,4	38,0	45,0	3,51
38	253,0	38,1	43,5	56,0	3,72
51	315,0	50,8	53,0	70,0	6,50
63	329,0	63,5	57,0	78,0	8,25
76	366,0	76,2	65,5	85,0	10,85
101	453,0	101,6	90,5	135,0	19,20

Pneumatic valve 3-A  
2-ways L - male ends  
AISI 304L, AISI 316L

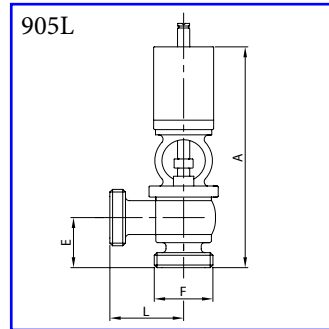

DN	A	E	F	L	Kg
25	256,0	53,0	40-6	58,0	3,63
38	273,0	63,5	60-6	60,0	4,08
51	335,0	73,0	70-6	73,0	6,88
63	353,0	81,0	85-6	81,0	8,95
76	390,0	89,5	98-6	89,0	11,77
101	477,5	115,0	132-6	160,0	21,0

Pneumatic valve 3-A  
3-ways T - plain ends  
AISI 304L, AISI 316L

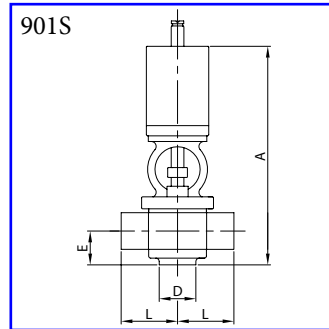

DN	A	D	E	L	Kg
25	241,0	25,4	38,0	45,0	3,51
38	253,0	38,1	43,5	56,0	3,72
51	315,0	50,8	53,0	70,0	6,50
63	329,0	63,5	57,0	78,0	8,25
76	366,0	76,2	65,5	85,0	10,85
101	453,0	101,6	90,5	135,0	19,20

Pneumatic valve 3-A  
3-ways T - male ends  
AISI 304L, AISI 316L

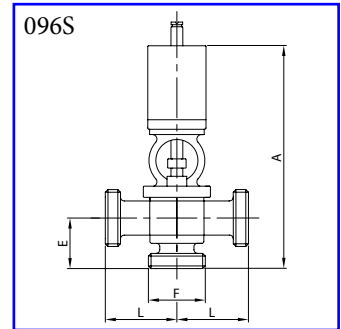

DN	A	E	F	L	Kg
25	256,0	53,0	40-6	58,0	3,69
38	273,0	63,5	60-6	60,0	4,26
51	335,0	73,0	70-6	73,0	7,07
63	355,0	81,0	85-6	81,0	9,30
76	390,0	89,5	98-6	89,0	12,23
101	477,5	115,0	132-6	160,0	21,9

Pneumatic valve 3-A  
3-ways LL - plain ends  
AISI 304L, AISI 316L

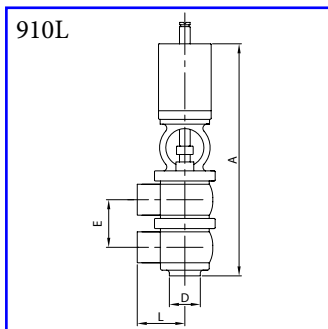

DN	A	D	E	L	Kg
25	295,0	25,4	54,0	45,0	4,67
38	320,0	38,1	67,0	56,0	5,10
51	395,0	50,8	80,0	70,0	9,10
63	425,0	63,5	96,0	78,0	11,0
76	469,0	76,2	103,0	85,0	15,1
101	624,0	101,6	171,0	135,0	23,0

Pneumatic valve 3-A  
4-ways LT - plain ends  
AISI 304L, AISI 316L

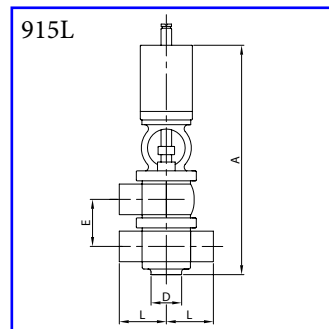

DN	A	D	E	L	Kg
25	295,0	25,4	54,0	45,0	4,67
38	320,0	38,1	67,0	56,0	5,10
51	395,0	50,8	80,0	70,0	9,10
63	425,0	63,5	96,0	78,0	11,0
76	469,0	76,2	103,0	85,0	15,1
101	624,0	101,6	171,0	135,0	23,0

Pneumatic valve 3-A  
4-ways TL - plain ends  
AISI 304L, AISI 316L

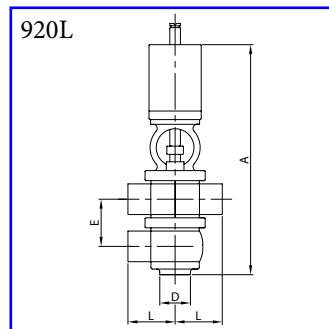

DN	A	D	E	L	Kg
25	295,0	25,4	54,0	45,0	4,67
38	320,0	38,1	67,0	56,0	5,10
51	395,0	50,8	80,0	70,0	9,10
63	425,0	63,5	96,0	78,0	11,0
76	469,0	76,2	103,0	85,0	15,1
101	624,0	101,6	171,0	135,0	23,0

Pneumatic valve 3-A  
5-ways TT - plain ends  
AISI 304L, AISI 316L

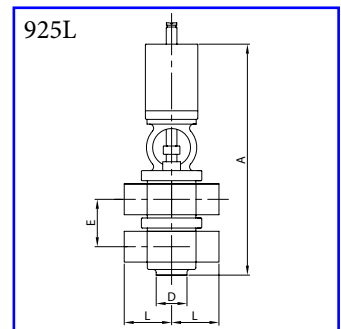

DN	A	D	E	L	Kg
25	295,0	25,4	54,0	45,0	4,67
38	320,0	38,1	67,0	56,0	5,10
51	395,0	50,8	80,0	70,0	9,10
63	425,0	63,5	96,0	78,0	11,0
76	469,0	76,2	103,0	85,0	15,1
101	624,0	101,6	171,0	135,0	23,0

Pneumatic valve 3-A  
3-ways LL - male ends  
AISI 304L, AISI 316L

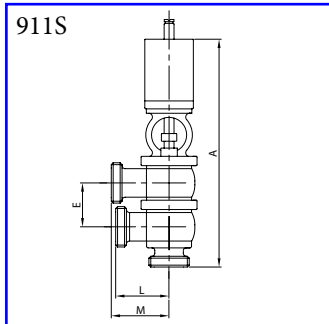

DN	A	E	L	M	Kg
25	310,0	54,0	58,0	93,0	4,85
38	340,0	67,0	60,0	95,0	5,64
51	415,0	80,0	73,0	108,0	9,67
63	449,0	96,0	81,0	116,0	12,05
76	493,0	103,0	89,0	124,0	16,48
101	648,5	171,0	160,0	160,0	25,70

Pneumatic valve 3-A  
4-ways LT - male ends  
AISI 304L, AISI 316L

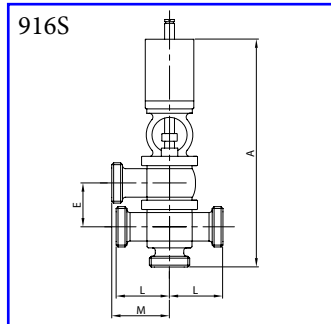

DN	A	E	L	M	Kg
25	310,0	54,0	58,0	93,0	4,91
38	340,0	67,0	60,0	95,0	5,82
51	415,0	80,0	73,0	108,0	9,86
63	449,0	96,0	81,0	116,0	12,4
76	493,0	103,0	89,0	124,0	16,94
101	648,5	171,0	160,0	160,0	26,6

Pneumatic valve 3-A  
4-ways TL - male ends  
AISI 304L, AISI 316L

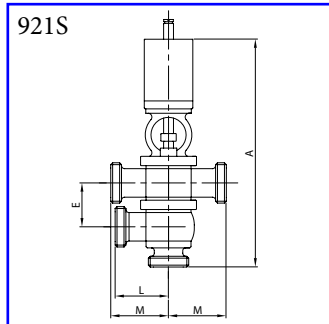

DN	A	E	L	M	Kg
25	310,0	54,0	58,0	93,0	4,91
38	340,0	67,0	60,0	95,0	5,82
51	415,0	80,0	73,0	108,0	9,86
63	449,0	96,0	81,0	116,0	12,4
76	493,0	103,0	89,0	124,0	16,94
101	648,5	171,0	160,0	160,0	26,6

Pneumatic valve 3-A  
5-ways TT - male ends  
AISI 304L, AISI 316L

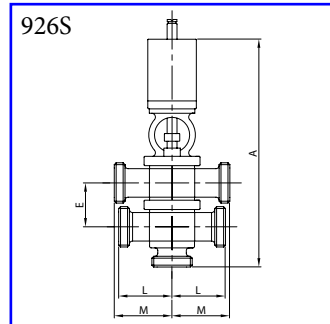

DN	A	E	L	M	Kg
25	310,0	54,0	58,0	93,0	4,97
38	340,0	67,0	60,0	95,0	6,00
51	415,0	80,0	73,0	108,0	10,05
63	449,0	96,0	81,0	116,0	12,75
76	493,0	103,0	89,0	124,0	17,40
101	648,5	171,0	160,0	160,0	27,50

Manual valve  
2-ways L - plain ends  
AISI 304L, AISI 316L

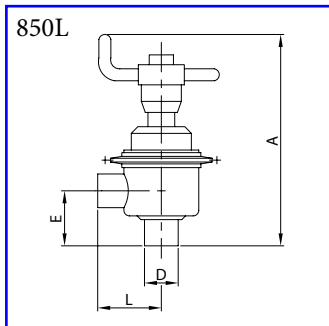

DN	A	D	E	L	Kg
25	251,5	25,4	50,5	66,5	2,185
38	251,0	38,1	50,0	66,5	2,18
51	290,0	50,8	58,5	74,0	2,70
63	361,0	63,5	67,5	95,0	4,53
76	372,0	76,2	76,0	95,0	4,74

Manual valve  
3-ways T - plain ends  
AISI 304L, AISI 316L

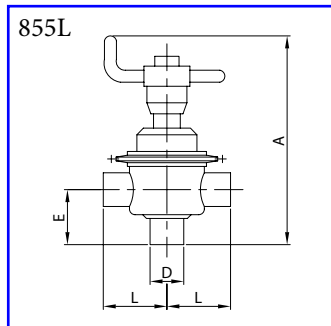

DN	A	D	E	L	Kg
25	251,5	25,4	50,5	66,5	2,20
38	251,0	38,1	50,0	66,5	2,20
51	290,0	50,8	58,5	74,0	2,73
63	361,0	63,5	67,5	95,0	4,70
76	372,0	76,2	76,0	95,0	4,74

Manual valve  
3-ways LL - plain ends  
AISI 304L, AISI 316L

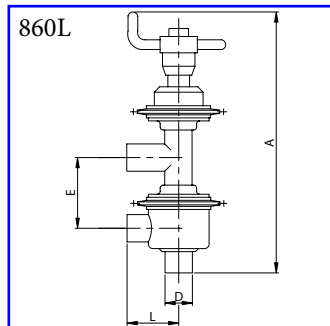

DN	A	D	E	L	Kg
25	332,5	25,4	81,0	66,5	2,54
38	332,0	38,1	81,0	66,5	2,56
51	385,0	50,8	95,0	74,0	3,23
63	476,0	63,5	115,0	95,0	5,75
76	503,0	76,2	131,0	95,0	5,95

Manual valve  
4-ways LT - plain ends  
AISI 304L, AISI 316L

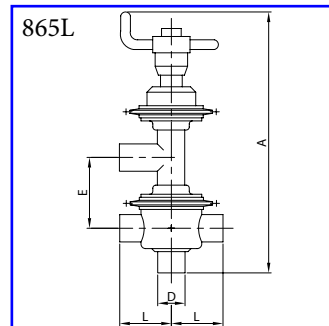

DN	A	D	E	L	Kg
25	332,5	25,4	81,0	66,5	2,57
38	332,0	38,1	81,0	66,5	2,60
51	385,0	50,8	95,0	74,0	3,25
63	476,0	63,5	115,0	95,0	5,90
76	503,0	76,2	131,0	95,0	6,20

Manual valve  
2-ways L - male ends  
AISI 304L, AISI 316L

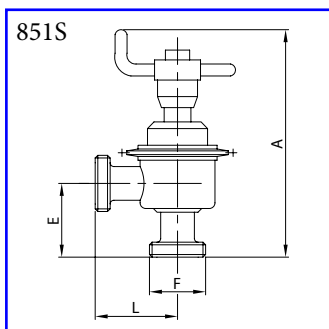

DN	A	E	F	L	Kg
25	251,5	50,5	40-6	66,5	2,26
38	251,0	50,0	60-6	66,5	2,38
51	290,0	58,5	70-6	74,0	2,93
63	361,0	67,5	85-6	95,0	4,90
76	372,0	76,0	98-6	95,0	5,24

Manual valve  
3-ways T - male ends  
AISI 304L, AISI 316L

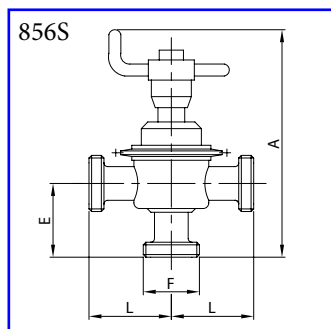

DN	A	E	F	L	Kg
25	251,5	50,5	40-6	66,5	2,30
38	251,0	50,0	60-6	66,5	2,50
51	290,0	58,5	70-6	74,0	3,10
63	361,0	67,5	85-6	95,0	5,30
76	372,0	76,0	98-6	95,0	5,42

Manual valve  
3-ways LL - male ends  
AISI 304L, AISI 316L

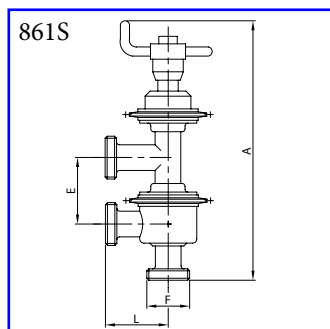

DN	A	E	F	L	Kg
25	332,5	81,0	40-6	66,5	2,645
38	332,0	81,0	60-6	66,5	2,85
51	385,0	95,0	70-6	74,0	3,57
63	476,0	115,0	85-6	95,0	6,34
76	503,0	131,0	98-6	95,0	6,70

Manual valve  
4-ways LT - male ends  
AISI 304L, AISI 316L

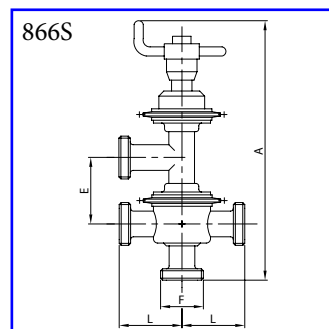

DN	A	E	F	L	Kg
25	332,5	81,0	40-6	66,5	2,71
38	332,0	81,0	60-6	66,5	3,00
51	385,0	95,0	70-6	74,0	3,70
63	476,0	115,0	85-6	95,0	6,68
76	503,0	131,0	98-6	95,0	7,20

Pneumatic valve 3-A  
2-ways L - plain ends  
AISI 316L

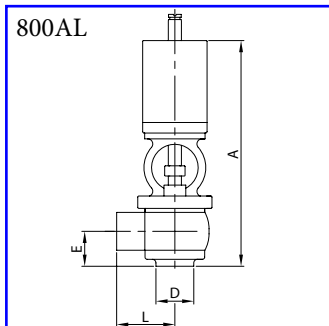

DN	A	D	E	L	Kg
1" 25	241	25,4	38	50	4,32
1 1/2" 38	253	38,1	44	56	4,62
2" 51	310	50,8	48	65	9,50
2 1/2" 63	326	63,5	54	78	13,08
3" 76	364	76,2	64	84	15,00
4" 101	454	101,6	90	135	27,00

Pneumatic valve 3-A  
2-ways L - CLAMP  
AISI 316L

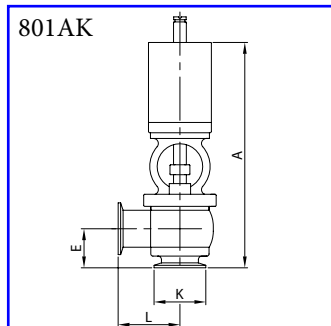

DN	A	E	K	L	Kg
1" 25	253,7	50,7	50,5	62,7	4,34
1 1/2" 38	265,7	56,7	50,5	68,7	4,65
2" 51	322,7	60,7	64,0	77,7	9,55
2 1/2" 63	338,7	66,7	77,0	90,7	13,14
3" 76	376,7	76,7	91,0	96,7	15,07
4" 101	469,8	105,8	119,0	150,8	27,13

Pneumatic valve 3-A  
3-ways T - plain ends  
AISI 316L

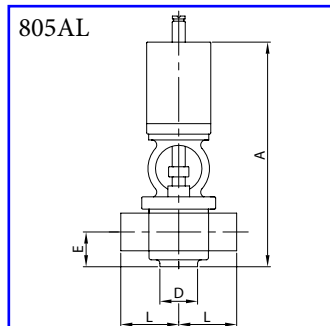

DN	A	D	E	L	Kg
1" 25	241	25,4	38	50	4,33
1 1/2" 38	253	38,1	44	56	4,64
2" 51	310	50,8	48	65	9,53
2 1/2" 63	326	63,5	54	78	13,12
3" 76	364	76,2	64	84	15,05
4" 101	454	101,6	90	135	27,09

Pneumatic valve 3-A  
3-ways T - CLAMP  
AISI 316L

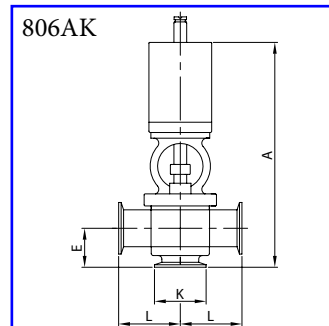

DN	A	K	E	L	Kg
1" 25	253,7	50,7	50,5	62,7	4,36
1 1/2" 38	265,7	56,7	50,5	68,7	4,70
2" 51	322,7	60,7	64,0	77,7	9,60
2 1/2" 63	338,7	66,7	77,0	90,7	13,21
3" 76	376,7	76,7	91,0	96,7	15,16
4" 101	469,8	105,8	119,0	150,8	27,29

Pneumatic valve 3-A  
3-ways LL - plain ends  
AISI 316L

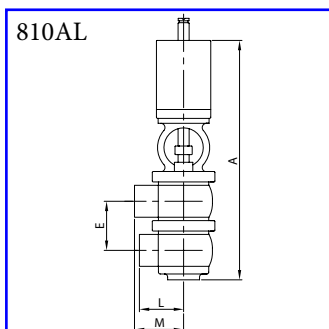

DN	A	E	L	M	Kg
1" 25	295	54	50	60	5,46
1 1/2" 38	320	67	56	65	6,36
2" 51	390	80	65	80	10,28
2 1/2" 63	422	96	78	100	17,28
3" 76	467	103	84	106	18,60
4" 101	625	157	135	135	31,00

Pneumatic valve 3-A  
3-ways LL - CLAMP  
AISI 316L

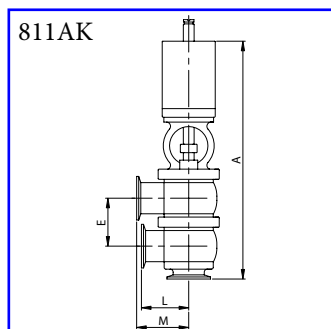

DN	A	E	L	M	Kg
1" 25	307,7	54,0	62,7	72,7	5,49
1 1/2" 38	332,7	67,0	68,7	77,7	6,40
2" 51	402,7	80,0	77,7	92,7	10,35
2 1/2" 63	434,7	96,0	90,7	112,7	17,37
3" 76	479,7	103,0	96,7	118,7	18,70
4" 101	640,8	157,0	150,8	150,8	31,18

Pneumatic valve 3-A  
4-ways TL - plain ends  
AISI 316L

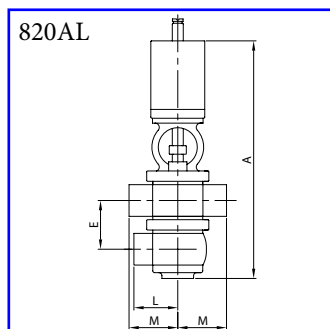

DN	A	E	L	M	Kg
1" 25	295	54	50	60	5,47
1 1/2" 38	320	67	56	65	6,38
2" 51	390	80	65	80	10,31
2 1/2" 63	422	96	78	100	17,32
3" 76	467	103	84	106	18,65
4" 101	625	157	135	135	31,09

Pneumatic valve 3-A  
4-ways TL - CLAMP  
AISI 316L

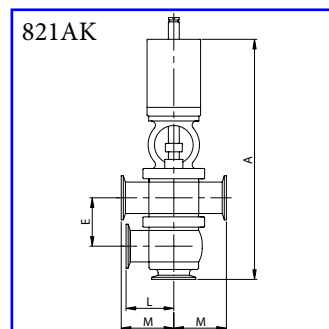

DN	A	E	L	M	Kg
1" 25	307,7	54,0	62,7	72,7	5,51
1 1/2" 38	332,7	67,0	68,7	77,7	6,44
2" 51	402,7	80,0	77,7	92,7	10,41
2 1/2" 63	434,7	96,0	90,7	112,7	17,44
3" 76	479,7	103,0	96,7	118,7	18,79
4" 101	640,8	157,0	150,8	150,8	31,34



Pneumatic valve 3-A  
5-ways TT - plain ends  
AISI 316L

Pneumatic valve 3-A  
5-ways TT - CLAMP  
AISI 316L

825 AL

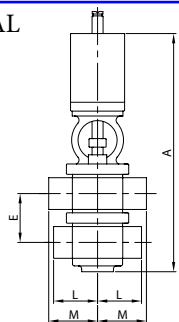

826 AK

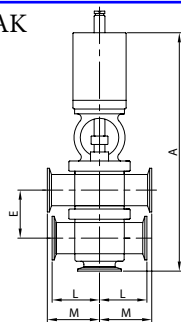

DN	A	E	L	M	Kg	
1"	25	295	54	50	60	5,48
1 1/2"	38	320	67	56	65	6,40
2"	51	390	80	65	80	10,34
2 1/2"	63	422	96	78	100	17,36
3"	76	467	103	84	106	18,70
4"	101	625	157	135	135	31,18

DN	A	E	L	M	Kg	
1"	25	307,7	54	62,7	72,7	5,53
1 1/2"	38	332,7	67	68,7	77,7	6,47
2"	51	402,7	80	77,7	92,7	10,46
2 1/2"	63	434,7	96	90,7	112,7	17,51
3"	76	479,7	103	96,7	118,7	18,87
4"	101	640,8	157	150,8	150,8	31,35



Drainage pneumatic valve  
2-ways LL - plain ends  
AISI 316L

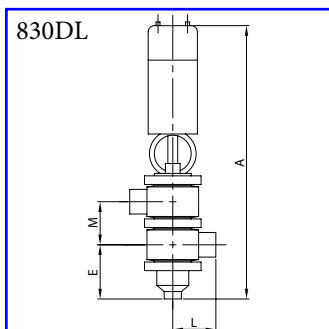

DN	A	E	L	M	Kg
51	586,0	103,0	75,0	79,0	16,5
63	646,0	108,0	90,0	91,0	21,5
76	680,0	118,0	95,0	110,0	25,0

Drainage pneumatic valve  
3-ways LT - plain ends  
AISI 316L

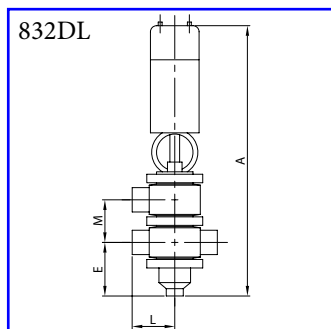

DN	A	E	L	M	Kg
51	586,0	103,0	75,0	79,0	16,6
63	646,0	108,0	90,0	91,0	21,7
76	680,0	118,0	95,0	110,0	25,2

Drainage pneumatic valve  
3-ways TL - plain ends  
AISI 316L

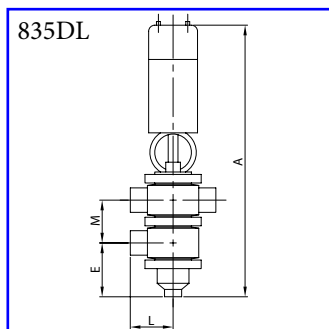

DN	A	E	L	M	Kg
51	586,0	103,0	75,0	79,0	16,6
63	646,0	108,0	90,0	91,0	21,7
76	680,0	118,0	95,0	110,0	25,2

Drainage pneumatic valve  
3-ways LLL - plain ends  
AISI 316L

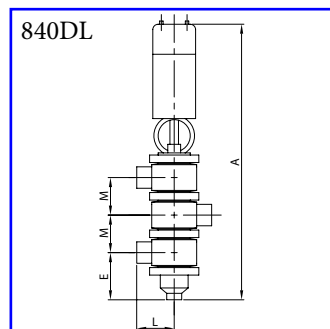

DN	A	E	L	M	Kg
51	665,0	103,0	75,0	79,0	14,4
63	737,0	108,0	90,0	91,0	18,4
76	790,0	118,0	95,0	110,0	22,0

Drainage pneumatic valve  
4-ways TT - plain ends  
AISI 316L

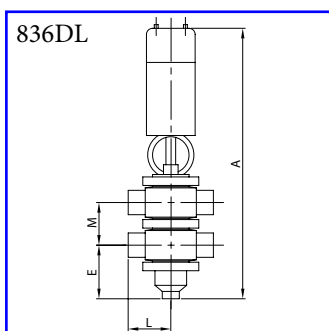

DN	A	E	L	M	Kg
51	586,0	103,0	75,0	79,0	16,7
63	646,0	108,0	90,0	91,0	22,0
76	680,0	118,0	95,0	110,0	25,5

Drainage pneumatic valve  
4-ways TLL - plain ends  
AISI 316L

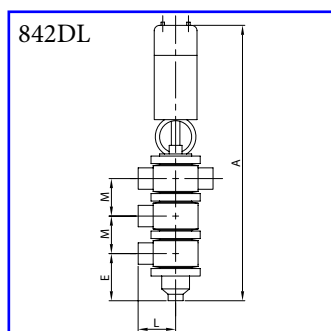

DN	A	E	L	M	Kg
51	665,0	103,0	75,0	79,0	14,4
63	737,0	108,0	90,0	91,0	18,4
76	790,0	118,0	95,0	110,0	22,0

Drainage pneumatic valve  
5-ways TTL - plain ends  
AISI 316L

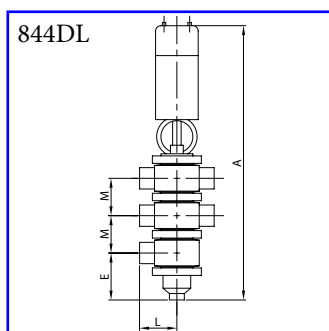

DN	A	E	L	M	Kg
51	665,0	103,0	75,0	79,0	14,5
63	737,0	108,0	90,0	91,0	18,5
76	790,0	118,0	95,0	110,0	22,0

Drainage pneumatic valve  
6-ways TTT - plain ends  
AISI 316L

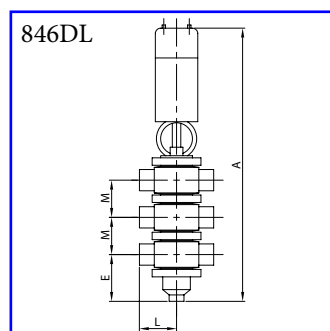

DN	A	E	L	M	Kg
51	665,0	103,0	75,0	79,0	14,6
63	737,0	108,0	90,0	91,0	18,7
76	790,0	118,0	95,0	110,0	22,2