

BALL VALVES I.
(page 2)



BALL VALVES II.
(page 12)



BALL VALVES III.
(page 19)





- Heavy duty construction.
- Parts in contact with the fluid made exclusively of AISI 316L stainless steel.
- On request available in AISI 304L stainless steel.
- Easy to sterilize. Internal parts easy to reach during CIP process in models 50 and 51.
- Easy to disassemble. On-line disassembly in models 90 and 91. Sanitary gasket in model 90.
- Ball contained in the flange with resulting lightening of the structure and reduction of valve volume in the 71 model.
- One welded end and one end on request, produced in conformity with DIN, SMS standards in the 81 model.
- Can be equipped with manual or pneumatic controls.
- Horizontal and vertical single or double-effect, and modulating pneumatic controls. Can be equipped with proximity contact, microswitch (electrical or pneumatic), solenoid valve (24 V AC or DC, 48 V AC), connector.
- Maximum operating pressure: 10 bars.
- Standard finish: 150 grain external polishing and internal glazing. Other finishes on request.

- | | | | | |
|---------------|--------------------|------------------|-------------------|-----------------|
| 1. Valve body | 5. Hexagon nut | 9. Washer | 13. OR seal ring | 17. Allen screw |
| 2. Ball | 6. Sanitary gasket | 10. Handle | 14. Hexagon screw | 18. PTFE washer |
| 3. Flange | 7. Gasket | 11. OR seal ring | 15. Hexagon nut | 19. PTFE ring |
| 4. Spindle | 8. Spacer | 12. OR seal ring | 16. PTFE pin | |

Ball valve

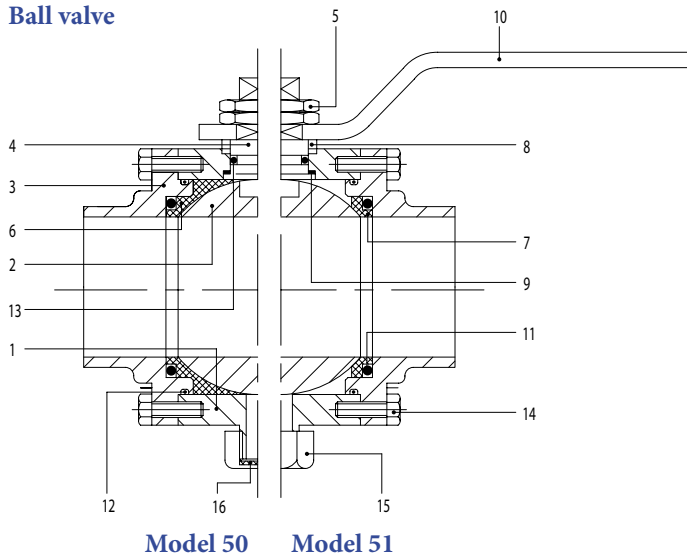

Model 50 Model 51

Ball valve

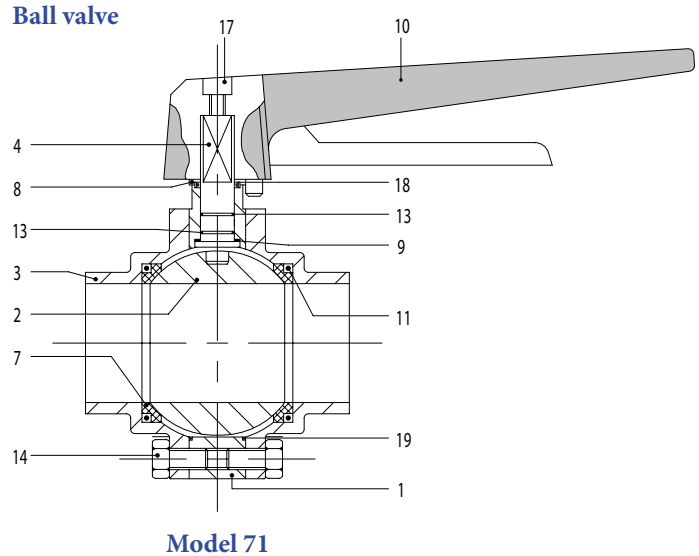

Model 71

Coding parts:

Pos.	Code	Norm	1"	1 1/2"	2"	2 1/2"	3"	4"	Material
1	K51		25	38	51	63	76	101	6L
2	K51		25	38	51	63	76	101	6L
3	K51	K	1"	1 1/2"	2"	2 1/2"	3"	4"	6L
3	K51	W	25	38	51	63	76	101	6L
4	K51		25	38/101	38/101	38/101	38/101	38/101	4L
5	K51		25	38/101	38/101	38/101	38/101	38/101	4L
6	K51		25	38	51	63	76	101	T
7	K51		25	38	51	63	76	101	T
8	K51		25	38/101	38/101	38/101	38/101	38/101	4L
9	K51		25	38/101	38/101	38/101	38/101	38/101	T
10	K51		25	38/101	38/101	38/101	38/101	38/101	4L
11	OR		3106	4162	158	6275	6312	6450	N
12	OR		3125	3200	3262	3325	3400	3550	N
13	OR		3043	3050	3050	3050	3050	3050	N
14	VE		6x12	6x16	6x16	6x16	6x16	6x16	4L
15	K51		25/101	25/101	25/101	25/101	25/101	25/101	4L
16	K51		25/101	25/101	25/101	25/101	25/101	25/101	T

Coding parts:

Pos.	Code	Norm	1 1/2" 38	D40 40	2" 51	D50 52	2 1/2" 63	D65 70	3" 76	D80 85	Mat.
1	71		38/40	38/40	51/52	51/52	63	70	76	85	6L
2	71		38/40	38/40	51/52	51/52	63	70	76	85	6L
3	71	W	38	40	51	52	63	70	76	85	6L
3	71	D		40		50		65		80	6L
3	71	S	38		51		63		76		6L
3	71	B	38		51		63		76		6L
3	71	I	38		51		63		76		6L
4	71		38/40	38/40	51/52	51/52	63	70	76	85	4L
7	71		38/40	38/40	51/52	51/52	63	70	76	85	T
8	71		38/52	38/52	38/52	38/52	63/85	63/85	63/85	63/85	4L
9	71		38/52	38/52	38/52	38/52	63/85	63/85	63/85	63/85	T
10	7M8		25/76	25/76	25/76	25/76	25/76	25/76	25/76	85/101	A
11	OR		3175	3175	3212	3212	4275	177	4325	4337	N
13	OR		108	108	108	108	2043	2043	2043	2043	N
14	VE		6x16	6x16	6x16	6x16	6x16	6x16	6x16	6x16	N
17	TCCE		6x16	6x16	6x16	6x16	6x16	6x16	6x16	6x16	4L
18	91		38/52	35/52	38/52	38/52	63/85	63/85	63/85	63/85	T
19	71		38/40	38/40	51/52	51/52	63	70	76	85	T

Ball valve model 81

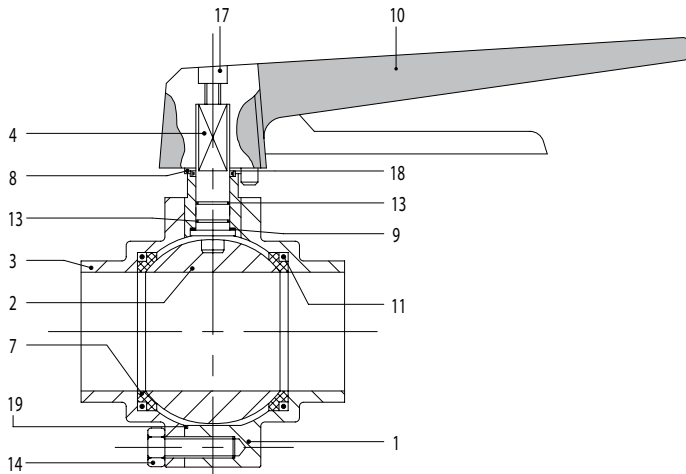

Ball valve

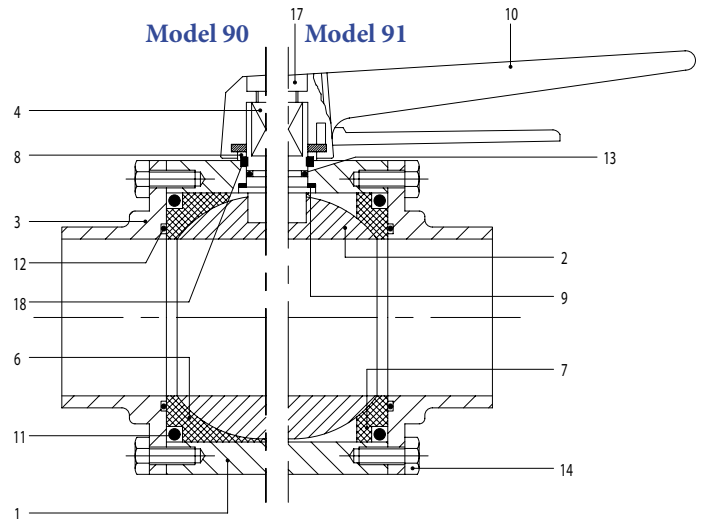

Coding part Model 81:

Pos.	Code	Norm	1 1/2" 38	D40 40	2" 51	D50 52	2 1/2" 63	D65 70	3" 76	D80 85	Mat.
1	81		38/40	38/40	51/52	51/52	63	70	76	85	316L
2	71		38/40	38/40	51/52	51/52	63	70	76	85	316L
3	71	W	38	40	51	52	63	70	76	85	316L
3	71	D		40		50		65		80	316L
3	71	S	38		51		63		76		316L
3	71	B	38		51		63		76		316L
3	71	I	38		51		63		76		316L
4	71		38/40	38/40	51/52	51/52	63	70	76	85	304L
7	71		38/40	38/40	51/52	51/52	63	70	76	85	PTFE
8	71		38/52	38/52	38/52	38/52	63/85	63/85	63/85	63/85	304L
9	71		38/52	38/52	38/52	38/52	63/85	63/85	63/85	63/85	PTFE
10	7M8		25/76	25/76	25/76	25/76	25/76	25/76	25/76	85/101	A
11	OR		3175	3175	3212	3212	4275	177	4325	4337	NBR
13	OR		108	108	108	108	2043	2043	2043	2043	NBR
14	VE		6x16	6x16	6x16	6x16	6x16	6x16	6x16	6x16	NBR
17	TCCE		6x16	6x16	6x16	6x16	6x16	6x16	6x16	6x16	304L
18	91		38/52	38/52	38/52	38/52	63/85	63/85	63/85	63/85	PTFE
19	71		38/40	38/40	51/52	51/52	63	70	76	85	PTFE

Coding parts Model 90/91:

Pos.	Code	Norm	1" 25	D25 28	D32 34	1 1/2" 38	D40 40	2" 51	D50 52	2 1/2" 63	D65 70	3" 76	D80 85	Mat.
1	91		25/28	25/28	34/40	34/40	34/40	51/52	51/52	63/70	63/70	76/85	76/85	316L
2	91		25/28	25/28	34/40	34/40	34/40	51/51	51/52	63/70	63/70	76/85	76/85	316L
3	91	W	25	28	34	38	40	51	52	63	70	76	85	316L
3	91	D		25	32		40		50		65		80	316L
3	91	S	25			38		51		63		76		316L
3	91	B	25			38		51		63		76		316L
3	91	I	25			38		51		63		76		316L
4	91		25/28	25/28	34/40	34/40	34/40	51/52	51/52	63/70	63/70	76/85	76/85	304L
6	90		25/28	25/28	34/40	34/40	34/40	51/52	51/52	63/70	63/70	76/85	76/85	PTFE
7	91		25/28	25/28	34/40	34/40	34/40	51/52	51/52	63/70	63/70	76/85	76/85	PTFE
8	91		25/52	25/52	25/52	25/52	25/52	25/52	25/52	63/85	63/85	63/85	63/85	304L
9	91		25/52	25/52	25/52	25/52	25/52	25/52	25/52	63/85	63/85	63/85	63/85	PTFE
10	7M8		25/52	25/52	25/52	25/52	25/52	25/52	25/52	63/85	63/85	63/85	63/85	A
11	OR		4131	4131	6200	6200	6200	6250	6250	6337	6337	189	189	NBR
12	OR		2106	2106	3162	3162	3162	3206	3206	3256	3256	3300	3300	NBR
13	OR		2050	2050	2050	2050	2050	2050	2050	2056	2056	2056	2056	NBR
14	VE		6x12	6x12	6x16	6x16	6x16	6x16	6x16	6x16	6x16	6x16	6x16	304L
17	TCCE		6x16	6x16	6x16	6x16	6x16	6x16	6x16	6x16	6x16	6x16	6x16	304L
18	91		25/52	25/52	25/52	25/52	25/52	25/52	25/52	63/85	63/85	63/85	63/85	NY

Pneumatic actuators, solenoid valve, microswitch, proximity contact, connector

Pneumatic actuator
double effect

7C1L

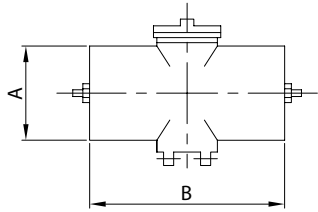

DN	A	B	Kg
25/52	60,0	138,5	1,46
63/85	76,0	161,0	2,10
101/104	89,0	180,0	2,96

Pneumatic actuator
single effect

7C2L

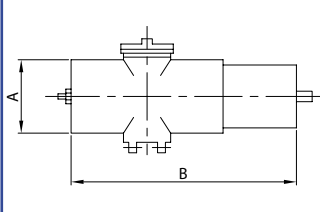

DN	A	B	Kg
25/52	76,0	240,0	2,19
63/85	89,0	260,0	3,15

Pneumatic actuator with
regulating flux

7C1LM

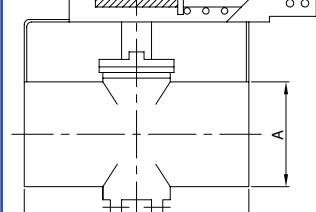

DN	A	B	Kg
25/104	89,0	180,0	4,16

Pneumatic actuator
single effect vertical

7C4L

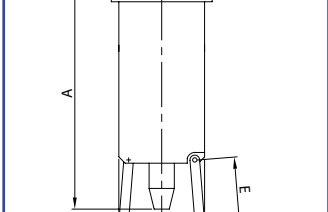

DN	A	B	E	Kg
25/52	211,0	76,0	64,0	3,70
63/104	211,0	76,0	58,0	3,70

Pneumatic actuator
vertical with control unit

7C4UC

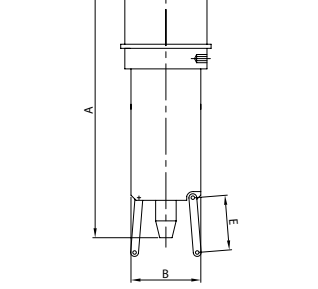

DN	A	B	E	Kg
25/52	316,0	76,0	64,0	3,90
63/104	316,0	76,0	58,0	3,90

Pneumatic actuator
vertical double effect

7C5L

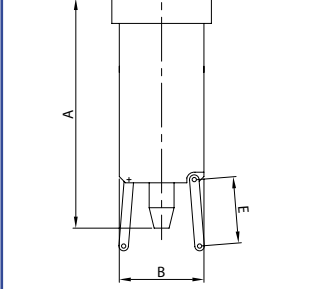

DN	A	B	E	Kg
25/52	211,0	76,0	64,0	3,70
63/104	211,0	76,0	58,0	3,70

Bracket

7C991

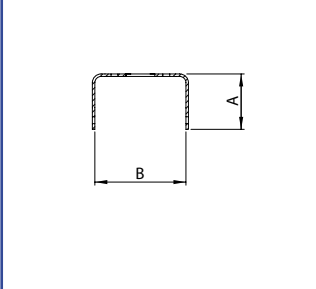

DN	A	B	Kg
25	59,0	46,0	0,20
38	62,0	62,0	0,21
51	66,5	74,0	0,24
63	68,5	88,0	0,26
76	66,0	99,0	0,26

Bracket

7C951

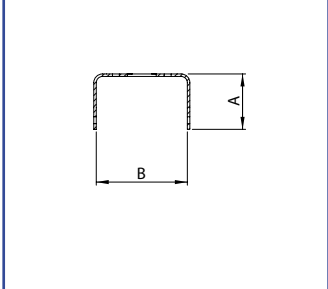

DN	A	B	Kg
25	68,5	45,0	0,22
38	80,5	61,0	0,24
51	77,0	72,0	0,26
63	75,5	86,0	0,30
76	76,0	97,0	0,30
101	75,5	126,0	0,33

Solenoid valve

015NC

015NA

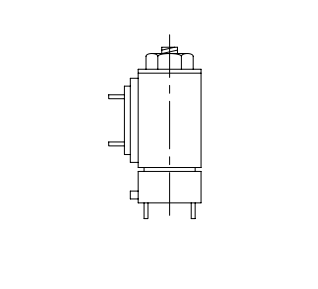

Microswitch

0141

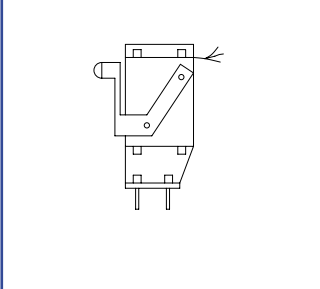

Proximity contact

0130

013S

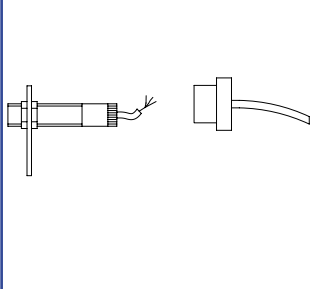

Connector

030H

030S

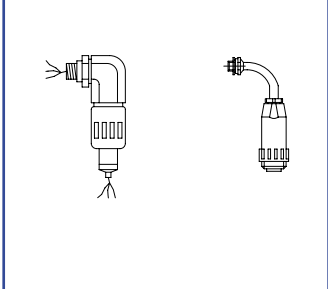

DIN

Ball valve
welding ends
AISI 316L

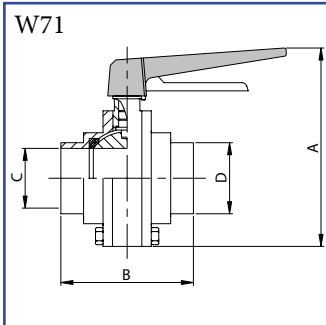

DN	A	B	C	D	Kg
40	138,0	73,0	37,0	40,0	1,60
52	155,0	80,0	49,0	52,0	2,60
70	187,0	112,0	66,0	70,0	4,70
85	204,0	121,0	81,0	85,0	5,50

Ball valve
male threads DIN 11851
AISI 316L

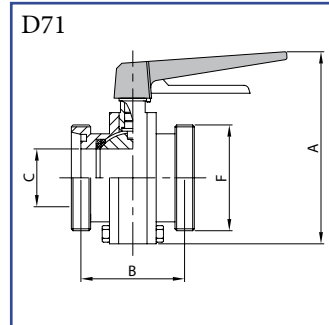

DN	A	B	C	F	Kg
40	138,0	73,0	37,0	65-6	1,90
50	155,0	106,0	66,0	78-6	2,90
65	187,0	114,0	81,0	95-6	5,30
80	204,0	114,0	81,0	110-4	6,30

Ball valve
male thread DIN / welding
AISI 316L

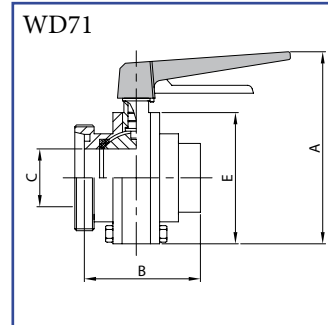

DN	A	B	C	E	Kg
40	138,0	73,0	37,0	81,0	1,75
50	155,0	78,0	49,0	98,0	2,75
65	187,0	109,0	66,0	130,0	5,00
80	204,0	117,5	81,0	147,0	5,80

Ball valve
welding ends
AISI 316L

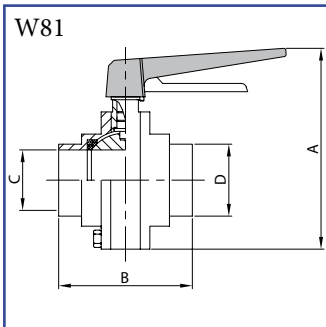

DN	A	B	C	D	Kg
40	138,0	73,0	37,0	40,0	1,60
52	155,0	80,0	49,0	52,0	2,60
70	187,0	112,0	66,0	70,0	4,70
85	204,0	121,0	81,0	85,0	5,50

Ball valve
male threads DIN 11851
AISI 316L

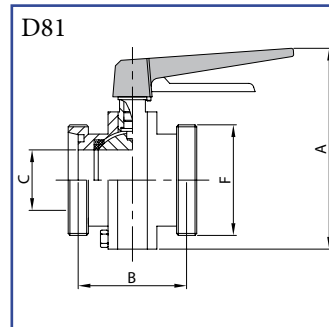

DN	A	B	C	F	Kg
40	138,0	73,0	37,0	65-6	1,90
50	155,0	76,0	49,0	78-6	2,90
65	187,0	106,0	66,0	96-6	5,30
80	204,0	114,0	81,0	110-4	6,30

Ball valve
male thread DIN / welding
AISI 316L

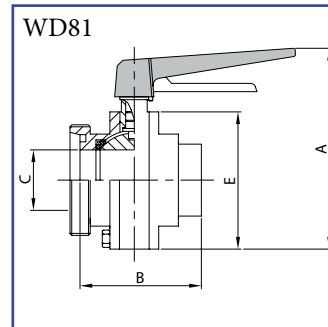

DN	A	B	C	E	Kg
40	138,0	73,0	37,0	81,0	1,75
50	155,0	78,0	49,0	98,0	2,75
65	187,0	109,0	66,0	130,0	5,00
80	204,0	117,5	81,0	147,0	5,80

DIN

Sanitary ball valve
welding ends
AISI 316L

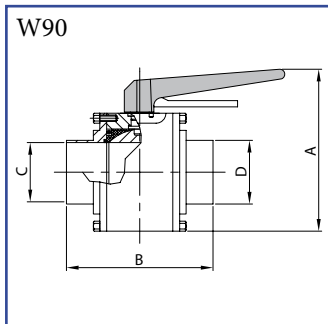

DN	A	B	C	D	Kg
28	110,0	96,0	25,0	28,0	1,13
34	130,0	109,0	31,0	34,0	2,07
40	130,0	109,0	37,0	40,0	2,07
52	145,0	124,0	49,0	52,0	2,80
70	168,0	135,0	66,0	70,0	4,84
85	182,0	158,0	81,0	85,0	7,48

Sanitary ball valve
male threads DIN 11851
AISI 316L

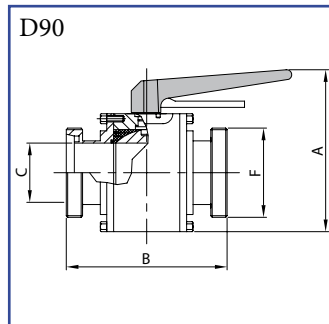

DN	A	B	C	F	Kg
25	110,0	88,0	25,0	52-6	1,33
32	130,0	103,0	31,0	58-6	2,37
40	130,0	103,0	37,0	65-6	2,37
50	145,0	116,0	49,0	78-6	3,10
65	168,0	134,0	66,0	95-6	5,44
80	182,0	153,0	81,0	110-4	8,08

Sanitary ball valve
male thread DIN / welding
AISI 316L

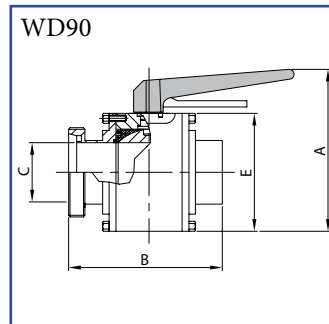

DN	A	B	C	E	Kg
25	110,0	91,5	25,0	60,0	1,23
32	130,0	106,0	31,0	80,0	2,22
40	130,0	106,0	37,0	80,0	2,22
50	145,0	120,0	49,0	95,0	2,95
65	168,0	134,5	66,0	118,0	5,14
80	182,0	155,5	81,0	132,0	7,78

Ball valve
welding ends
AISI 316L

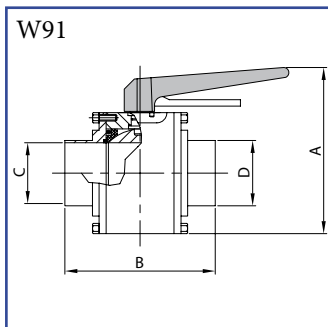

DN	A	B	C	D	Kg
28	110,0	96,0	25,0	28,0	1,12
34	130,0	109,0	31,0	34,0	2,06
40	130,0	109,0	37,0	40,0	2,06
52	145,0	124,0	49,0	52,0	2,78
70	168,0	135,0	66,0	70,0	4,82
85	182,0	158,0	81,0	85,0	7,45

Ball valve
male threads DIN 11851
AISI 316L

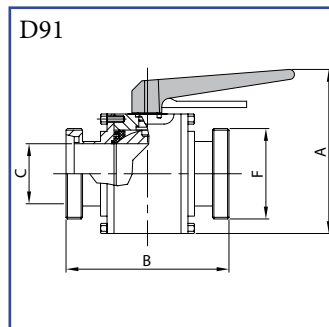

DN	A	B	C	F	Kg
25	110,0	88,0	25,0	52-6	1,32
32	130,0	103,0	31,0	58-6	2,36
40	130,0	103,0	37,0	65-6	2,36
50	145,0	116,0	49,0	78-6	3,08
65	168,0	134,0	66,0	95-6	5,42
80	182,0	153,0	81,0	110-4	8,05

Ball valve
male thread DIN / welding
AISI 316L

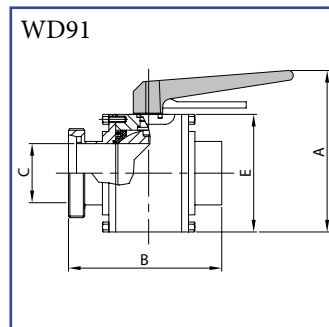

DN	A	B	C	E	Kg
25	110,0	91,5	25,0	60,0	1,22
32	130,0	106,0	31,0	80,0	2,21
40	130,0	106,0	37,0	80,0	2,21
50	145,0	120,0	49,0	95,0	2,93
65	168,0	134,5	66,0	118,0	5,12
80	182,0	155,5	81,0	132,0	7,75

SMS

Ball valve
welding ends
AISI 316L

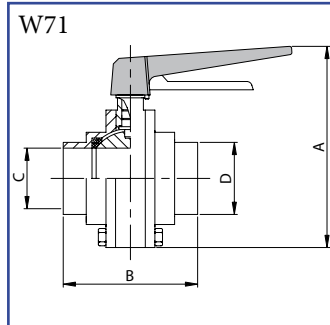

DN	A	B	C	D	Kg
38	138,0	73,0	35,1	38,1	1,60
51	155,0	80,0	47,8	50,8	2,60
63	176,0	97,0	60,5	63,5	4,00
76	190,0	109,0	72,9	76,2	5,00

Ball valve
male threads SMS
AISI 316L

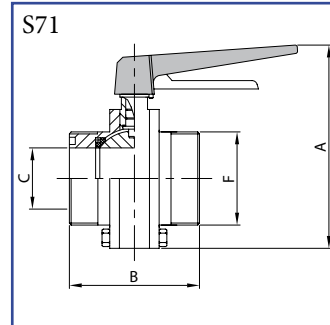

DN	A	B	C	F	Kg
38	138,0	87,0	35,1	60-6	1,90
51	155,0	90,0	47,8	70-6	2,90
63	176,0	105,0	60,5	85-6	4,60
76	190,0	121,0	72,9	98-6	5,60

Ball valve
male thread SMS / welding
AISI 316L

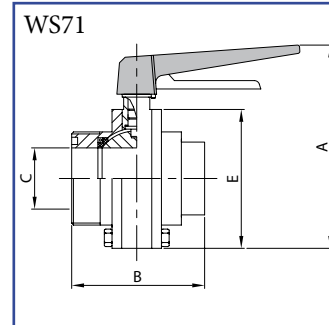

DN	A	B	C	E	Kg
38	138,0	80,0	35,1	81,0	1,75
51	155,0	85,0	47,8	98,0	2,75
63	176,0	101,0	60,5	119,0	4,30
76	190,0	115,0	72,9	133,0	5,30

Ball valve
welding ends
AISI 316L

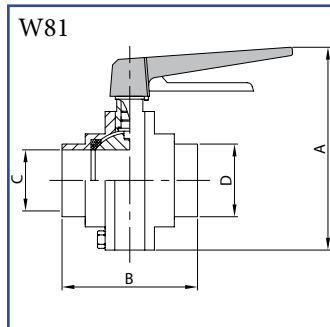

DN	A	B	C	D	Kg
38	138,0	73,0	35,1	38,1	1,60
51	155,0	80,0	47,8	50,8	2,60
63	176,0	97,0	60,5	63,5	4,00
76	190,0	109,0	72,9	76,2	5,00

Ball valve
male threads SMS
AISI 316L

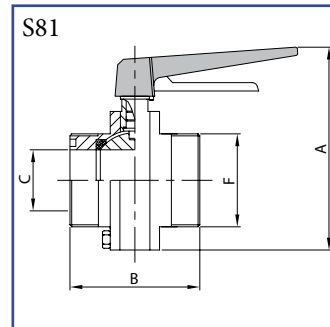

DN	A	B	C	F	Kg
38	138,0	87,0	35,1	60-6	1,90
51	155,0	90,0	47,8	70-6	2,90
63	176,0	105,0	60,5	85-6	4,60
76	190,0	121,0	72,9	98-6	5,60

Ball valve
male thread SMS / welding
AISI 316L

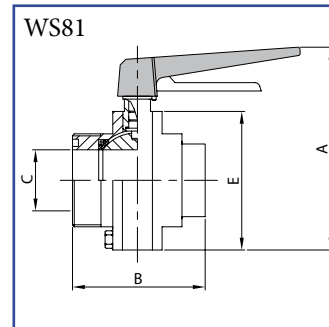

DN	A	B	C	E	Kg
38	138,0	80,0	35,1	81,0	1,75
51	155,0	85,0	47,8	98,0	2,75
63	176,0	101,0	60,5	119,0	4,30
76	190,0	115,0	72,9	133,0	5,30

SMS

Sanitary ball valve
welding ends
AISI 316L

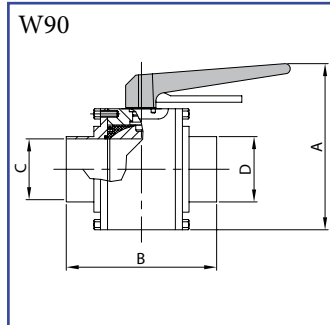

DN	A	B	C	D	Kg
25	110,0	96,0	22,1	25,4	1,13
38	130,0	109,0	34,8	38,1	2,07
51	145,0	124,0	47,5	50,8	2,80
63	168,0	135,0	60,2	63,5	4,84
76	182,0	158,0	72,0	76,2	7,48

Sanitary ball valve
male threads SMS
AISI 316L

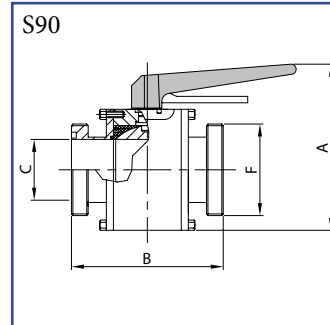

DN	A	B	C	F	Kg
25	110,0	96,0	22,1	40-6	1,33
38	130,0	120,0	34,8	60-6	2,37
51	145,0	134,0	47,5	70-6	3,10
63	168,0	156,0	60,2	85-6	5,44
76	182,0	167,0	72,0	98-6	8,08

Sanitary ball valve
male thread SMS / welding
AISI 316L

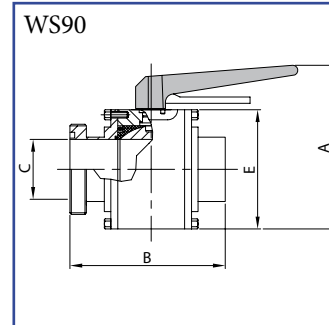

DN	A	B	C	E	Kg
25	110,0	96,0	22,1	60,0	1,23
38	130,0	114,5	34,8	80,0	2,22
51	145,0	129,0	47,5	95,0	2,95
63	168,0	145,5	60,2	118,0	5,14
76	182,0	162,5	72,0	132,0	7,78

Ball valve
welding ends
AISI 316L

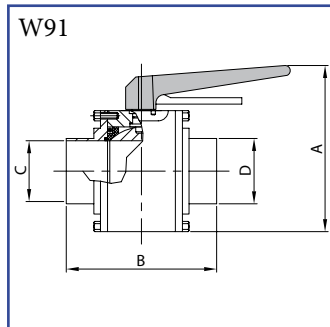

DN	A	B	C	D	Kg
25	110,0	96,0	22,1	25,4	1,12
38	130,0	109,0	34,8	38,1	2,06
51	145,0	124,0	47,5	50,8	2,78
63	168,0	135,0	60,2	63,5	4,82
76	182,0	158,0	72,0	76,2	7,45

Ball valve
male threads SMS
AISI 316L

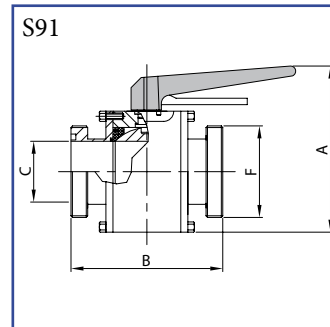

DN	A	B	C	F	Kg
25	110,0	96,0	22,1	40-6	1,32
38	130,0	120,0	34,8	60-6	2,36
51	145,0	134,0	47,5	70-6	3,08
63	168,0	156,0	60,2	85-6	5,42
76	182,0	167,0	72,0	98-6	8,05

Ball valve
male thread SMS / welding
AISI 316L

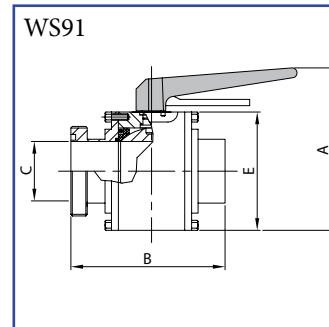

DN	A	B	C	E	Kg
25	110,0	96,0	22,1	60,0	1,22
38	130,0	114,5	34,8	80,0	2,21
51	145,0	129,0	47,5	95,0	2,93
63	168,0	145,5	60,2	118,0	5,12
76	182,0	162,5	72,0	132,0	7,75

CLAMP

Sanitary ball valve
welding ends
AISI 316L

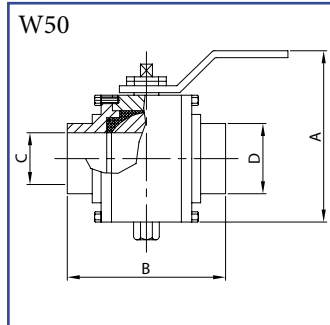

DN	A	B	C	D	Kg	
1"	25	90,0	95,0	22,1	25,4	1,10
1 1/2"	38	110,0	107,0	34,8	38,1	2,09
2"	51	126,0	118,0	47,5	50,8	3,14
2 1/2"	63	143,0	135,0	60,2	63,5	4,73
3"	76	163,0	158,0	72,0	76,2	6,94
4"	101	202,0	170,0	97,4	101,6	13,57

Sanitary ball valve
CLAMP ends
AISI 316L

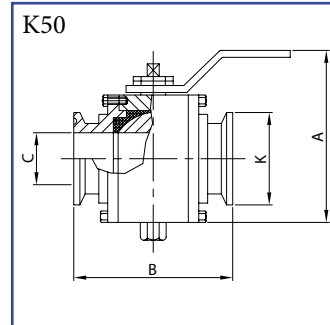

DN	A	B	C	K	Kg	
1"	25	90,0	95,0	22,1	50,5	1,12
1 1/2"	38	110,0	107,0	34,8	50,5	2,12
2"	51	126,0	118,0	47,5	64,0	3,19
2 1/2"	63	143,0	135,0	60,2	77,5	4,79
3"	76	163,0	158,0	72,0	91,0	7,01
4"	101	202,0	170,0	97,4	119,0	13,67

Sanitary ball valve
CLAMP end / welding
AISI 316L

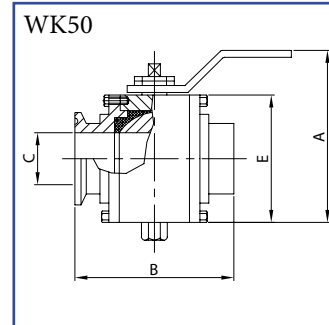

DN	A	B	C	E	Kg	
1"	25	90,0	95,0	22,1	58,0	1,11
1 1/2"	38	110,0	107,0	34,8	77,0	2,11
2"	51	126,0	118,0	47,5	93,0	3,17
2 1/2"	63	143,0	135,0	60,2	113,0	4,76
3"	76	163,0	158,0	72,0	129,0	6,98
4"	101	202,0	170,0	97,4	169,0	13,6

Ball valve
welding ends
AISI 316L

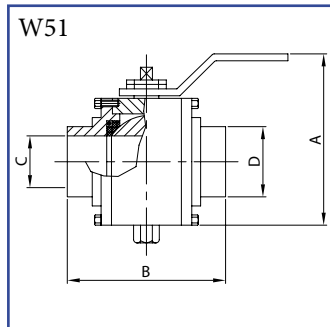

DN	A	B	C	D	Kg	
1"	25	90,0	95,0	22,1	25,4	1,09
1 1/2"	38	110,0	107,0	34,8	38,1	2,08
2"	51	126,0	118,0	47,5	50,8	3,12
2 1/2"	63	143,0	135,0	60,0	63,5	4,71
3"	76	163,0	158,0	72,0	76,2	6,91
4"	101	202,0	170,0	97,0	101,6	13,53

Ball valve
CLAMP ends
AISI 316L

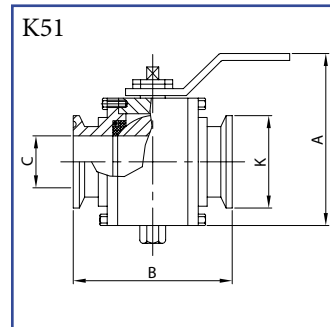

DN	A	B	C	K	Kg	
1"	25	90,0	95,0	22,1	50,5	1,11
1 1/2"	38	110,0	107,0	34,8	50,5	2,11
2"	51	126,0	118,0	47,5	64,0	3,17
2 1/2"	63	143,0	135,0	60,0	77,5	4,77
3"	76	163,0	158,0	72,0	91,0	6,98
4"	101	202,0	170,0	97,0	119,0	13,63

Ball valve
CLAMP end / welding
AISI 316L

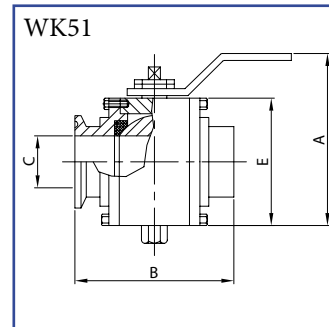

DN	A	B	C	E	Kg	
1"	25	90,0	95,0	22,1	58,0	1,11
1 1/2"	38	110,0	107,0	34,8	77,0	2,10
2"	51	126,0	118,0	47,5	93,0	3,15
2 1/2"	63	143,0	135,0	60,0	113,0	4,74
3"	76	163,0	158,0	72,0	129,0	6,95
4"	101	202,0	170,0	97,0	169,0	13,6

CLAMP

Ball valve
welding ends
AISI 316L

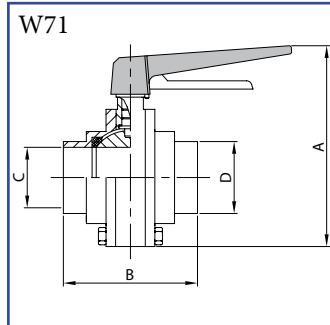

DN	A	B	C	D	Kg	
1 1/2"	38	138,0	73,0	35,1	38,1	1,60
2"	51	155,0	80,0	47,8	50,8	2,60
2 1/2"	63	176,0	97,0	60,5	63,5	4,00
3"	76	190,0	109,0	72,9	76,2	5,00

Ball valve
CLAMP ends
AISI 316L

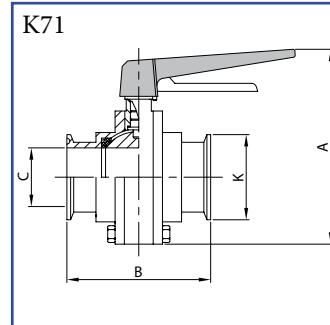

DN	A	B	C	K	Kg	
1 1/2"	38	138,0	87,0	35,1	50,5	1,63
2"	51	155,0	90,0	47,8	64,0	2,63
2 1/2"	63	176,0	105,0	60,5	77,5	4,04
3"	76	190,0	121,0	72,9	91,0	5,04

Ball valve
CLAMP end / welding
AISI 316L

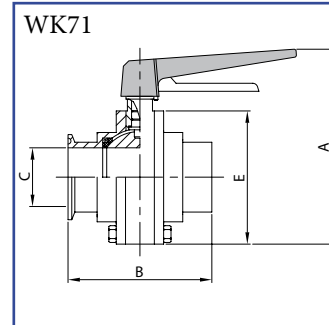

DN	A	B	C	E	Kg	
1 1/2"	38	138,0	80,0	35,1	81,0	1,62
2"	51	155,0	85,0	47,8	98,0	2,62
2 1/2"	63	176,0	101,0	60,5	119,0	4,02
3"	76	190,0	115,0	72,9	133,0	5,02

Ball valve
welding ends
AISI 316L

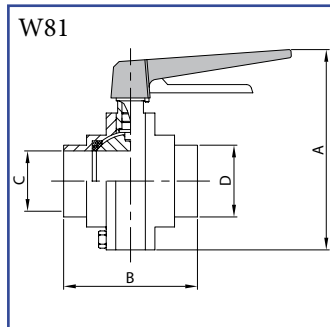

DN	A	B	C	D	Kg	
1 1/2"	38	138,0	73,0	35,1	38,1	1,60
2"	51	155,0	80,0	47,8	50,8	2,60
2 1/2"	63	176,0	97,0	60,5	63,5	4,00
3"	76	190,0	109,0	72,9	76,2	5,00

Ball valve
CLAMP ends
AISI 316L

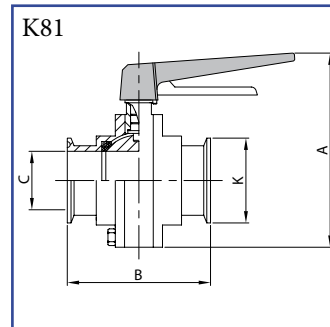

DN	A	B	C	K	Kg	
1 1/2"	38	138,0	87,0	35,1	50,5	1,63
2"	51	155,0	90,0	47,8	64,0	2,63
2 1/2"	63	176,0	105,0	60,5	77,5	4,04
3"	76	190,0	121,0	72,9	91,0	5,04

Ball valve
CLAMP end / welding
AISI 316L

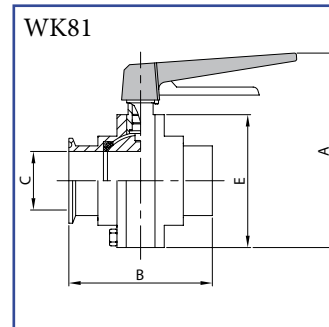

DN	A	B	C	E	Kg	
1 1/2"	38	138,0	80,0	35,1	81,0	1,62
2"	51	155,0	85,0	47,8	98,0	2,62
2 1/2"	63	176,0	101,0	60,5	119,0	4,02
3"	76	190,0	115,0	72,9	133,0	5,02

CLAMP

Sanitary ball valve
welding ends
AISI 316L

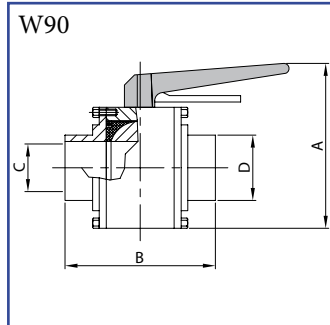

DN	A	B	C	D	Kg	
½"	12	100,0	74,5	9,4	12,7	0,76
¾"	19	100,0	74,5	15,7	19,0	0,76
1"	25	110,0	96,0	22,1	25,4	1,13
1 ½"	38	130,0	109,0	34,8	38,1	2,07
2"	51	145,0	124,0	47,5	50,8	2,80
2 ½"	63	168,0	135,0	60,2	63,5	4,84
3"	76	182,0	158,0	72,0	76,2	7,48

Sanitary ball valve
CLAMP ends
AISI 316L

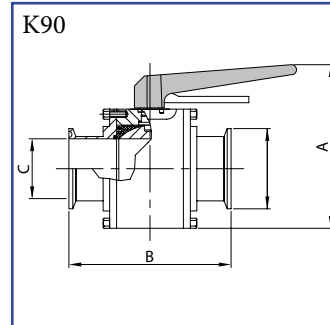

DN	A	B	C	K	Kg	
½"	12	100,0	80,5	9,4	25,0	0,78
¾"	19	100,0	80,5	15,7	25,0	0,78
1"	25	110,0	96,0	22,1	50,5	1,15
1 ½"	38	130,0	109,0	34,8	50,5	2,10
2"	51	145,0	124,0	47,5	64,0	2,85
2 ½"	63	168,0	135,0	50,2	77,5	4,90
3"	76	182,0	158,0	72,0	91,0	7,55

Sanitary ball valve
CLAMP end / welding
AISI 316L

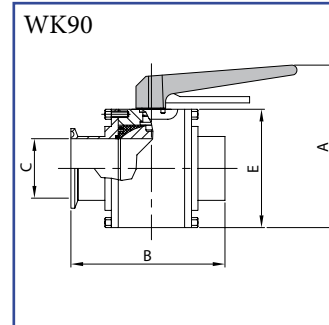

DN	A	B	C	E	Kg	
½"	12	100,0	77,5	9,4	55,0	0,77
¾"	19	100,0	77,5	15,7	55,0	0,77
1"	25	110,0	96,0	22,1	60,0	1,14
1 ½"	38	130,0	109,0	34,8	80,0	2,09
2"	51	145,0	124,0	47,5	95,0	2,83
2 ½"	63	168,0	135,0	60,2	118,0	4,87
3"	76	182,0	158,0	72,0	132,0	7,52

Ball valve
welding ends
AISI 316L

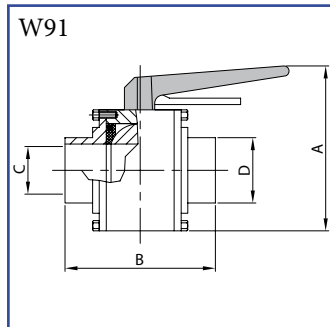

DN	A	B	C	D	Kg	
½"	12	100,0	74,5	9,4	12,7	0,75
¾"	19	100,0	74,5	15,7	19,0	0,75
1"	25	110,0	96,0	22,1	25,4	1,12
1 ½"	38	130,0	109,0	34,8	38,1	2,06
2"	51	145,0	124,0	47,5	50,8	2,78
2 ½"	63	168,0	135,0	60,2	63,5	4,82
3"	76	182,0	158,0	72,0	76,2	7,45

Ball valve
CLAMP ends
AISI 316L

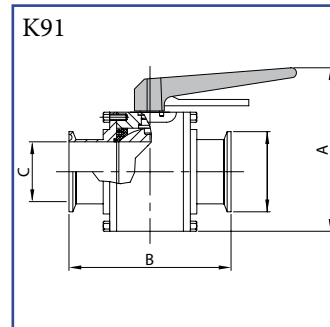

DN	A	B	C	K	Kg	
½"	12	100,0	80,5	9,4	25,0	0,77
¾"	19	100,0	80,5	15,7	25,0	0,77
1"	25	110,0	96,0	22,1	50,5	1,14
1 ½"	38	130,0	109,0	34,8	50,5	2,09
2"	51	145,0	124,0	47,5	64,0	2,83
2 ½"	63	168,0	135,0	60,2	77,5	4,88
3"	76	182,0	158,0	72,0	91,0	7,52

Ball valve
CLAMP end / welding
AISI 316L

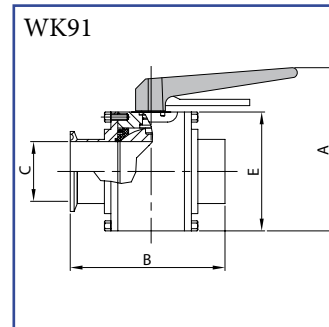

DN	A	B	C	E	Kg	
½"	12	100,0	77,5	9,4	55,0	0,76
¾"	19	100,0	77,5	15,7	55,0	0,76
1"	25	110,0	96,0	22,1	60,0	1,13
1 ½"	38	130,0	109,0	34,8	80,0	2,08
2"	51	145,0	124,0	47,5	95,0	2,81
2 ½"	63	168,0	135,0	60,2	118,0	4,85
3"	76	182,0	158,0	72,0	132,0	7,49

005V



005V - 3-PART STAINLESS STEEL BALL VALVE FULL BORE, WELDING (BW)

Application:

- Closing fitting for aggressive and non-aggressive liquids, gases and loose goods mainly for food and chemical industry.

- Acceptable also to prevent contamination of working medium with corrosion impurities.

Technical details:

- Valve has soft seal and floating ball.
- Stem packing made of PTFE, in case of wear possible tighten.
- Three-part construction allows valve repair without disassembly out of pipeline.
- On request with flange (ISO 5211) and pneumatic or electric actuator
- Construction lengths are shorter than ČSN or DIN
- Working temperature: -20 °C až +180 °C
- Nominal pressure: up to DN 2" - PN 63, from DN 2 1/2" - PN 40

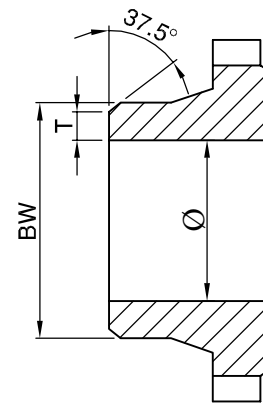
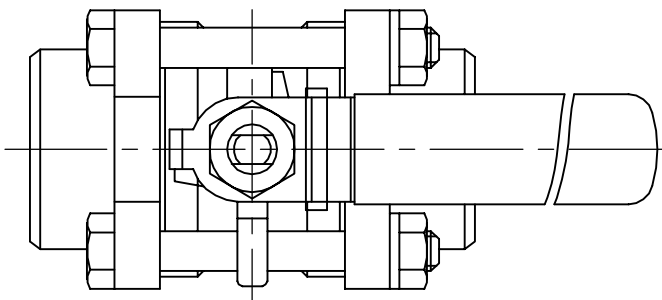

1/2" - 4"

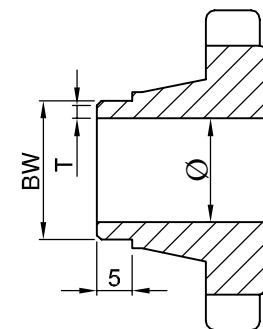

1/4" - 3/8"

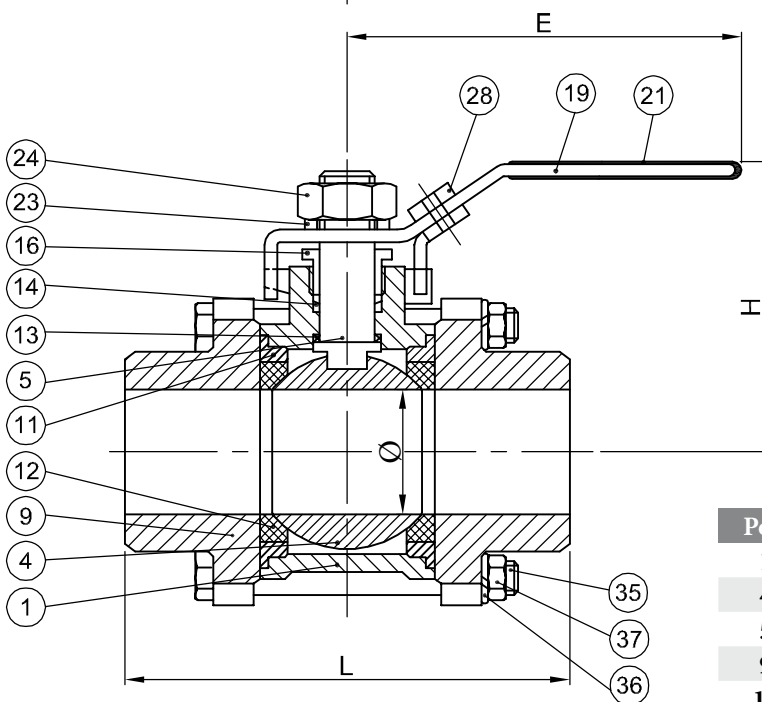

DN	Ø	L	E	H	BW	T
1/4"	11,6	70,0	102,0	54,0	16,2	1,6
3/8"	12,7	70,0	102,0	54,0	17,5	1,6
1/2"	15,0	75,0	130,0	64,0	22,7	1,6
3/4"	20,0	90,0	130,0	67,0	27,8	1,6
1"	25,0	100,0	160,0	75,0	35,0	1,6
1 1/4"	32,0	110,0	160,0	80,0	43,7	1,6
1 1/2"	38,0	125,0	185,0	90,0	49,6	1,6
2"	50,0	150,0	185,0	98,0	61,5	1,6
2 1/2"	65,0	190,0	260,0	137,0	77,3	2,0
3"	80,0	220,0	260,0	147,0	90,0	2,0
4"	100,0	270,0	290,0	175,0	116,0	3,5

Pos.	Designation	Material	Q'ty
1	Body	EN1503-1/1.4408	1
4	Ball	ASTM A351 GR.CF8M	1
5	Stem	AISI 316	1
9	End cap	EN1503-1/1.4408	2
11	Body seal	PTFE	2
12	Seat	PTFE	2
13	Thrust washer	PTFE	1
14	Stem packing	PTFE	1 set
16	Gland nut	AISI 304	1
19	Handle	AISI 304	1
21	Handle cover	Plastic	1
23	Handle washer	AISI 304	1
24	Handle nut	AISI 304	1
28	Locking pad	AISI 304	1
35	Bolt	AISI 304	4~6
36	Bolt washer	AISI 304	4~12
37	Bolt nut	AISI 304	4~12

009V



009V - 2-PART STAINLESS STEEL BALL VALVE WITH FULL BORE, THREADED F/F

Application:

- Closing fitting for aggressive and non-aggressive liquids, gases and loose goods mainly for food and chemical industry.
- Acceptable also to prevent contamination of working medium with corrosion impurities.

Technical details:

- Valve has soft seat and floating ball.
- Stem packing made of PTFE, in case of wear possible tighten.
- On request with flange (ISO 5211) and pneumatic or electric actuator
- Construction lengths are shorter than ČSN or DIN
- Working temperature: from -20 °C to +180 °C
- Nominal pressure: up to DN 2" - PN 63, from DN 2 1/2" - PN 40

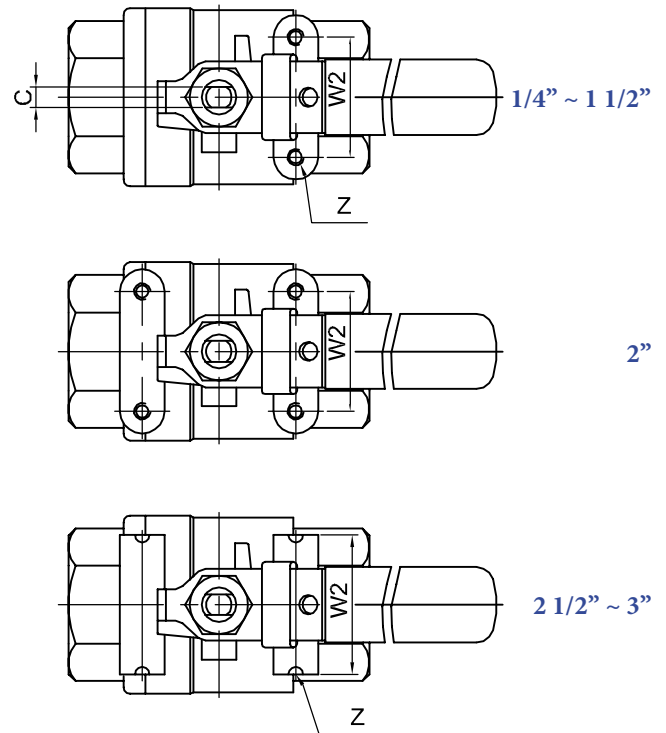
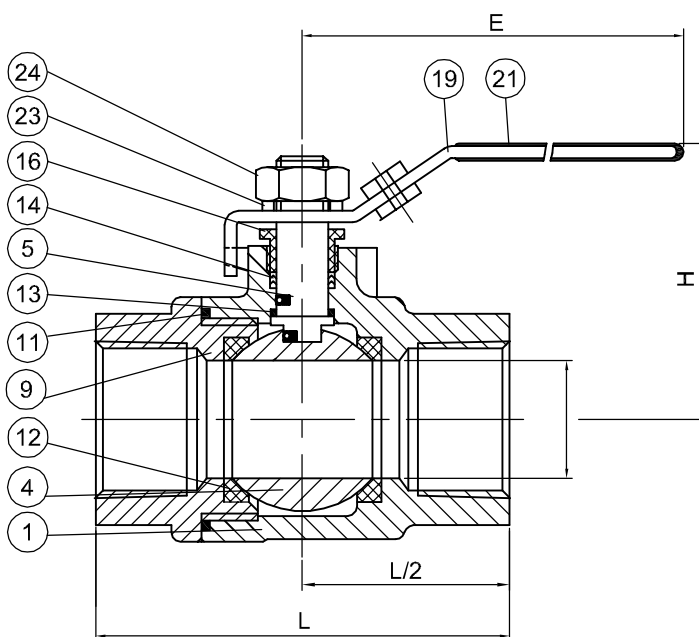

Pos.	Designation	Material	Q'ty
1	Body	EN1503-1/1.4408	1
4	Ball	EN1503-2/CF8M	1
5	Stem	AISI 316	1
9	End cap	EN1503-1/1.4408	1
11	Body seal	PTFE	1
12	Seat	PTFE	2
13	Trust washer	PTFE	1
14	Stem packing	PTFE	1 set
16	Gland nut	AISI 304	1
19	Handle	AISI 304	1
21	Handle cover	Plastic	1
23	Handle washer	AISI 304	1
24	Handle nut	AISI 304	1
28	Locking pad	AISI 304	1

DN	Ø	L	E	H	C	W2	Z	Kg	Torque (Nm)
1/4"	11,6	55,0	100,0	50,0	5,1	28,5	10-24 UNC	0,27	4,0
3/8"	12,7	55,0	100,0	50,0	5,1	28,5	10-24 UNC	0,25	4,0
1/2"	15,0	65,0	130,0	60,0	6,6	28,5	10-24 UNC	0,40	5,0
3/4"	20,0	74,0	130,0	64,0	6,6	35,0	10-24 UNC	0,54	7,0
1"	25,0	88,0	165,0	71,0	8,1	35,0	10-24 UNC	0,94	10,0
1 1/4"	32,0	102,0	165,0	78,0	8,1	38,1	1/4"-20 UNC	1,34	14,0
1 1/2"	38,0	110,0	190,0	86,0	9,7	38,1	1/4"-20 UNC	1,96	21,0
2"	50,0	125,0	190,0	95,0	9,7	38,1	1/4"-20 UNC	3,03	26,0
2 1/2"	65,0	161,5	250,0	130,0	11,9	61,0	1/4"-20 UNC	6,59	45,0
3"	80,0	178,0	250,0	148,0	11,9	71,0	1/4"-20 UNC	9,28	70,0

1-part ball valve with reducing bore
threaded F/F (ISO 228-1G)
mat. AISI 316 (CF8M), seats PTFE
DN 8-50 PN 40

V101

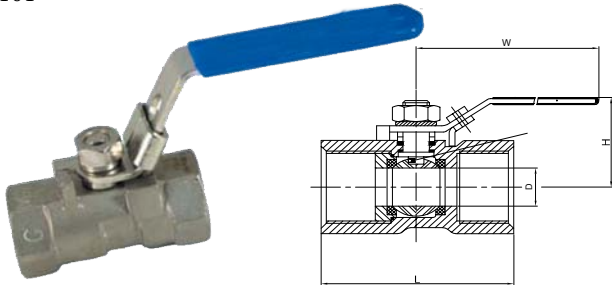

DN	D	L	W	H	Kg	
8	1/4"	5	40	70	32	0,07
10	3/8"	6,8	44,5	74	38	0,1
15	1/2"	9,2	57	90	43,5	0,16
20	3/4"	12,5	59,5	90	46	0,25
25	1"	16	72	122	51	0,43
32	1 1/4"	20	78,8	122	54	0,7
40	1 1/2"	24,5	84,5	155	58	0,83
50	2"	32	101,8	155	62	1,5

1-part ball valve with reducing bore
threaded F/F (ISO 228-1G)
mat. AISI 316 (CF8M), seats PTFE
DN 8-50 PN 40

V103

V103N (NPT threaded)

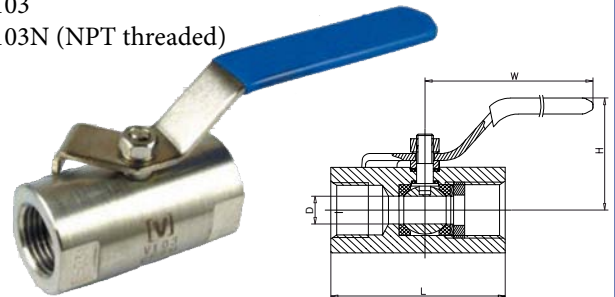

DN	D	L	W	H	Kg	
8	1/4"	5	48	77	30	0,33
10	3/8"	8	51,6	92	35	0,33
15	1/2"	10,5	60	95	37	0,33
20	3/4"	12,5	67,4	100	42	0,43
25	1"	16	72,5	103	46	0,63
32	1 1/4"	22	89	125	60	1,04
40	1 1/2"	25	96	150	62	1,64
50	2"	32	108	150	70	2,24

2-part ball valve - full bore
threaded F/F (ISO 228-1G)
mat. AISI 316 (CF8M), seats PTFE
DN 8-50 PN 63
DN 65-100 PN 40

V201

V201N (NPT threaded)

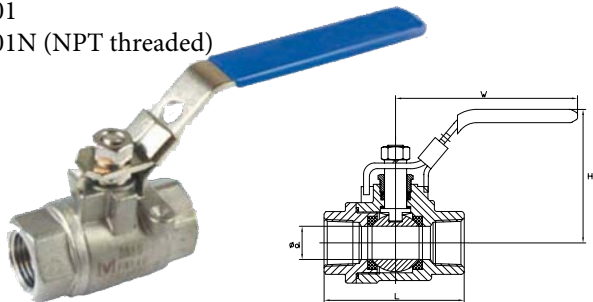

DN	D	L	W	H	Kg	
8	1/4"	11,6	54,5	100	54	0,23
10	3/8"	12,5	54,5	100	54	0,23
15	1/2"	15	63	130	61	0,38
20	3/4"	20	74,6	130	67,5	0,52
25	1"	25	88	165	75	0,92
32	1 1/4"	32	102	165	79	1,32
40	1 1/2"	38	110	190	84,5	1,9
50	2"	50	123,2	190	96	3,12
65	2 1/2"	65	163,5	250	126	6,5
80	3"	80	189	250	135,5	9,3
100	4"	100	228	367	157	-

2-part ball valve - full bore
threaded F/F (ISO 228-1G)
mat. AISI 316 (CF8M), seats PTFE
DN 8-25 PN 140
DN 32-50 PN 100

V201H

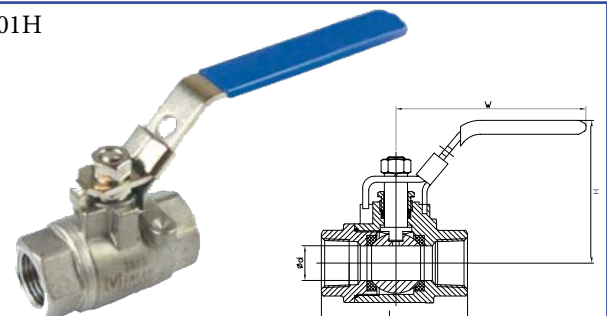

DN	D	L	W	H	Kg	
8	1/4"	10,86	62,5	100	58	0,3
10	3/8"	12,5	62,5	100	60	0,3
15	1/2"	15	62,5	130	60	0,5
20	3/4"	20	77,5	130	60	0,6
25	1"	25	90	165	77	1
32	1 1/4"	32	100	165	79	1,4
40	1 1/2"	38	118	190	92	2
50	2"	50	137,5	190	105	3,2

2-part ball valve - full bore
 threaded M/F (threads ISO 7-1R / ISO 228-1G)
 mat. AISI 316 (CF8M), seats PTFE
 DN 8-50 PN 63

V211T

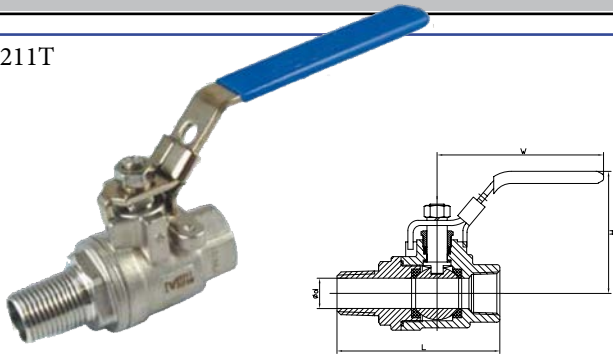

DN	D	L	W	H	Kg	
8	1/4"	7	71	100	54	0,25
10	3/8"	10	76	100	54	0,25
15	1/2"	15	84	130	61	0,40
20	3/4"	20	94	130	67,5	0,55
25	1"	25	103	165	75	1,00
32	1 1/4"	32	121	165	79	1,4
40	1 1/2"	38	135	190	84,5	2,0
50	2"	50	146	190	96	3,2

2-part ball valve full bore with ISO flange for actuator
 threaded F/F (ISO 228-1G)
 mat. AISI 316 (CF8M), seats PTFE
 DN 8-50 PN 63

V202

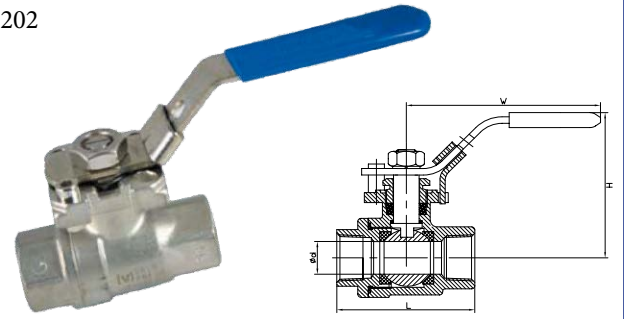

DN	D	L	W	H	ISO 5211	Kg	
8	1/4"	10	55	105	67	F03-F04	0,3
10	3/8"	12,5	60	105	67	F03-F04	0,3
15	1/2"	15	75	120	70	F03-F04	0,4
20	3/4"	20	80	120	75	F03-F04	0,6
25	1"	25	90	165	78,5	F04-F05	1
32	1 1/4"	32	110	165	84	F04-F05	1,4
40	1 1/2"	38	120	190	116	F05-F07	2
50	2"	48	140	190	125	F05-F07	3,2

3-part ball valve - full bore
 butt welded ends (BW) acc. to ANSI B16.25
 mat. AISI 316 (CF8M), seats PTFE
 DN 8-50 PN 63
 DN 65-100 PN 40

V301BW

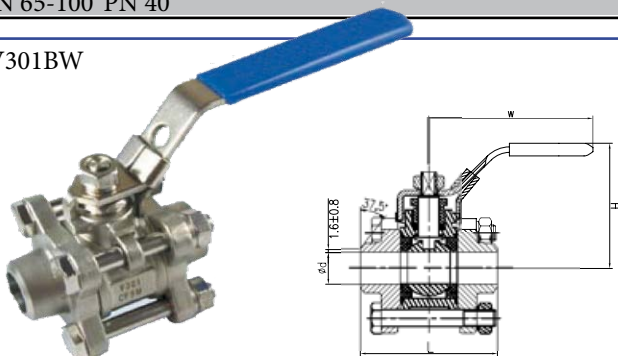

DN	D	L	W	H	Kg	
8	1/4"	11,6	67	100	54	0,35
10	3/8"	12,5	68	100	54	0,35
15	1/2"	15	73	130	58,5	0,56
20	3/4"	20	76,2	130	65,5	0,75
25	1"	25	94,4	165	74	1,04
32	1 1/4"	32	109,5	165	90	1,74
40	1 1/2"	38	123,5	190	96	2,41
50	2"	50	145	190	104,7	3,66
65	2 1/2"	65	194	250	122	7,1
80	3"	80	217	250	128	10,5
100	4"	100	268	367	156	19,5

3-part ball valve - full bore
 threaded F/F (ISO 228-1G)
 mat. AISI 316 (CF8M), seats PTFE
 DN 8-50 PN 63
 DN 65-100 PN 40

V301T

V301N (NPT threaded)

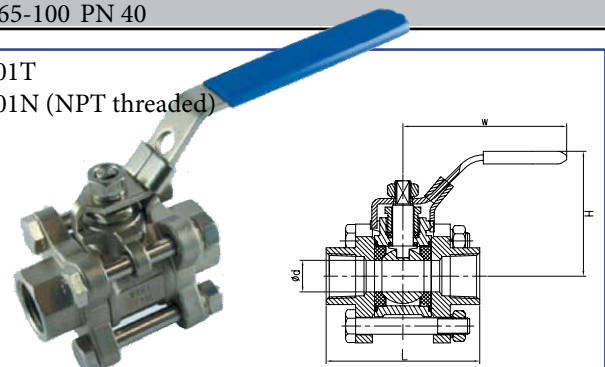

DN	D	L	W	H	Kg	
8	1/4"	11,6	67	100	54	0,35
10	3/8"	12,5	67	100	54	0,35
15	1/2"	15	73	130	58,5	0,56
20	3/4"	20	82,5	130	65,5	0,75
25	1"	25	88	165	74	1,04
32	1 1/4"	32	111	165	90	1,74
40	1 1/2"	38	120	190	96	2,41
50	2"	50	143,5	190	104,7	3,66
65	2 1/2"	65	172,6	250	122	7,1
80	3"	80	203	250	128	10,5
100	4"	100	241	367	156	19,5

3-part ball valve full bore with ISO flange for actuator
 butt welded ends (BW) acc. to ANSI B16.25
 mat. AISI 316 (CF8M), seats PTFE
 DN 8-50 PN 63
 DN 65-100 PN 40

V306BW

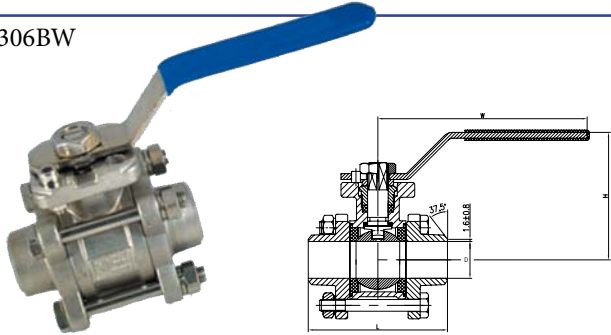

DN	D	L	W	H	ISO 5211	Kg	
8	1/4"	10,86	67	100	60	F03-F04	0,4
10	3/8"	12,5	67	100	60	F03-F04	0,4
15	1/2"	15	73,5	130	60	F03-F04	0,6
20	3/4"	20	75,8	150	65	F03-F04	0,8
25	1"	25	94,4	165	80,5	F04-F05	1,1
32	1 1/4"	32	109,5	165	86,5	F04-F05	1,8
40	1 1/2"	40	123,5	190	98,6	F05-F07	2,5
50	2"	50	146,6	190	111,9	F05-F07	3,7
65	2 1/2"	65	194	250	138	F07-F10	7,2
80	3"	80	218,5	250	147,5	F07-F10	11
100	4"	100	268	367	168,5	F10	20

3-part ball valve full bore with ISO flange for actuator
 threaded F/F (ISO 228-1G)
 mat. AISI 316 (CF8M), seats PTFE
 DN 8-25 PN 63
 DN 32-50 PN 40

V306T
 V306N (NPT threaded)

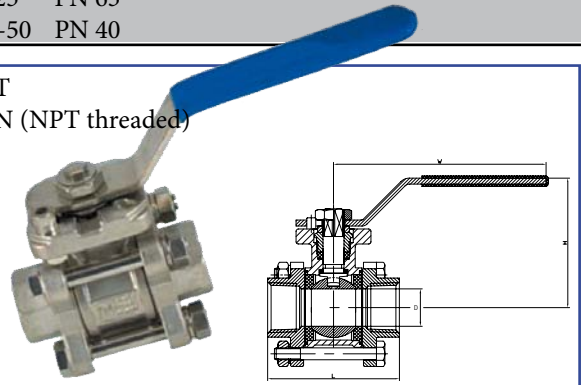

DN	D	L	W	H	ISO 5211	Kg	
8	1/4"	10,86	67	100	60	F03-F04	0,4
10	3/8"	12,5	67	100	60	F03-F04	0,4
15	1/2"	15	72	130	60	F03-F04	0,6
20	3/4"	20	82	130	65	F03-F04	0,8
25	1"	25	88	165	80,5	F04-F05	1,1
32	1 1/4"	32	112	165	86,5	F04-F05	1,8
40	1 1/2"	40	119	190	98,6	F05-F07	2,5
50	2"	50	140,6	190	111,9	F05-F07	3,7
65	2 1/2"	65	173	250	138	F07-F10	7,2
80	3"	80	204,5	250	147,5	F07-F10	11
100	4"	100	266	367	168,5	F10	20

3-way ball valve with reducing bore
 threaded F/F/F (ISO 228-1G)
 mat. AISI 316 (CF8M), seats PTFE
 DN 8-50 PN 63
 ball type "L"

V203L

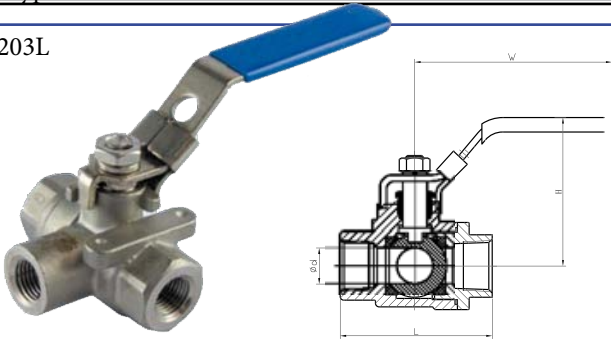

DN	D	L	W	H	Kg	
8	1/4"	9,4	59	100	45	0,4
10	3/8"	9,4	59	100	45	0,4
15	1/2"	12,7	59	130	58	0,4
20	3/4"	17,3	76	130	60	0,4
25	1"	20	82	165	77	0,7
32	1 1/4"	25	102	165	79	0,9
40	1 1/2"	32	112	190	92	2,2
50	2"	38	138	190	105	3,3

3-way ball valve with reducing bore
 threaded F/F/F (ISO 228-1G)
 mat. AISI 316 (CF8M), seats PTFE
 DN 8-50 PN 63
 ball type "T"

V203T

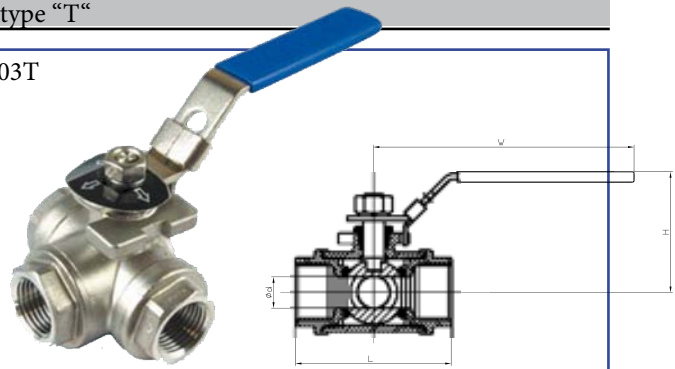

DN	D	L	W	H	Kg	
8	1/4"	8	65	100	49	0,4
10	3/8"	8	65	100	49	0,4
15	1/2"	10	71,4	110	58	0,4
20	3/4"	15	82,8	120	65	0,4
25	1"	18	89,6	150	70	0,7
32	1 1/4"	24	122	150	78	0,9
40	1 1/2"	32	138,2	180	86	2,2
50	2"	38	151,6	180	96	3,3

2-part flanged ball valve - full bore
flanges acc. to ANSI B16.5
mat. AISI 316 (CF8M), seats PTFE
DN 15-150 PN 150 lbs

V403M

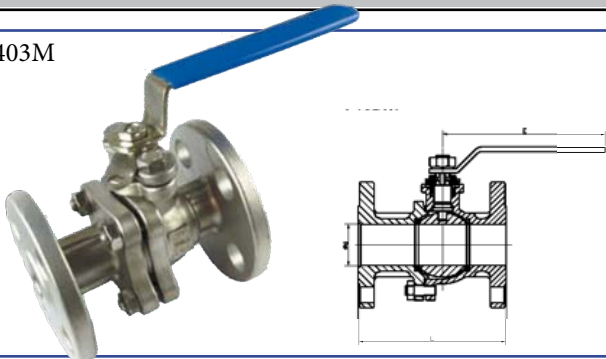

DN	D	L	E	Kg	
15	1/2"	15	108	130	2,7
20	3/4"	20	117	130	3,1
25	1"	25	127	160	4,3
32	1 1/4"	32	140	160	6,2
40	1 1/2"	40	165	200	8,1
50	2"	50	178	200	10
65	2 1/2"	65	190	329	14
80	3"	76	203	329	18,5
100	4"	100	229	329	26,6
125	5"	125	254	450	54
150	6"	150	394	752,5	71,3

2-part flanged ball valve - full bore
flanges acc. to EN 1092-1
mat. AISI 316 (CF8M), seats PTFE
DN 15-50 PN 40
DN 65-150 PN 16

V405M

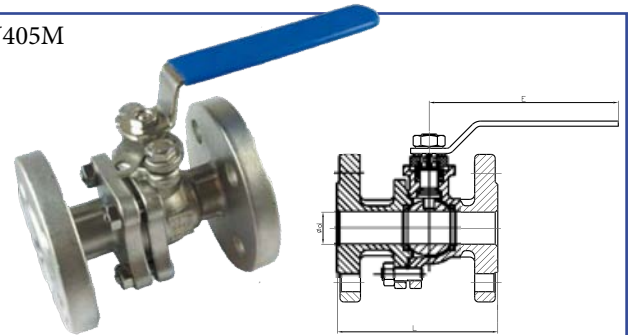

DN	D	L	E	Kg	
15	1/2"	15	115	130	2,7
20	3/4"	20	120	130	3,1
25	1"	25	125	160	4,3
32	1 1/4"	32	130	160	6,2
40	1 1/2"	40	140	200	8,1
50	2"	50	150	200	10
65	2 1/2"	65	170	329	14
80	3"	80	180	329	18,5
100	4"	100	190	329	26,6
125	5"	125	325	450	54
150	6"	150	350	752,5	71,3

3-part flanged ball valve - full bore
with ISO flange (for pneum. actuator)
flanges EN 1092-1
mat. AISI 316 (CF8M), seats PTFE
DN 15-50 PN 40

V404

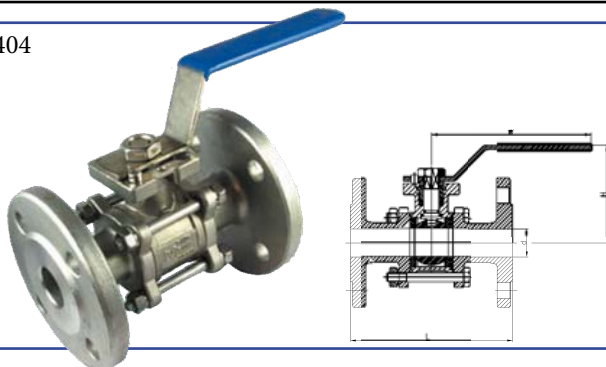

DN	D	L	W	H	ISO 5211	Kg	
15	1/2"	15	123	140	60	F03-F04	3
20	3/4"	20	146	140	65	F03-F04	3,3
25	1"	25	160	180	80,5	F04-F05	4,5
32	1 1/4"	32	184	180	86,5	F04-F05	6,5
40	1 1/2"	38	194	200	98,6	F05-F07	8,5
50	2"	50	232,6	230	111,9	F05-F07	10,5

Single acting pneumatic actuator GS
 Mounting flange acc. to DIN / ISO 5211 DIN 3337
 Namur connections for accessories
 Rotating angle 90°

POS



Ordering code	A	L	T	ISO 5211
POS-GD0015	233,3	79,2	59,2	F03-F04
POS-GD0030	259,0	90,4	70,4	F04-F05
POS-GD0053	303,7	103,3	83,3	F05-F07
POS-GD0090	393,7	137,5	107,0	F07-F10
POS-GD0120	409,6	141,1	111,1	F07-F10
POS-GD0180	467,4	148,0	118,0	F07-F10
POS-GD0240	520,5	164,9	134,9	F10-F12
POS-GD0480	648,2	198,0	168,0	F12-F14
POS-GD0960	828,0	237,7	207,7	F14-F16

Double acting pneumatic actuator GS
 Mounting flange acc. to DIN / ISO 5211 DIN 3337
 Namur connections for accessories
 Rotating angle 90°

POD



Ordering code	A	L	T	ISO 5211
POD-GD0015	159,0	72,2	52,2	F03-F04
POD-GD0030	174,0	79,2	59,2	F03-F04
POD-GD0060	198,0	90,4	70,4	F04-F05
POD-GD0106	236,5	103,3	83,3	F05-F07
POD-GD0180	289,9	137,5	107,0	F07-F10
POD-GD0240	313,6	141,1	111,1	F07-F10
POD-GD0360	339,3	148,0	118,0	F07-F10
POD-GD0480	387,7	164,9	134,9	F07-F12
POD-GD0960	479,4	198,0	168,0	F12-F14
POD-GD1920	601,0	237,7	207,7	F14-F16



- Made of stainless steel drop forged or steel full bar AISI 304 or AISI 316 with full ball stainless steel with teflon hermetic seal (PTFE pure)
- O-rings NBR / VITON / EPDM
- Finish: mirror polished
- Standard version with handle
- On request with pneumatic actuator (single / double acting)
- Don't use these valves in hazardous area
- Don't use these valves partially opened - this kind of use may cause permanent damages of hermetic seal

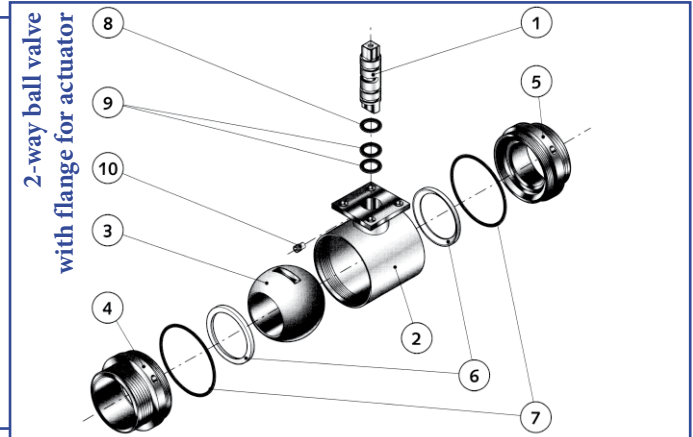
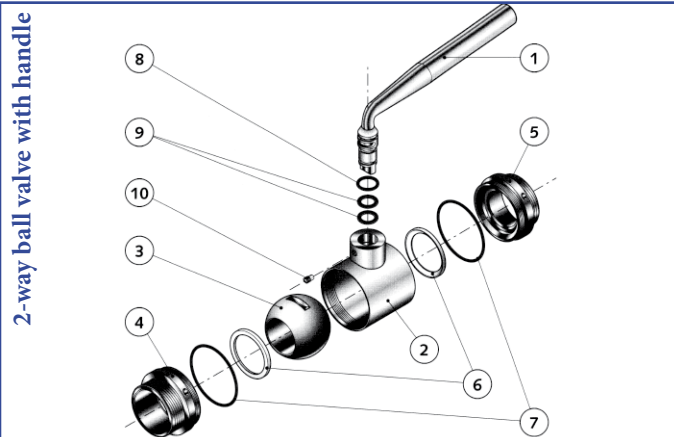

Pozice	Název	Počet	Materiál
1	Handle / stem	1	AISI 304 / 316
2	Body	1	AISI 304 / 316
3	Ball	1	AISI 304 / 316
4	Inlet head	1	AISI 304 / 316
5	Outlet head	1	AISI 304 / 316
6	Hermetic seals	2	PTFE (teflon)
7	OR seal ring	2	NBR - VITON - EPDM
8	OR seal ring	1	NBR - VITON - EPDM
9	OR seal ring	2-3	NBR - VITON - EPDM
10	Pin with thread	1	AISI 304

Pozice	Název	Počet	Materiál
1	Stem	1	AISI 304 / 316
2	Body	1	AISI 304 / 316
3	Ball	1	AISI 304 / 316
4	Head	3	AISI 304 / 316
5	Steam seals	1	PTFE (teflon)
6	Ball seals	3-4	PTFE (teflon)
7	Head seals	3	PTFE (teflon)
8	Stem seals	1	PTFE (teflon)
9	OR seal ring	1	FKM (Viton)
10	Register ring	1	AISI 304 (303)
11	Nut	1	AISI 304
12	Washer	1	AISI 304
13	Lever	1	AISI 304
14	Handle	1	Plastic

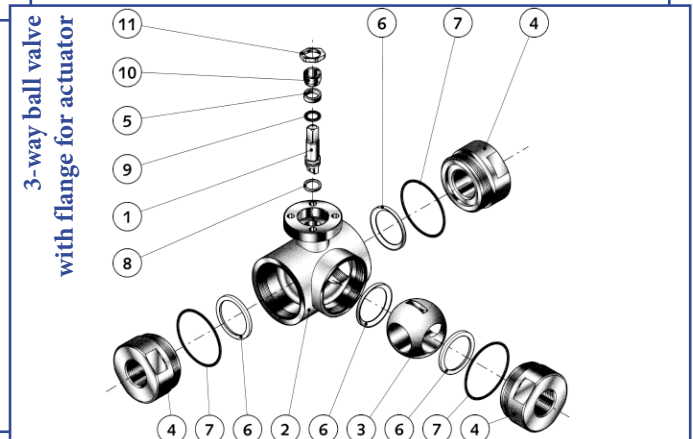
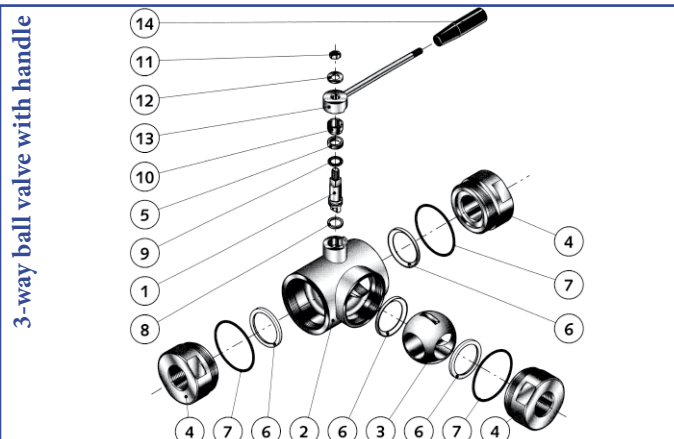

2-way ball valve
welding ends
AISI 304 / AISI 316

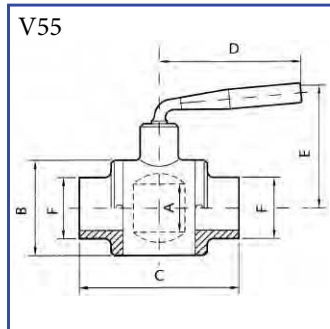

DN	F	A	B	C	D	E	Kg
10	12	10	28	70	75	58	0,3
15	18	15	35	70	82	67	0,4
20	22	20	40	65	82	70	0,5
25	28	25	50	90	98	75	0,8
32	35	32	62	104	120	101	1,5
40	40	36	62	104	128	101	1,55
50	52	45	78	115	153	120	2,5
50	54	50	90	133	153	125	2,2
60	62	57	100	138	153	130	4,2
65	70	66	114	165	190	158	6,2
80	85	76	133	184	248	193	9,3
100	104	98,5	160	197	248	230	13,3

2-way ball valve
welding / male end DIN 11851
AISI 304 / AISI 316

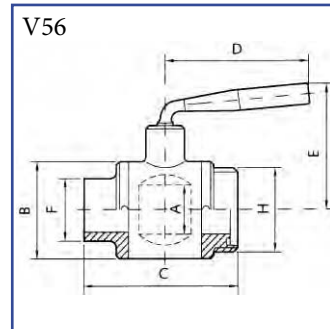

DN	H	F	A	B	C	D	E	Kg
10	28	13	10	28	70	75	58	0,3
15	34	18	15	35	70	82	67	0,4
20	44	23	20	40	65	82	70	0,5
25	52	28	25	50	92	98	75	0,9
32	58	35	32	62	104	120	101	1,3
40	65	40	36	62	104	120	101	1,4
50	78	52	45	78	115	153	120	2,5
50	78	54	50	90	133	153	125	3,4
60	85	62	57	100	138	153	130	4,0
65	95	70	66	114	165	190	158	6,6
80	110	85	76	133	184	248	193	9,6
100	130	104	98,5	160	197,5	248	230	14,0

2-way ball valve
nut / male end DIN 11851
AISI 304 / AISI 316

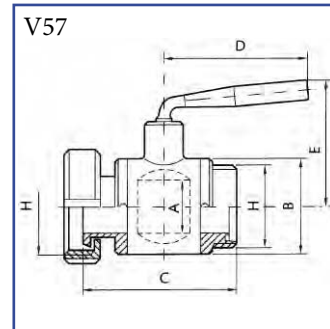

DN	H	A	B	C	D	E	Kg
10	28	10	28	70	75	58	0,3
15	34	15	35	75	82	67	0,4
20	44	20	40	70	82	70	0,5
25	52	25	50	87	98	75	1,1
32	58	32	62	105	120	101	1,6
40	65	36	62	105	120	101	1,75
50	78	45	78	115	153	120	3,0
50	78	50	90	135	153	125	3,9
60	85	57	100	138	153	130	4,6
65	95	66	114	168	190	158	7,4
80	110	76	133	188	248	193	10,7
100	130	98,5	160	200	248	230	15,5

2-way ball valve
male ends DIN 11851
AISI 304 / AISI 316

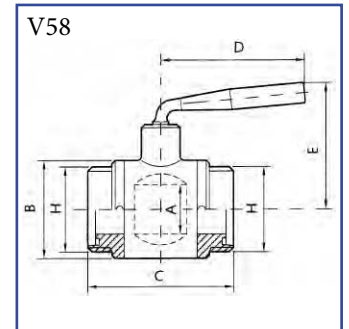

DN	H	A	B	C	D	E	Kg
10	28	10	28	70	75	58	0,3
15	34	15	35	72	82	67	0,4
20	44	20	40	65	82	70	0,55
25	52	25	50	96	98	75	1,1
32	58	32	62	104	120	101	1,6
40	65	36	62	104	120	101	1,7
50	78	45	78	115	153	120	2,8
50	78	50	90	133	153	125	3,8
60	85	57	100	138	153	130	4,4
65	95	66	114	165	190	158	7,0
80	110	76	133	184	248	193	10,2
100	130	98,5	160	198	248	230	15,0

2-way ball valve
CLAMP ends
AISI 304 / AISI 316

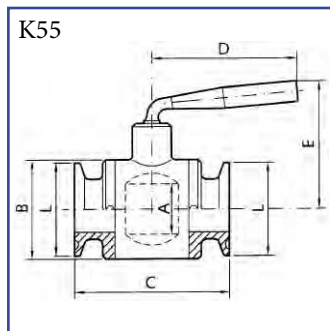

DN	L	A	B	C	D	E	Kg
10	34	10	28	95,4	75	58	0,3
15	34	15	35	95,4	82	67	0,4
20	34	20	40	90,4	82	70	0,5
25	50,5	25	50	115,4	98	75	0,8
32	50,5	32	62	129,4	120	101	1,5
40	50,5	36	62	129,4	128	101	1,55
50	64	50	90	158,4	153	125	2,2
65	91	66	114	196,6	190	158	6,2
80	106	76	133	215,6	248	193	9,3
100	119	98,5	160	228,6	248	230	13,3

2-way ball valve
for welding / ferrule CLAMP
AISI 304 / AISI 316

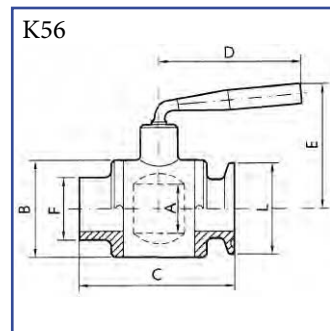

DN	F	L	A	B	C	D	E	Kg
10	12	34	10	28	82,7	75	58	0,3
15	18	34	15	35	82,7	82	67	0,4
20	22	34	20	40	77,7	82	70	0,5
25	28	50,5	25	50	102,7	98	75	0,8
32	35	50,5	32	62	116,7	120	101	1,5
40	40	50,5	36	62	116,7	128	101	1,55
50	54	64	50	90	145,7	153	125	2,2
65	70	91	66	114	177,7	190	158	6,2
80	85	106	76	133	196,7	248	193	9,3
100	104	119	98,5	160	209,7	248	230	13,3

3-way ball valve
male ends DIN 11851
ball type "L" - AISI 304 or 316

3-way ball valve
male ends DIN 11851
ball type "T" - AISI 304 or 316

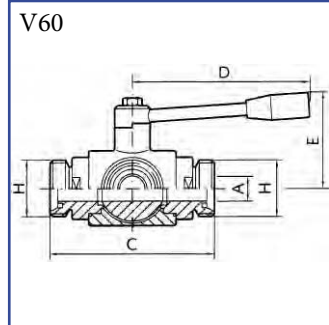
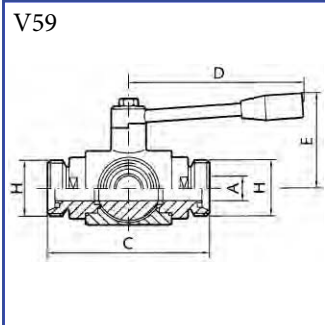

DN	PN	H	A	C	D	E	Kg
10	40	28	10	108	110	60	1,1
15	40	34	15	118	110	65	1,45
20	40	44	20	130	160	70	2,3
25	04	52	25	140	160	80	3,0
32	40	58	32	156	190	95	5,15
40	40	65	40	172	190	110	7,55
50	25	78	50	182	235	120	9,2
65	25	95	65	196	285	130	11,3
80	16	110	80	256	310	145	23,0
100	16	130	100	286	310	160	34,0
125	6	160	120	326	350	180	47,0

DN	PN	H	A	C	D	E	Kg
10	40	28	10	108	110	60	1,1
15	40	34	15	118	110	65	1,45
20	40	44	20	130	160	70	2,3
25	40	52	25	140	160	80	3,0
32	40	58	32	156	190	95	5,15
40	40	65	40	172	190	110	7,55
50	25	78	50	182	235	120	9,2
65	25	95	65	196	285	130	11,3
80	16	110	80	256	310	145	23,0
100	16	130	100	286	310	160	36,0
125	6	160	120	326	350	180	47,0

