

Nátrubek s vnějším závitem  
přivařovací (Nipl)  
AISI 316

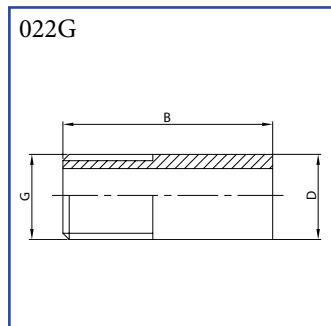

| DN  | B    | D     | G      |
|-----|------|-------|--------|
| 6   | 30,0 | 10,2  | 1/8"   |
| 8   | 30,0 | 13,5  | 1/4"   |
| 10  | 30,0 | 17,2  | 3/8"   |
| 15  | 35,0 | 21,3  | 1/2"   |
| 20  | 40,0 | 26,9  | 3/4"   |
| 25  | 40,0 | 33,7  | 1"     |
| 32  | 50,0 | 42,4  | 1 1/4" |
| 40  | 50,0 | 48,3  | 1 1/2" |
| 50  | 50,0 | 60,3  | 2"     |
| 65  | 60,0 | 76,1  | 2 1/2" |
| 80  | 70,0 | 88,9  | 3"     |
| 100 | 80,0 | 114,3 | 4"     |

Nátrubek s vnitřním závitem  
(Mufna)  
AISI 316

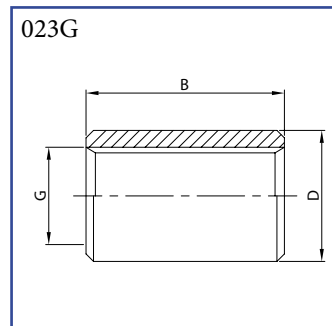

| DN  | B    | D     | G      |
|-----|------|-------|--------|
| 6   | 18,0 | 16,0  | 1/8"   |
| 8   | 26,0 | 19,5  | 1/4"   |
| 10  | 26,5 | 22,0  | 3/8"   |
| 15  | 34,0 | 27,7  | 1/2"   |
| 20  | 36,0 | 33,6  | 3/4"   |
| 25  | 43,0 | 37,5  | 1"     |
| 32  | 48,0 | 46,5  | 1 1/4" |
| 40  | 48,0 | 53,0  | 1 1/2" |
| 50  | 56,0 | 65,5  | 2"     |
| 65  | 63,0 | 82,0  | 2 1/2" |
| 80  | 71,0 | 95,5  | 3"     |
| 100 | 83,0 | 121,5 | 4"     |

Nátrubek s vnitřním závitem  
krátký  
AISI 316 (AISI 304)

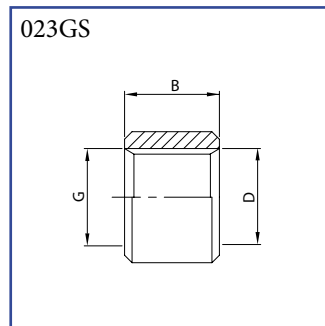

| DN  | B  | D     | G      |
|-----|----|-------|--------|
| 6   | 10 | 14,0  | 1/8"   |
| 8   | 11 | 18,5  | 1/4"   |
| 10  | 12 | 21,3  | 3/8"   |
| 15  | 15 | 26,4  | 1/2"   |
| 20  | 17 | 31,8  | 3/4"   |
| 25  | 20 | 39,5  | 1"     |
| 32  | 22 | 48,3  | 1 1/4" |
| 40  | 22 | 54,5  | 1 1/2" |
| 50  | 26 | 66,3  | 2"     |
| 65  | 31 | 82,0  | 2 1/2" |
| 80  | 34 | 95,0  | 3"     |
| 100 | 39 | 122,0 | 4"     |

Trubkový dvounipl  
AISI 316

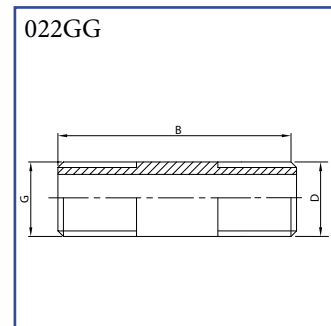

| DN  | B | D     | G      |
|-----|---|-------|--------|
| 6   |   | 10,2  | 1/8"   |
| 8   |   | 13,5  | 1/4"   |
| 10  |   | 17,2  | 3/8"   |
| 15  |   | 21,3  | 1/2"   |
| 20  |   | 26,9  | 3/4"   |
| 25  |   | 33,7  | 1"     |
| 32  |   | 42,4  | 1 1/4" |
| 40  |   | 48,3  | 1 1/2" |
| 50  |   | 60,3  | 2"     |
| 65  |   | 76,1  | 2 1/2" |
| 80  |   | 88,9  | 3"     |
| 100 |   | 114,3 | 4"     |

Různé délky na poptávku

Dvounipl se šestihrannem  
AISI 316

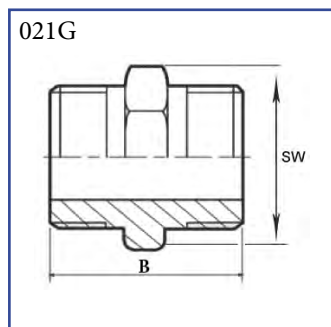

| DN  | B    | SW    | G      |
|-----|------|-------|--------|
| 6   | 31,0 | 13,0  | 1/8"   |
| 8   | 34,0 | 14,5  | 1/4"   |
| 10  | 36,0 | 19,0  | 3/8"   |
| 15  | 43,0 | 24,0  | 1/2"   |
| 20  | 42,5 | 28,5  | 3/4"   |
| 25  | 50,0 | 35,5  | 1"     |
| 32  | 57,0 | 45,5  | 1 1/4" |
| 40  | 58,5 | 50,5  | 1 1/2" |
| 50  | 64,0 | 62,0  | 2"     |
| 65  | 72,5 | 80,0  | 2 1/2" |
| 80  | 82,5 | 92,0  | 3"     |
| 100 | 90,0 | 120,0 | 4"     |

Šestihranná zátka  
s vnitřním závitem  
AISI 316

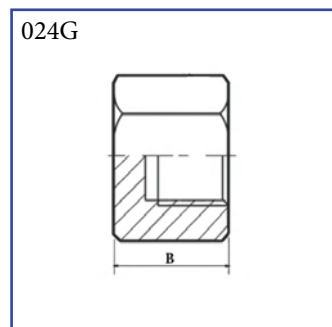

| DN  | B    | G      |
|-----|------|--------|
| 6   | 15,0 | 1/8"   |
| 8   | 17,5 | 1/4"   |
| 10  | 20,0 | 3/8"   |
| 15  | 23,5 | 1/2"   |
| 20  | 26,0 | 3/4"   |
| 25  | 30,0 | 1"     |
| 32  | 32,5 | 1 1/4" |
| 40  | 33,5 | 1 1/2" |
| 50  | 37,5 | 2"     |
| 65  | 43,5 | 2 1/2" |
| 80  | 46,5 | 3"     |
| 100 | 53,0 | 4"     |

Kulatá zátka  
s vnitřním závitem  
AISI 316

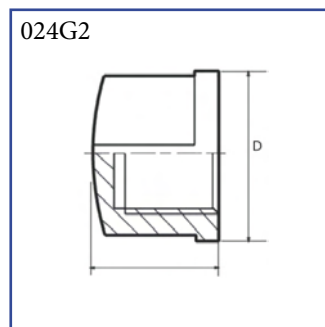

| DN  | B  | D   | G      |
|-----|----|-----|--------|
| 6   | 15 | 18  | 1/8"   |
| 8   | 17 | 21  | 1/4"   |
| 10  | 17 | 24  | 3/8"   |
| 15  | 19 | 27  | 1/2"   |
| 20  | 24 | 35  | 3/4"   |
| 25  | 29 | 42  | 1"     |
| 32  | 32 | 52  | 1 1/4" |
| 40  | 34 | 58  | 1 1/2" |
| 50  | 38 | 69  | 2"     |
| 65  | 43 | 91  | 2 1/2" |
| 80  | 48 | 106 | 3"     |
| 100 | 53 | 133 | 4"     |

Šestihranná matka  
s vnitřním závitem  
AISI 316 (AISI 304)

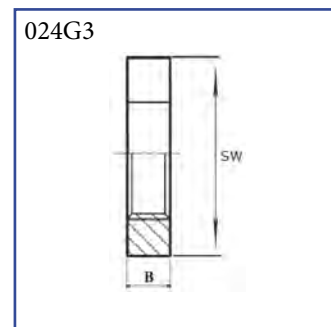

| DN  | B  | SW  | G      |
|-----|----|-----|--------|
| 6   | 5  | 17  | 1/8"   |
| 8   | 7  | 23  | 1/4"   |
| 10  | 8  | 26  | 3/8"   |
| 15  | 10 | 31  | 1/2"   |
| 20  | 11 | 37  | 3/4"   |
| 25  | 10 | 46  | 1"     |
| 32  | 11 | 55  | 1 1/4" |
| 40  | 12 | 63  | 1 1/2" |
| 50  | 13 | 76  | 2"     |
| 65  | 16 | 95  | 2 1/2" |
| 80  | 19 | 105 | 3"     |
| 100 | 20 | 131 | 4"     |

Šestihranná zátka  
s vnějším závitem  
AISI 316

025G

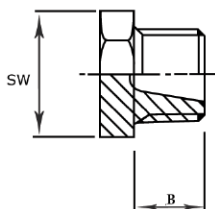

| DN  | B  | SW  | G      |
|-----|----|-----|--------|
| 6   | 8  | 14  | 1/8"   |
| 8   | 13 | 16  | 1/4"   |
| 10  | 14 | 19  | 3/8"   |
| 15  | 18 | 25  | 1/2"   |
| 20  | 20 | 30  | 3/4"   |
| 25  | 21 | 38  | 1"     |
| 32  | 24 | 45  | 1 1/4" |
| 40  | 25 | 52  | 1 1/2" |
| 50  | 26 | 63  | 2"     |
| 65  | 31 | 80  | 2 1/2" |
| 80  | 35 | 89  | 3"     |
| 100 | 40 | 119 | 4"     |

Čtyřhranná zátka  
s vnějším závitem  
AISI 316 (AISI 304)

025G2

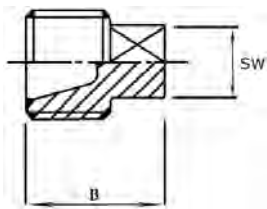

| DN  | B  | SW | G      |
|-----|----|----|--------|
| 6   | 19 | 6  | 1/8"   |
| 8   | 20 | 9  | 1/4"   |
| 10  | 22 | 11 | 3/8"   |
| 15  | 25 | 13 | 1/2"   |
| 20  | 27 | 16 | 3/4"   |
| 25  | 32 | 20 | 1"     |
| 32  | 35 | 24 | 1 1/4" |
| 40  | 37 | 25 | 1 1/2" |
| 50  | 38 | 32 | 2"     |
| 65  | 48 | 42 | 2 1/2" |
| 80  | 52 | 46 | 3"     |
| 100 | 62 | 58 | 4"     |

Koleno 90°  
s vnějšími závity  
AISI 316

031G-MM

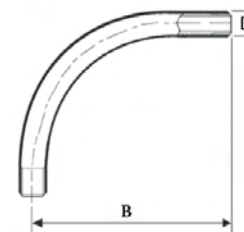

| DN | B   | D    | G      |
|----|-----|------|--------|
| 6  | 50  | 10,2 | 1/8"   |
| 8  | 60  | 13,5 | 1/4"   |
| 10 | 70  | 17,2 | 3/8"   |
| 15 | 80  | 21,3 | 1/2"   |
| 20 | 100 | 26,9 | 3/4"   |
| 25 | 120 | 33,7 | 1"     |
| 32 | 140 | 42,4 | 1 1/4" |
| 40 | 160 | 48,3 | 1 1/2" |
| 50 | 190 | 60,3 | 2"     |
| 65 | 240 | 76,1 | 2 1/2" |
| 80 | 290 | 88,9 | 3"     |

Koleno 45°  
s vnitřními závity  
AISI 316

031G45

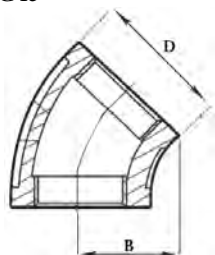

| DN  | B  | D   | G      |
|-----|----|-----|--------|
| 6   | 18 | 18  | 1/8"   |
| 8   | 19 | 21  | 1/4"   |
| 10  | 21 | 26  | 3/8"   |
| 15  | 22 | 31  | 1/2"   |
| 20  | 25 | 37  | 3/4"   |
| 25  | 31 | 45  | 1"     |
| 32  | 33 | 55  | 1 1/4" |
| 40  | 37 | 62  | 1 1/2" |
| 50  | 43 | 75  | 2"     |
| 65  | 49 | 87  | 2 1/2" |
| 80  | 54 | 99  | 3"     |
| 100 | 65 | 125 | 4"     |

Koleno 90°  
s vnitřními závity  
AISI 316 (AISI 304)

031G-F/F

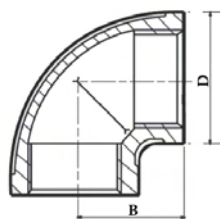

| DN  | B  | D   | G      |
|-----|----|-----|--------|
| 6   | 18 | 18  | 1/8"   |
| 8   | 20 | 21  | 1/4"   |
| 10  | 21 | 24  | 3/8"   |
| 15  | 28 | 29  | 1/2"   |
| 20  | 34 | 37  | 3/4"   |
| 25  | 38 | 44  | 1"     |
| 32  | 43 | 51  | 1 1/4" |
| 40  | 48 | 57  | 1 1/2" |
| 50  | 57 | 70  | 2"     |
| 65  | 69 | 87  | 2 1/2" |
| 80  | 78 | 99  | 3"     |
| 100 | 97 | 125 | 4"     |

Koleno 90°  
vnitřní / vnější závit  
AISI 316 (AISI 304)

031G-M/F

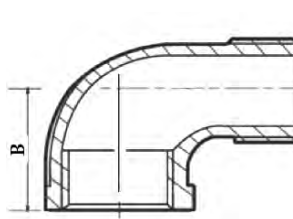

| DN  | B  | G      |
|-----|----|--------|
| 6   | 19 | 1/8"   |
| 8   | 19 | 1/4"   |
| 10  | 23 | 3/8"   |
| 15  | 29 | 1/2"   |
| 20  | 33 | 3/4"   |
| 25  | 37 | 1"     |
| 32  | 45 | 1 1/4" |
| 40  | 50 | 1 1/2" |
| 50  | 57 | 2"     |
| 65  | 68 | 2 1/2" |
| 80  | 78 | 3"     |
| 100 | 97 | 4"     |

Koleno 90° redukované  
s vnitřními závity  
AISI 316

031GR-F/F

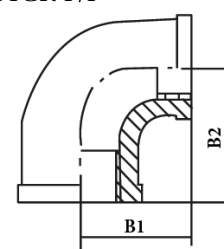

| DN1 x DN2 | B1 | B2 | G1 x G2       |
|-----------|----|----|---------------|
| 8 6       | 20 | 20 | 1/4" 1/8"     |
| 10 8      | 23 | 23 | 3/8" 1/4"     |
| 15 10     | 26 | 26 | 1/2" 3/8"     |
| 20 10     | 28 | 28 | 3/4" 3/8"     |
| 20 15     | 31 | 30 | 3/4" 1/2"     |
| 25 15     | 34 | 32 | 1" 1/2"       |
| 25 20     | 36 | 35 | 1" 3/4"       |
| 32 20     | 41 | 36 | 1 1/4" 3/4"   |
| 32 25     | 42 | 40 | 1 1/2" 1"     |
| 40 25     | 46 | 42 | 1 1/2" 1"     |
| 40 32     | 48 | 46 | 1 1/2" 1 1/4" |
| 50 40     | 55 | 52 | 2" 1 1/2"     |

T-kus F/F/F  
s vnitřními závit  
AISI 316 (AISI 304)

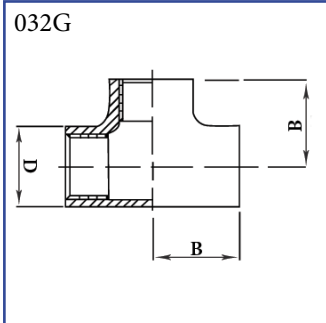

| DN  | B  | D   | G      |
|-----|----|-----|--------|
| 6   | 17 | 18  | 1/8"   |
| 8   | 21 | 21  | 1/4"   |
| 10  | 24 | 24  | 3/8"   |
| 15  | 29 | 31  | 1/2"   |
| 20  | 33 | 37  | 3/4"   |
| 25  | 38 | 44  | 1"     |
| 32  | 42 | 50  | 1 1/4" |
| 40  | 50 | 57  | 1 1/2" |
| 50  | 56 | 71  | 2"     |
| 65  | 69 | 87  | 2 1/2" |
| 80  | 78 | 99  | 3"     |
| 100 | 97 | 125 | 4"     |

T-kus redukovaný F/F/F  
s vnitřními závit  
AISI 316

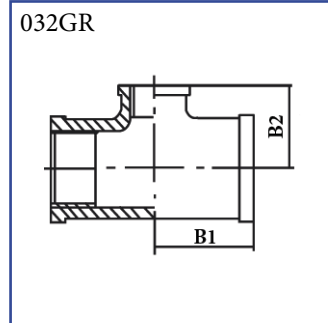

| DN1 x DN2 | B1 | B2 | G1 x G2       |
|-----------|----|----|---------------|
| 8 6       | 20 | 20 | 1/4" 1/8"     |
| 10 6      | 20 | 23 | 3/8" 1/8"     |
| 10 8      | 23 | 23 | 3/8" 1/4"     |
| 15 6      | 20 | 26 | 1/2" 1/8"     |
| 15 8      | 23 | 26 | 1/2" 1/4"     |
| 15 10     | 26 | 26 | 1/2" 3/8"     |
| 20 10     | 28 | 28 | 3/4" 3/8"     |
| 20 15     | 31 | 30 | 3/4" 1/2"     |
| 25 15     | 33 | 32 | 1" 1/2"       |
| 25 20     | 35 | 35 | 1" 3/4"       |
| 32 15     | 40 | 33 | 1 1/4" 1/2"   |
| 32 20     | 40 | 38 | 1 1/4" 3/4"   |
| 32 25     | 42 | 40 | 1 1/4" 1"     |
| 40 15     | 42 | 34 | 1 1/2" 1/2"   |
| 40 20     | 44 | 38 | 1 1/2" 3/4"   |
| 40 25     | 46 | 40 | 1 1/2" 1"     |
| 40 32     | 48 | 44 | 1 1/2" 1 1/4" |
| 50 20     | 50 | 40 | 2" 3/4"       |
| 50 25     | 52 | 44 | 2" 1"         |
| 50 32     | 54 | 48 | 2" 1 1/4"     |
| 50 40     | 55 | 52 | 2" 1 1/2"     |

Kříž F/F/F/F  
s vnitřními závit  
AISI 316

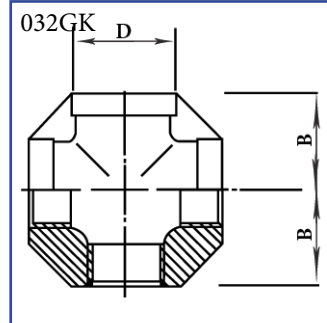

| DN  | B  | D   | G      |
|-----|----|-----|--------|
| 6   | 17 | 15  | 1/8"   |
| 8   | 19 | 20  | 1/4"   |
| 10  | 23 | 23  | 3/8"   |
| 15  | 27 | 28  | 1/2"   |
| 20  | 32 | 35  | 3/4"   |
| 25  | 38 | 44  | 1"     |
| 32  | 46 | 53  | 1 1/4" |
| 40  | 48 | 58  | 1 1/2" |
| 50  | 56 | 71  | 2"     |
| 65  | 69 | 87  | 2 1/2" |
| 80  | 78 | 99  | 3"     |
| 100 | 97 | 125 | 4"     |

Redukovaný dvojnopl  
se šestihrannem  
AISI 316 (AISI 304)

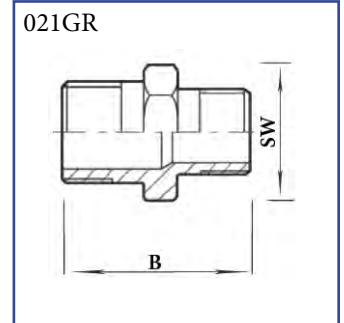

| DN1 x DN2 | B  | SW  | G1 x G2       |
|-----------|----|-----|---------------|
| 8 6       | 34 | 18  | 1/4" 1/8"     |
| 10 6      | 36 | 21  | 3/8" 1/8"     |
| 10 8      | 34 | 21  | 3/8" 1/4"     |
| 15 6      | 34 | 26  | 1/2" 1/8"     |
| 15 8      | 34 | 26  | 1/2" 1/4"     |
| 15 10     | 41 | 26  | 1/2" 3/8"     |
| 20 8      | 37 | 30  | 3/4" 1/4"     |
| 20 10     | 37 | 30  | 3/4" 3/8"     |
| 20 15     | 45 | 30  | 3/4" 1/2"     |
| 25 8      | 39 | 35  | 1" 1/4"       |
| 25 10     | 40 | 35  | 1" 3/8"       |
| 25 15     | 43 | 35  | 1" 1/2"       |
| 25 20     | 50 | 35  | 1" 3/4"       |
| 32 15     | 48 | 46  | 1 1/4" 1/2"   |
| 32 20     | 52 | 46  | 1 1/4" 3/4"   |
| 32 25     | 54 | 46  | 1 1/4" 1"     |
| 40 15     | 49 | 50  | 1 1/2" 1/2"   |
| 40 20     | 53 | 50  | 1 1/2" 3/4"   |
| 40 25     | 53 | 50  | 1 1/2" 1"     |
| 40 32     | 59 | 50  | 1 1/2" 1 1/4" |
| 50 15     | 52 | 63  | 2" 1/2"       |
| 50 20     | 56 | 63  | 2" 3/4"       |
| 50 25     | 57 | 63  | 2" 1"         |
| 50 32     | 58 | 63  | 2" 1 1/4"     |
| 50 40     | 64 | 63  | 2" 1 1/2"     |
| 65 25     | 63 | 80  | 2 1/2" 1"     |
| 65 40     | 66 | 80  | 2 1/2" 1 1/2" |
| 65 50     | 77 | 80  | 2 1/2" 2"     |
| 80 50     | 74 | 95  | 3" 2"         |
| 80 65     | 84 | 95  | 3" 2 1/2"     |
| 100 50    | 82 | 125 | 4" 2"         |
| 100 65    | 82 | 125 | 4" 2 1/2"     |
| 100 80    | 94 | 125 | 4" 3"         |

Redukce závitová  
vnější / vnitřní závit  
AISI 316 (AISI 304)

027G-M/F

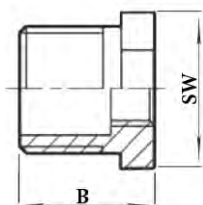

| DN1 x DN2 | B  | SW  | G1 x G2       |
|-----------|----|-----|---------------|
| 8 6       | 15 | 16  | 1/4" 1/8"     |
| 10 6      | 17 | 18  | 3/8" 1/8"     |
| 10 8      | 17 | 18  | 3/8" 1/4"     |
| 15 6      | 21 | 26  | 1/2" 1/8"     |
| 15 8      | 21 | 26  | 1/2" 1/4"     |
| 15 10     | 21 | 26  | 1/2" 3/8"     |
| 20 8      | 24 | 30  | 3/4" 1/4"     |
| 20 10     | 24 | 30  | 3/4" 3/8"     |
| 20 15     | 24 | 30  | 3/4" 1/2"     |
| 25 8      | 27 | 35  | 1" 1/4"       |
| 25 10     | 27 | 35  | 1" 3/8"       |
| 25 15     | 27 | 35  | 1" 1/2"       |
| 25 20     | 27 | 35  | 1" 3/4"       |
| 32 15     | 30 | 45  | 1 1/4" 1/2"   |
| 32 20     | 30 | 45  | 1 1/4" 3/4"   |
| 32 25     | 30 | 45  | 1 1/4" 1"     |
| 40 15     | 36 | 52  | 1 1/2" 1/2"   |
| 40 20     | 36 | 52  | 1 1/2" 3/4"   |
| 40 25     | 36 | 52  | 1 1/2" 1"     |
| 40 32     | 36 | 52  | 1 1/2" 1 1/4" |
| 50 15     | 36 | 63  | 2" 1/2"       |
| 50 20     | 36 | 63  | 2" 3/4"       |
| 50 25     | 36 | 63  | 2" 1"         |
| 50 32     | 36 | 63  | 2" 1 1/4"     |
| 50 40     | 36 | 63  | 2" 1 1/2"     |
| 65 25     | 45 | 81  | 2 1/2" 1"     |
| 65 40     | 45 | 81  | 2 1/2" 1 1/2" |
| 65 50     | 45 | 81  | 2 1/2" 2"     |
| 80 50     | 47 | 95  | 3" 2"         |
| 80 65     | 47 | 95  | 3" 2 1/2"     |
| 100 50    | 52 | 119 | 4" 2"         |
| 100 65    | 52 | 119 | 4" 2 1/2"     |
| 100 80    | 52 | 119 | 4" 3"         |

Redukce závitová  
vnitřní/vnitřní závit  
AISI 316

027G-F/F

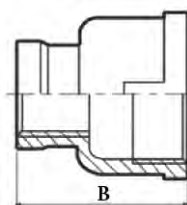

| DN1 x DN2 | B  | G1 x G2       |
|-----------|----|---------------|
| 8 6       | 26 | 1/4" 1/8"     |
| 10 6      | 30 | 3/8" 1/8"     |
| 10 8      | 29 | 3/8" 1/4"     |
| 15 6      | 34 | 1/2" 1/8"     |
| 15 8      | 33 | 1/2" 1/4"     |
| 15 10     | 34 | 1/2" 3/8"     |
| 20 8      | 35 | 3/4" 1/4"     |
| 20 10     | 37 | 3/4" 3/8"     |
| 20 15     | 37 | 3/4" 1/2"     |
| 25 8      | 42 | 1" 1/4"       |
| 25 10     | 43 | 1" 3/8"       |
| 25 15     | 43 | 1" 1/2"       |
| 25 20     | 42 | 1" 3/4"       |
| 32 15     | 49 | 1 1/4" 1/2"   |
| 32 20     | 48 | 1 1/4" 3/4"   |
| 32 25     | 52 | 1 1/4" 1"     |
| 40 15     | 51 | 1 1/2" 1/2"   |
| 40 20     | 49 | 1 1/2" 3/4"   |
| 40 25     | 53 | 1 1/2" 1"     |
| 40 32     | 53 | 1 1/2" 1 1/4" |
| 50 15     | 51 | 2" 1/2"       |
| 50 20     | 51 | 2" 3/4"       |
| 50 25     | 56 | 2" 1"         |
| 50 32     | 56 | 2" 1 1/4"     |
| 50 40     | 57 | 2" 1 1/2"     |
| 65 25     | 60 | 2 1/2" 1"     |
| 65 40     | 60 | 2 1/2" 1 1/2" |
| 65 50     | 61 | 2 1/2" 2"     |
| 80 50     | 62 | 3" 2"         |
| 80 65     | 62 | 3" 2 1/2"     |
| 100 50    | 65 | 4" 2"         |
| 100 65    | 65 | 4" 2 1/2"     |
| 100 80    | 65 | 4" 3"         |

Hadícový nástavec  
se závitem a šestihrannem  
AISI 316 (AISI 304)

026G

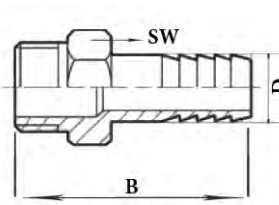

| DN x D    | B   | SW  | G      |
|-----------|-----|-----|--------|
| 6 3,2     | 45  | 13  | 1/8"   |
| 6 6,5     | 45  | 13  | 1/8"   |
| 8 6,3     | 47  | 17  | 1/4"   |
| 8 8,0     | 47  | 17  | 1/4"   |
| 8 9,0     | 47  | 17  | 1/4"   |
| 8 10,0    | 47  | 17  | 1/4"   |
| 8 11,0    | 47  | 17  | 1/4"   |
| 8 12,7    | 47  | 17  | 1/4"   |
| 10 8,0    | 55  | 20  | 3/8"   |
| 10 9,5    | 55  | 20  | 3/8"   |
| 10 10,0   | 55  | 20  | 3/8"   |
| 10 11,0   | 55  | 20  | 3/8"   |
| 10 12,7   | 55  | 20  | 3/8"   |
| 15 9,0    | 64  | 24  | 1/2"   |
| 15 10,0   | 64  | 24  | 1/2"   |
| 15 11,0   | 64  | 24  | 1/2"   |
| 15 12,7   | 64  | 24  | 1/2"   |
| 15 14,0   | 64  | 24  | 1/2"   |
| 20 19,0   | 68  | 31  | 3/4"   |
| 20 20,5   | 68  | 31  | 3/4"   |
| 25 25,4   | 71  | 39  | 1"     |
| 25 27,0   | 71  | 39  | 1"     |
| 32 31,8   | 80  | 46  | 1 1/4" |
| 32 33,0   | 80  | 46  | 1 1/4" |
| 40 38,1   | 95  | 52  | 1 1/2" |
| 40 39,5   | 95  | 52  | 1 1/2" |
| 50 50,8   | 105 | 62  | 2"     |
| 50 52,0   | 105 | 62  | 2"     |
| 65 63,5   | 107 | 80  | 2 1/2" |
| 65 67,0   | 107 | 80  | 2 1/2" |
| 80 76,1   | 112 | 91  | 3"     |
| 80 80,0   | 112 | 91  | 3"     |
| 100 101,6 | 130 | 117 | 4"     |
| 100 105,0 | 130 | 117 | 4"     |

Hadícový nástavec  
s vnějším závitem  
AISI 316 (AISI 304)

026GM

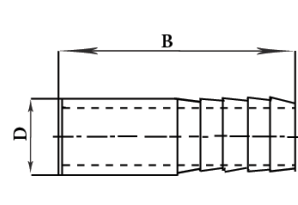

| DN  | B   | D     | G      |
|-----|-----|-------|--------|
| 6   | 70  | 10,2  | 1/8"   |
| 8   | 70  | 13,5  | 1/4"   |
| 10  | 70  | 17,2  | 3/8"   |
| 15  | 75  | 21,3  | 1/2"   |
| 20  | 75  | 26,9  | 3/4"   |
| 25  | 80  | 33,7  | 1"     |
| 32  | 90  | 42,4  | 1 1/4" |
| 40  | 90  | 48,3  | 1 1/2" |
| 50  | 95  | 60,3  | 2"     |
| 65  | 105 | 76,1  | 2 1/2" |
| 80  | 110 | 88,9  | 3"     |
| 100 | 115 | 114,3 | 4"     |

Šroubení - vnitřní závit  
těsněno na plocho  
AISI 316/PTFE (AISI 304)

020GT-F/F

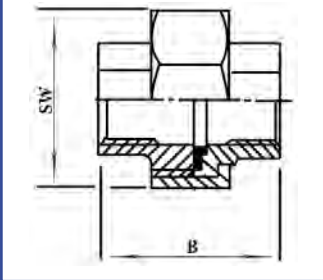

| DN  | B    | SW    | G      |
|-----|------|-------|--------|
| 6   | 32   | 29    | 1/8"   |
| 8   | 32   | 29    | 1/4"   |
| 10  | 34   | 34    | 3/8"   |
| 15  | 39,5 | 39,5  | 1/2"   |
| 20  | 42,5 | 42    | 3/4"   |
| 25  | 48,5 | 58    | 1"     |
| 32  | 56,5 | 62    | 1 1/4" |
| 40  | 59,0 | 71    | 1 1/2" |
| 50  | 64,0 | 89,5  | 2"     |
| 65  | 70,5 | 106,0 | 2 1/2" |
| 80  | 81,5 | 123,5 | 3"     |
| 100 | 96,5 | 154,5 | 4"     |

Šroubení - vnitřní/vnější závit  
těsněno na plocho  
AISI 316/PTFE (AISI 304)

020GT-F/M

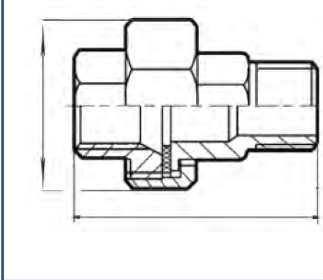

| DN  | B   | SW  | G      |
|-----|-----|-----|--------|
| 6   | 41  | 25  | 1/8"   |
| 8   | 50  | 30  | 1/4"   |
| 10  | 50  | 35  | 3/8"   |
| 15  | 58  | 42  | 1/2"   |
| 20  | 66  | 47  | 3/4"   |
| 25  | 69  | 53  | 1"     |
| 32  | 83  | 71  | 1 1/4" |
| 40  | 87  | 78  | 1 1/2" |
| 50  | 95  | 92  | 2"     |
| 65  | 113 | 112 | 2 1/2" |
| 80  | 128 | 126 | 3"     |
| 100 | 155 | 157 | 4"     |

Šroubení - přivařovací konce  
těsněno na plocho  
AISI 316/PTFE (AISI 304)

020GT-BW/BW

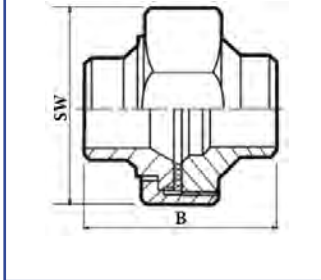

| DN  | B   | SW  | G      |
|-----|-----|-----|--------|
| 6   | 29  | 25  | 1/8"   |
| 8   | 36  | 30  | 1/4"   |
| 10  | 38  | 35  | 3/8"   |
| 15  | 41  | 42  | 1/2"   |
| 20  | 50  | 47  | 3/4"   |
| 25  | 48  | 53  | 1"     |
| 32  | 59  | 71  | 1 1/4" |
| 40  | 64  | 78  | 1 1/2" |
| 50  | 68  | 92  | 2"     |
| 65  | 80  | 112 | 2 1/2" |
| 80  | 88  | 126 | 3"     |
| 100 | 108 | 157 | 4"     |

Šroubení - vnitřní závit  
těsněno kónicky  
AISI 316 (AISI 304)

020GK-F/F

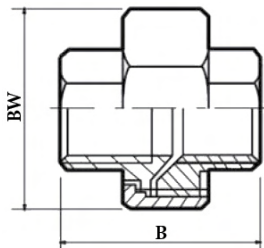

| DN  | B   | SW  | G      |
|-----|-----|-----|--------|
| 6   | 29  | 25  | 1/8"   |
| 8   | 38  | 30  | 1/4"   |
| 10  | 38  | 35  | 3/8"   |
| 15  | 42  | 42  | 1/2"   |
| 20  | 50  | 47  | 3/4"   |
| 25  | 48  | 53  | 1"     |
| 32  | 59  | 71  | 1 1/4" |
| 40  | 64  | 78  | 1 1/2" |
| 50  | 69  | 92  | 2"     |
| 65  | 80  | 112 | 2 1/2" |
| 80  | 88  | 126 | 3"     |
| 100 | 108 | 157 | 4"     |

Šroubení - vnitřní/vnější závit  
těsněno kónicky  
AISI 316 (AISI 304)

020GK-F/M

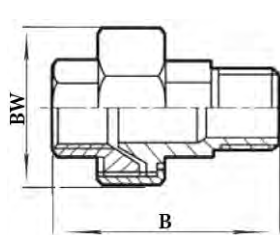

| DN  | B   | SW  | G      |
|-----|-----|-----|--------|
| 6   | 40  | 25  | 1/8"   |
| 8   | 50  | 30  | 1/4"   |
| 10  | 50  | 35  | 3/8"   |
| 15  | 56  | 42  | 1/2"   |
| 20  | 66  | 47  | 3/4"   |
| 25  | 68  | 53  | 1"     |
| 32  | 83  | 71  | 1 1/4" |
| 40  | 86  | 78  | 1 1/2" |
| 50  | 94  | 92  | 2"     |
| 65  | 113 | 112 | 2 1/2" |
| 80  | 126 | 126 | 3"     |
| 100 | 154 | 157 | 4"     |

Šroubení - vnější závit  
těsněno kónicky  
AISI 316 (AISI 304)

020GK-M/M

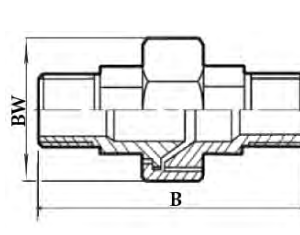

| DN  | B   | SW  | G      |
|-----|-----|-----|--------|
| 6   | 52  | 25  | 1/8"   |
| 8   | 61  | 30  | 1/4"   |
| 10  | 63  | 35  | 3/8"   |
| 15  | 73  | 42  | 1/2"   |
| 20  | 82  | 47  | 3/4"   |
| 25  | 90  | 53  | 1"     |
| 32  | 104 | 71  | 1 1/4" |
| 40  | 110 | 78  | 1 1/2" |
| 50  | 118 | 92  | 2"     |
| 65  | 145 | 112 | 2 1/2" |
| 80  | 164 | 126 | 3"     |
| 100 | 205 | 157 | 4"     |

Šroubení - přivařovací konce  
těsněno kónicky  
AISI 316 (AISI 304)

020GK-BW/BW

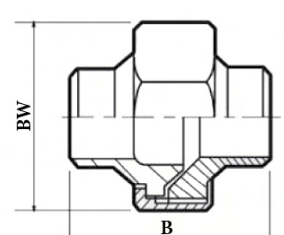

| DN  | B   | SW  | G      |
|-----|-----|-----|--------|
| 6   | 29  | 25  | 1/8"   |
| 8   | 36  | 30  | 1/4"   |
| 10  | 38  | 35  | 3/8"   |
| 15  | 42  | 42  | 1/2"   |
| 20  | 50  | 47  | 3/4"   |
| 25  | 48  | 53  | 1"     |
| 32  | 59  | 71  | 1 1/4" |
| 40  | 64  | 78  | 1 1/2" |
| 50  | 68  | 92  | 2"     |
| 65  | 80  | 112 | 2 1/2" |
| 80  | 88  | 126 | 3"     |
| 100 | 108 | 157 | 4"     |

Šroubení - přív. / vnitřní závit  
těsněno kónicky  
AISI 316 (AISI 304)

020GK-BW/F

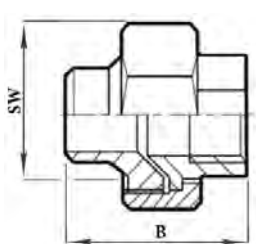

| DN  | B   | SW  | G      |
|-----|-----|-----|--------|
| 6   | 29  | 25  | 1/8"   |
| 8   | 36  | 30  | 1/4"   |
| 10  | 37  | 35  | 3/8"   |
| 15  | 41  | 42  | 1/2"   |
| 20  | 50  | 47  | 3/4"   |
| 25  | 48  | 53  | 1"     |
| 32  | 59  | 71  | 1 1/4" |
| 40  | 64  | 78  | 1 1/2" |
| 50  | 68  | 92  | 2"     |
| 65  | 80  | 112 | 2 1/2" |
| 80  | 88  | 126 | 3"     |
| 100 | 108 | 157 | 4"     |

Šroubení - přivař. / vnější závit  
těsněno kónicky  
AISI 316 (AISI 304)

020GK-BW/M

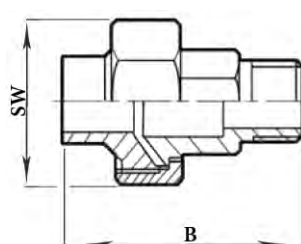

| DN  | B   | SW  | G      |
|-----|-----|-----|--------|
| 6   | 41  | 25  | 1/8"   |
| 8   | 48  | 30  | 1/4"   |
| 10  | 50  | 35  | 3/8"   |
| 15  | 56  | 42  | 1/2"   |
| 20  | 64  | 47  | 3/4"   |
| 25  | 68  | 53  | 1"     |
| 32  | 83  | 71  | 1 1/4" |
| 40  | 86  | 78  | 1 1/2" |
| 50  | 95  | 92  | 2"     |
| 65  | 113 | 112 | 2 1/2" |
| 80  | 126 | 126 | 3"     |
| 100 | 154 | 157 | 4"     |

Šroubení  
s hadicovými nástavci  
AISI 316

020P-H/H

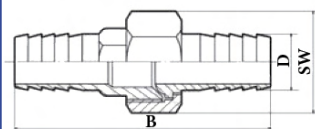

| DN x D  | B   | SW | G      |
|---------|-----|----|--------|
| 6 6,5   | 61  | 25 | 1/8"   |
| 8 6,3   | 64  | 30 | 1/4"   |
| 8 9,0   | 64  | 30 | 1/4"   |
| 10 9,5  | 83  | 35 | 3/8"   |
| 10 11,0 | 83  | 35 | 3/8"   |
| 15 12,7 | 97  | 42 | 1/2"   |
| 15 14,0 | 97  | 42 | 1/2"   |
| 20 19,0 | 100 | 47 | 3/4"   |
| 20 20,5 | 100 | 47 | 3/4"   |
| 25 25,4 | 99  | 53 | 1"     |
| 25 27,0 | 99  | 53 | 1"     |
| 32 31,8 | 118 | 71 | 1 1/4" |
| 32 33,0 | 118 | 71 | 1 1/4" |
| 40 38,1 | 144 | 77 | 1 1/2" |
| 40 39,5 | 144 | 77 | 1 1/2" |
| 50 50,8 | 156 | 92 | 2"     |
| 50 52,0 | 156 | 92 | 2"     |

Šroubení  
vnitřní závit / hadic. nástavec  
AISI 316

020P-F/H

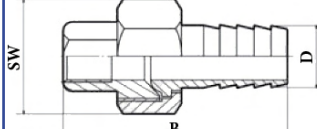

| DN x D  | B   | SW | G      |
|---------|-----|----|--------|
| 6 6,5   | 41  | 25 | 1/8"   |
| 8 6,3   | 47  | 30 | 1/4"   |
| 8 9,0   | 47  | 30 | 1/4"   |
| 10 9,5  | 55  | 35 | 3/8"   |
| 10 11,0 | 55  | 35 | 3/8"   |
| 15 12,7 | 64  | 42 | 1/2"   |
| 15 14,0 | 64  | 42 | 1/2"   |
| 20 19,0 | 70  | 47 | 3/4"   |
| 20 20,5 | 70  | 47 | 3/4"   |
| 25 25,4 | 68  | 53 | 1"     |
| 25 27,0 | 68  | 53 | 1"     |
| 32 31,8 | 82  | 71 | 1 1/4" |
| 32 33,0 | 82  | 71 | 1 1/4" |
| 40 38,1 | 96  | 77 | 1 1/2" |
| 40 39,5 | 96  | 77 | 1 1/2" |
| 50 50,8 | 105 | 92 | 2"     |
| 50 52,0 | 105 | 92 | 2"     |

Šroubení  
vnější závit / hadic. nástavec  
AISI 316

020P-M/H

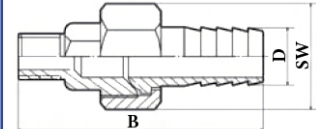

| DN x D  | B   | SW | G      |
|---------|-----|----|--------|
| 6 6,5   | 53  | 25 | 1/8"   |
| 8 6,3   | 59  | 30 | 1/4"   |
| 8 9,0   | 59  | 30 | 1/4"   |
| 10 9,5  | 68  | 35 | 3/8"   |
| 10 11,0 | 68  | 35 | 3/8"   |
| 15 12,7 | 80  | 42 | 1/2"   |
| 15 14,0 | 80  | 42 | 1/2"   |
| 20 19,0 | 86  | 47 | 3/4"   |
| 20 20,5 | 86  | 47 | 3/4"   |
| 25 25,4 | 91  | 53 | 1"     |
| 25 27,0 | 91  | 53 | 1"     |
| 32 31,8 | 104 | 71 | 1 1/4" |
| 32 33,0 | 104 | 71 | 1 1/4" |
| 40 38,1 | 119 | 77 | 1 1/2" |
| 40 39,5 | 119 | 77 | 1 1/2" |
| 50 50,8 | 130 | 92 | 2"     |
| 50 52,0 | 130 | 92 | 2"     |

Šroubení  
přivařovací / hadic. nástavec  
AISI 316

020P-BW/H

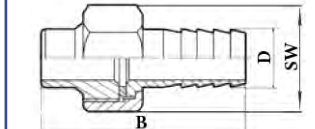

| DN x D  | B   | SW | G      |
|---------|-----|----|--------|
| 6 6,5   | 41  | 25 | 1/8"   |
| 8 6,3   | 47  | 30 | 1/4"   |
| 8 9,0   | 47  | 30 | 1/4"   |
| 10 9,5  | 55  | 35 | 3/8"   |
| 10 11,0 | 55  | 35 | 3/8"   |
| 15 12,7 | 64  | 42 | 1/2"   |
| 15 14,0 | 64  | 42 | 1/2"   |
| 20 19,0 | 70  | 47 | 3/4"   |
| 20 20,5 | 70  | 47 | 3/4"   |
| 25 25,4 | 68  | 53 | 1"     |
| 25 27,0 | 68  | 53 | 1"     |
| 32 31,8 | 82  | 71 | 1 1/4" |
| 32 33,0 | 82  | 71 | 1 1/4" |
| 40 38,1 | 96  | 77 | 1 1/2" |
| 40 39,5 | 96  | 77 | 1 1/2" |
| 50 50,8 | 105 | 92 | 2"     |
| 50 52,0 | 105 | 92 | 2"     |

Šroubení  
koleno 90° / vnitřní závit  
AISI 316

020B-F/F

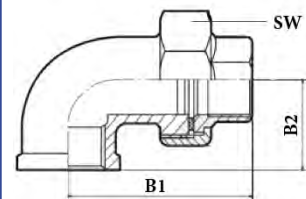

| DN | B1 | B2 | SW | G      |
|----|----|----|----|--------|
| 6  | 39 | 19 | 25 | 1/8"   |
| 8  | 46 | 21 | 30 | 1/4"   |
| 10 | 49 | 25 | 35 | 3/8"   |
| 15 | 55 | 28 | 42 | 1/2"   |
| 20 | 63 | 33 | 47 | 3/4"   |
| 25 | 68 | 38 | 53 | 1"     |
| 32 | 80 | 45 | 71 | 1 1/4" |
| 40 | 88 | 50 | 77 | 1 1/2" |
| 50 | 94 | 58 | 92 | 2"     |

Šroubení  
koleno 90° / vnější závit  
AISI 316

020B-F/M

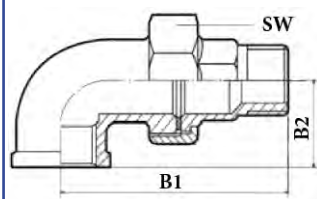

| DN | B1  | B2 | SW | G      |
|----|-----|----|----|--------|
| 6  | 51  | 19 | 25 | 1/8"   |
| 8  | 59  | 21 | 30 | 1/4"   |
| 10 | 61  | 25 | 35 | 3/8"   |
| 15 | 70  | 28 | 42 | 1/2"   |
| 20 | 79  | 33 | 47 | 3/4"   |
| 25 | 88  | 38 | 53 | 1"     |
| 32 | 103 | 45 | 71 | 1 1/4" |
| 40 | 110 | 50 | 77 | 1 1/2" |
| 50 | 119 | 58 | 92 | 2"     |