

Cod. A-10
Polyethylene two-way relief valve
(pressure and vacuum)
maximum flow 130 hl/h

Cod.	Material	G (mm)	Weight (kg)
A-10	Polyethylen	G 1 1/4"	0,064



Cod. A-30
Polyethylene two-way relief valve
(pressure and vacuum)
maximum flow 800 hl/h

Cod.	Material	G (mm)	Weight (kg)
A-30	Polyethylen	G 2"	0,32

Cod. A-20
Polyethylene two-way relief valve
(pressure and vacuum)
maximum flow 400 hl/h

Cod.	Material	G (mm)	Weight (kg)
A-20	Polyethylen	G 1 1/4"	0,15
A-21	Polyethylen	G 1 1/2"	0,15



Cod. A-40
St. st. two-way relief valve
(pressure and vacuum)
maximum flow 300 hl/h

Cod.	Material	Weight (kg)
A-40	304	1,5
A-40/Z	304	1,7
A-40/B	316	1,5
A-40/Z/B	316	1,7

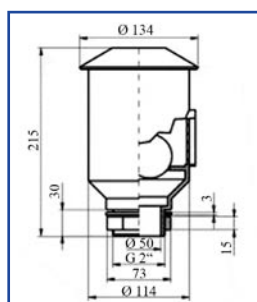

Code .../Z: with oil bath

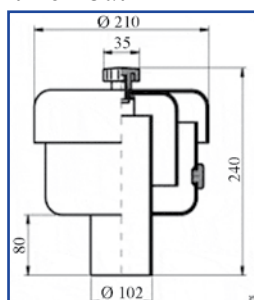
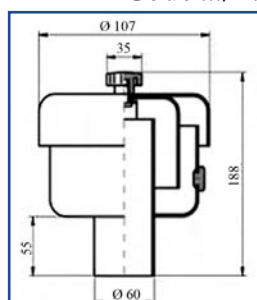

Cod. A-50
St. st. two-way relief valve
(pressure and vacuum)
maximum flow 1000 hl/h

Cod.	Material	Weight (kg)
A-50	304	2,5
A-50/Z	304	2,7
A-50/B	316	2,5
A-50/Z/B	316	2,7

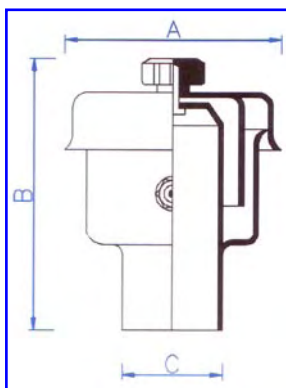

Welding:

Cod.	AISI	Ø mm	A mm	B mm	C mm	hl/h
VSD040SA	304	40	115	140	40	150
VSD060SA	304	60	170	185	60	300
VSD100SA	304	100	210	235	100	1000
VSD040SB	316	40	115	140	40	150
VSD060SB	316	60	170	185	60	300
VSD100SB	316	100	210	235	100	1000

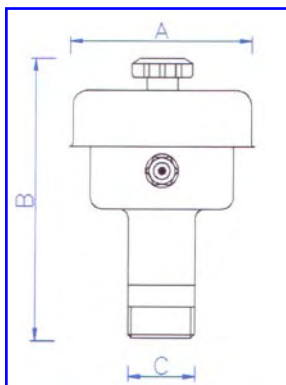

Male gas thread:

Cod.	AISI	Ø mm	A mm	B mm	C mm	hl/h
VSD040GA	304	40	115	200	1 1/4"	150
VSD060GA	304	60	170	210	2"	300
VSD100GA	304	100	210	260	3"	1000
VSD040GB	316	40	115	200	1 1/4"	150
VSD060GB	316	60	170	210	2"	300
VSD100GB	316	100	210	260	3"	1000

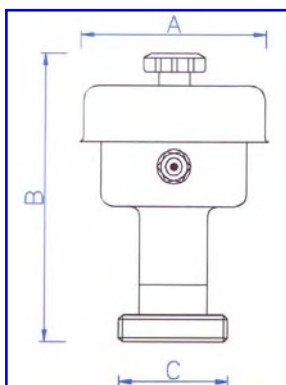

Female DIN:

Cod.	AISI	Ø mm	A mm	B mm	C mm	hl/h
VSD040FA	304	40	115	153	65-6	150
VSD060FA	304	60	170	210	95-6	300
VSD100FA	304	100	210	228	130-4	1000
VSD040FB	316	40	115	153	65-6	150
VSD060FB	316	60	170	210	95-6	300
VSD100FB	316	100	210	228	130-4	1000

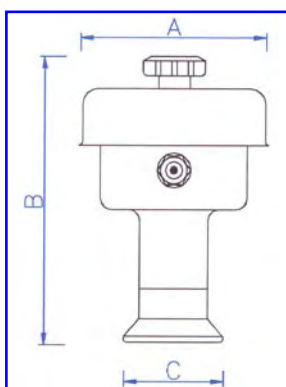

Garolla connection:

Cod.	AISI	Ø mm	A mm	B mm	C mm	hl/h
VSD040EA	304	40	115	167	65	150
VSD060EA	304	60	170	216	87	300
VSD100EA	304	100	210	275	128	1000
VSD040EB	316	40	115	167	65	150
VSD060EB	316	60	170	216	87	300
VSD100EB	316	100	210	275	128	1000

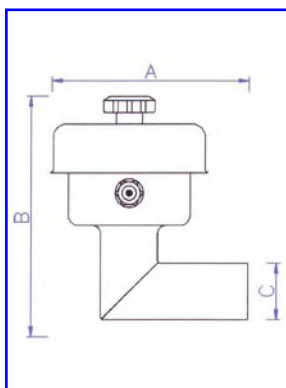

Welding:

Cod.	AISI	Ø mm	A mm	B mm	C mm	hl/h
VSC040SA	304	40	145	170	40	150
VSC060SA	304	60	225	235	60	300
VSC100SA	304	100	270	310	100	1000
VSC040SB	316	40	145	170	40	150
VSC060SB	316	60	225	235	60	300
VSC100SB	316	100	270	310	100	1000

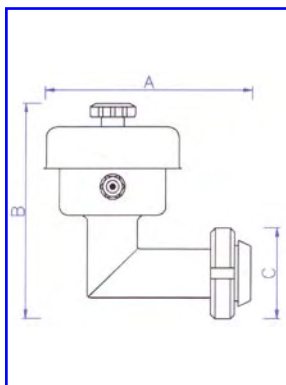

Male DIN ring:

Cod.	AISI	Ø mm	A mm	B mm	C mm	hl/h
VSC040MA	304	40	151	189	78	150
VSC060MA	304	60	231	261	112	300
VSC100MA	304	100	280	333	148	1000
VSC040MB	316	40	151	189	78	150
VSC060MB	316	60	231	261	112	300
VSC100MB	316	100	280	333	148	1000

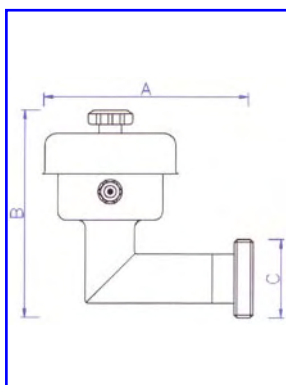

Female DIN ring:

Cod.	AISI	Ø mm	A mm	B mm	C mm	hl/h
VSC040FA	304	40	158	182	65-6	150
VSC060FA	304	60	263	253	95-6	300
VSC100FA	304	100	288	324	130-4	1000
VSC040FB	316	40	158	182	65-6	150
VSC060FB	316	60	263	253	95-6	300
VSC100FB	316	100	288	324	130-4	1000

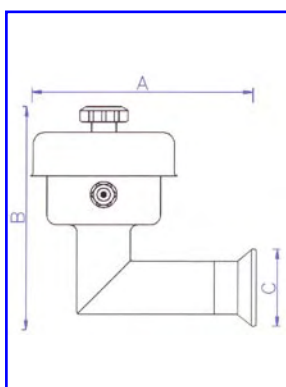

Garolla connection:

Cod.	AISI	Ø mm	A mm	B mm	C mm	hl/h
VSC040EA	304	40	172	182	65	150
VSC060EA	304	60	256	249	87	300
VSC100EA	304	100	310	323	128	1000
VSC040EB	316	40	172	142	65	150
VSC060EB	316	60	256	289	87	300
VSC100EB	316	100	310	323	128	1000